

4262C5

048-251-000-0001
15.2409 AC

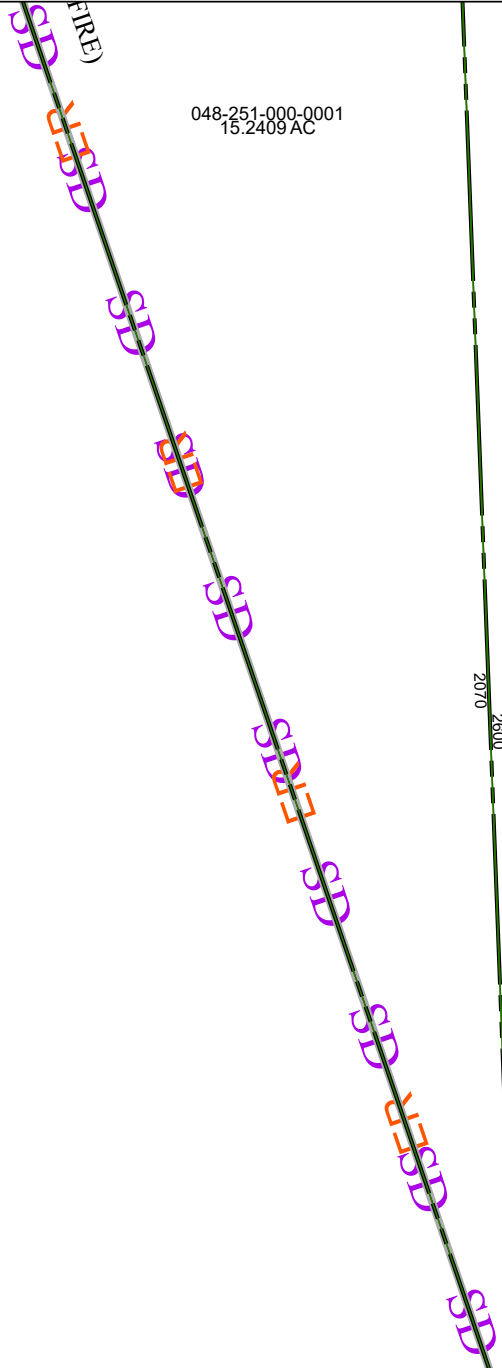

4261A1

4162D12

Harris Central Appraisal District



0 45 90 180
Feet

PUBLICATION DATE:
1/5/2023

Geospatial or map data maintained by the Harris Central Appraisal District is for informational purposes and may **not** have been prepared for or be suitable for legal, engineering, or surveying purposes. It does **not** represent an on-the-ground survey and only represents the approximate location of property boundaries.



MAP LOCATION

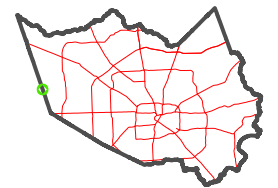

FACET 4262C9

7	8	5	6	7
11	12	9	10	11
		1	2	3

4262C10