

4264A3

4264A6

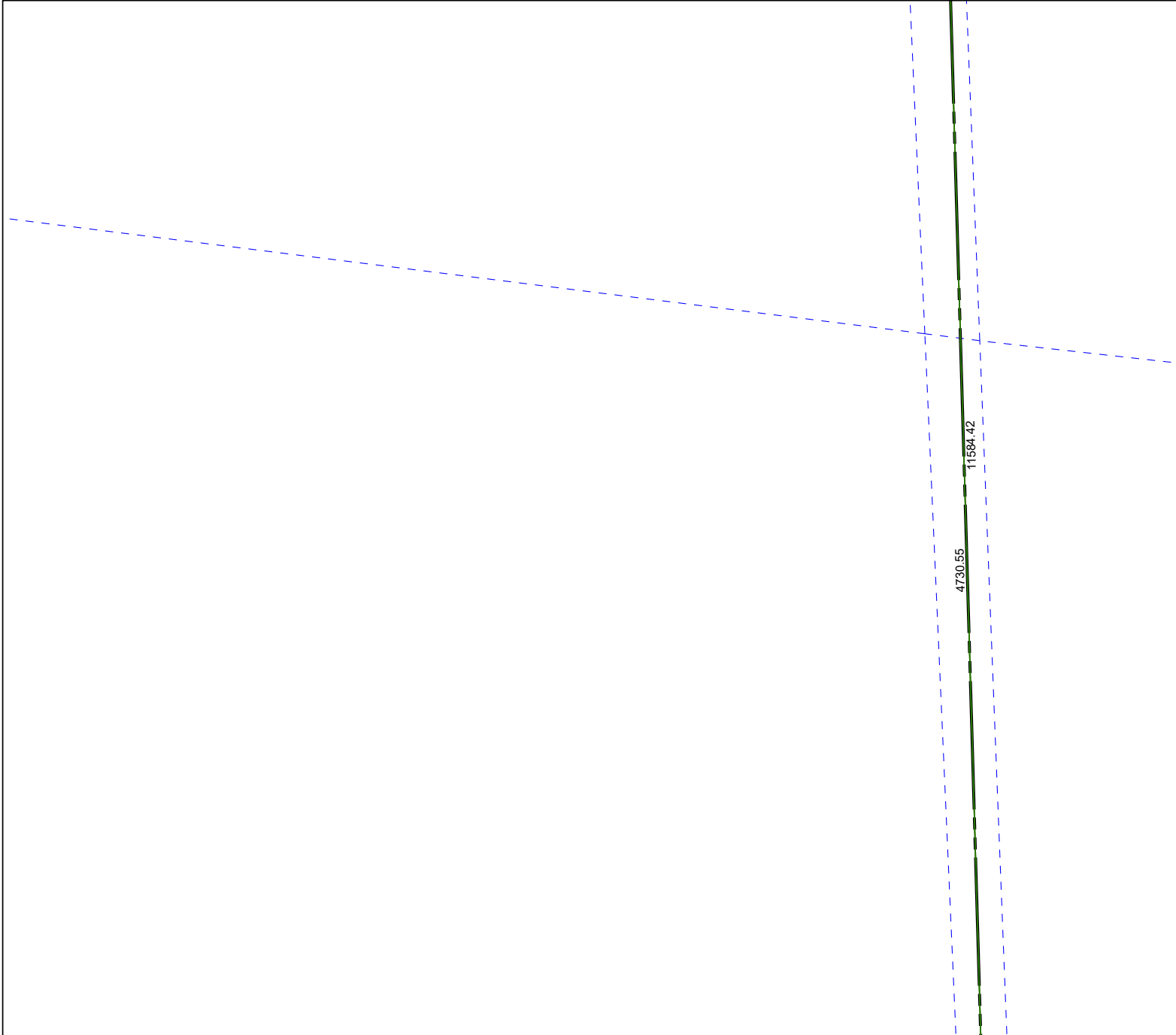

# Harris Central Appraisal District



0 50 100 200 Feet

PUBLICATION DATE:  
12/3/2025

Geospatial or map data maintained by the Harris Central Appraisal District is for informational purposes and may **not** have been prepared for or be suitable for legal, engineering, or surveying purposes. It does **not** represent an on-the-ground survey and only represents the approximate location of property boundaries.



4264A8

## MAP LOCATION

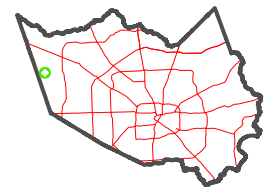

# FACET

## 4264A7

1	2	3	4	1
5	6	7	8	5
9	10	11	12	9

4264A11