

4265D12

4264B3

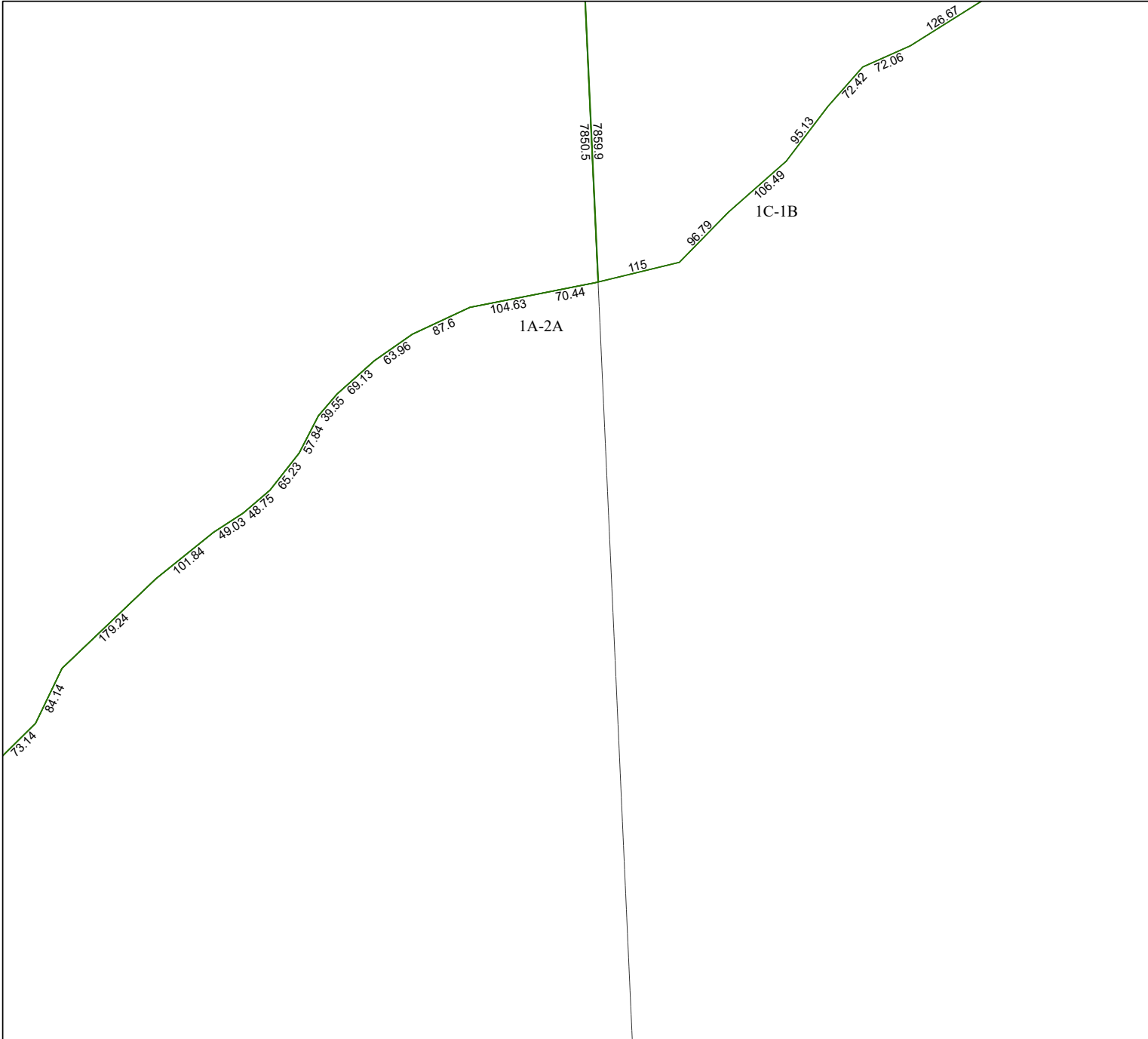

4264B8

# Harris Central Appraisal District



0 45 90 180  
Feet

PUBLICATION DATE:  
5/21/2024

Geospatial or map data maintained by the Harris Central Appraisal District is for informational purposes and may **not** have been prepared for or be suitable for legal, engineering, or surveying purposes. It does **not** represent an on-the-ground survey and only represents the approximate location of property boundaries.



### MAP LOCATION

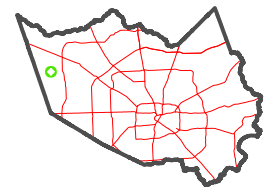

## FACET 4264B4

10	11	12	9	10
2	3	4	1	2
6	7	8	5	6

2486.61

4364A1