

4266D7

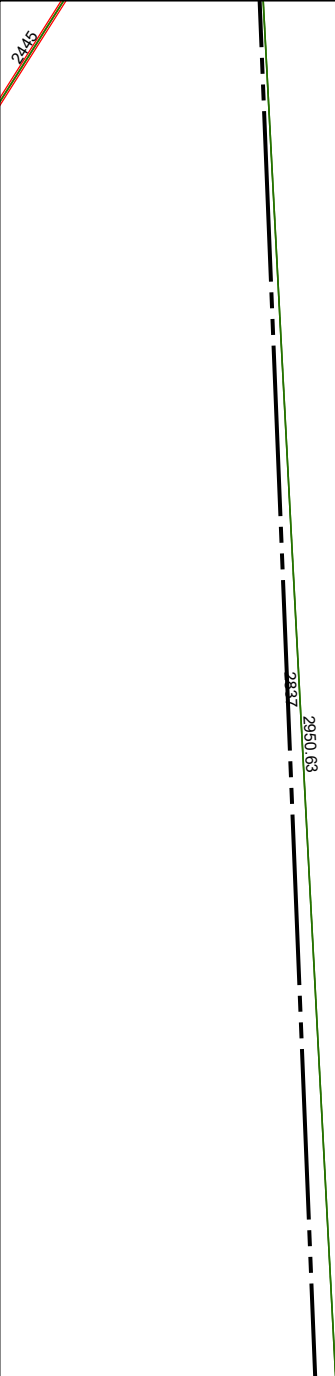

4266D10

043-165-000-0047
266.4480 AC

Harris Central Appraisal District



0 45 90 180 Feet

PUBLICATION DATE:
5/21/2024

Geospatial or map data maintained by the Harris Central Appraisal District is for informational purposes and may **not** have been prepared for or be suitable for legal, engineering, or surveying purposes. It does **not** represent an on-the-ground survey and only represents the approximate location of property boundaries.



MAP LOCATION

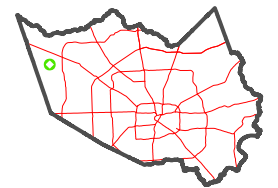

FACET

4266D11

5	6	7	8	5
9	10	11	12	9
1	2	3	4	1

4265B3