

Harris Central Appraisal District



0 45 90 180 Feet

PUBLICATION DATE: 5/6/2024

Geospatial or map data maintained by the Harris Central Appraisal District is for informational purposes and may not have been prepared for or be suitable for legal, engineering, or surveying purposes. It does not represent an on-the-ground survey and only represents the approximate location of property boundaries.

MAP LOCATION

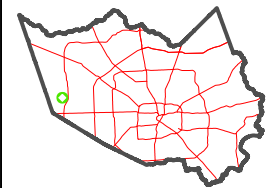

FACET 4360B8

2	3	4	1	2
6	7	8	5	6
10	11	12	9	10

4360B4

HC MUD 540

HC MUD 449

4360B12

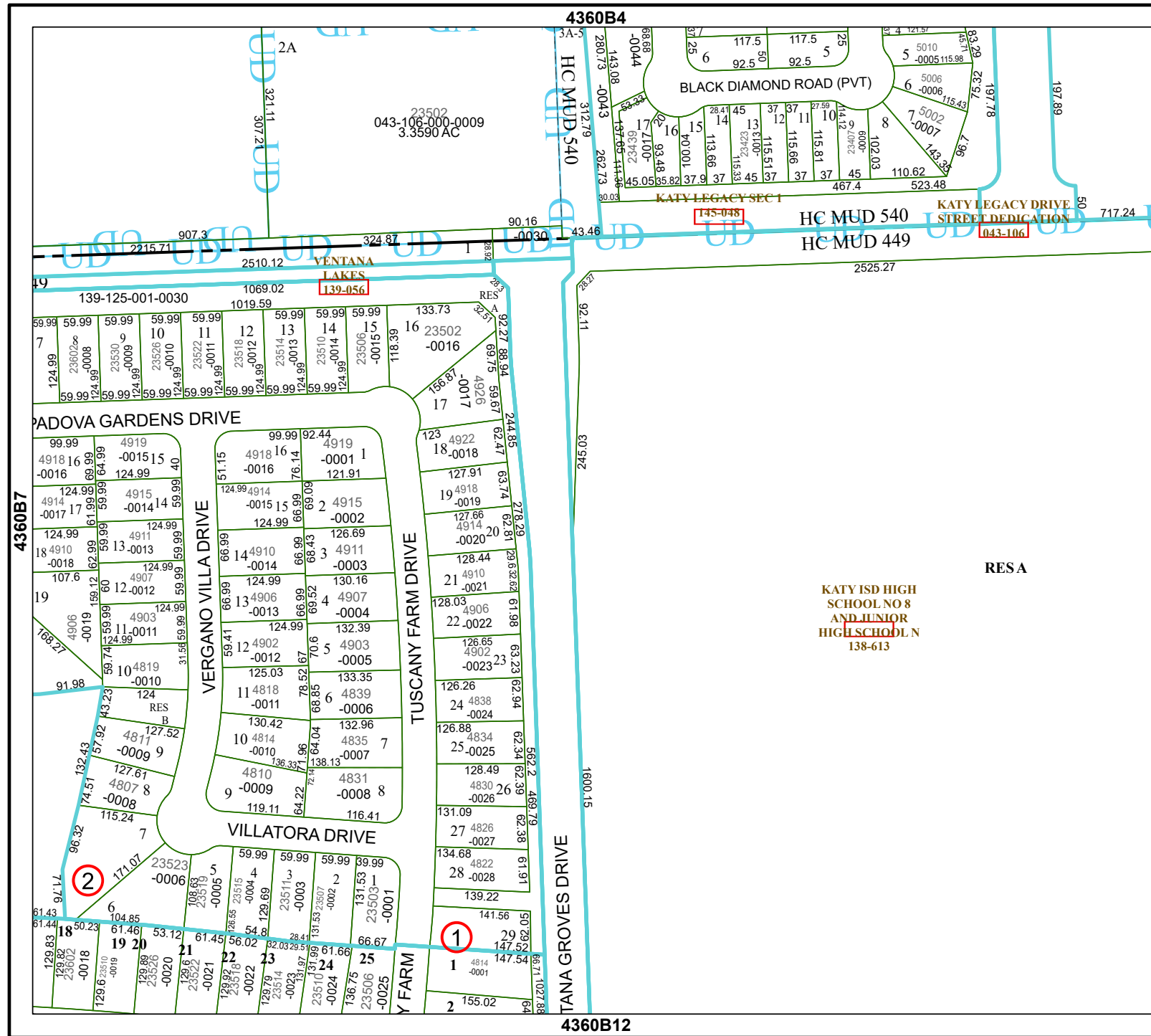

RESA

KATY ISD HIGH SCHOOL NO 8 AND JUNIOR HIGHSCHODLN 138-613

4460A5

4360B7