

4366B11

# Harris Central Appraisal District



0 45 90 180 Feet

PUBLICATION DATE:  
1/23/2024

Geospatial or map data maintained by the Harris Central Appraisal District is for informational purposes and may not have been prepared for or be suitable for legal, engineering, or surveying purposes. It does not represent an on-the-ground survey and only represents the approximate location of property boundaries.



### MAP LOCATION

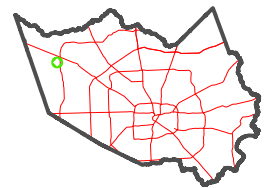

## FACET 4366D3

9	10	11	12	9
1	2	3	4	1
5	6	7	8	5

4366D2

4366D4

4366D7

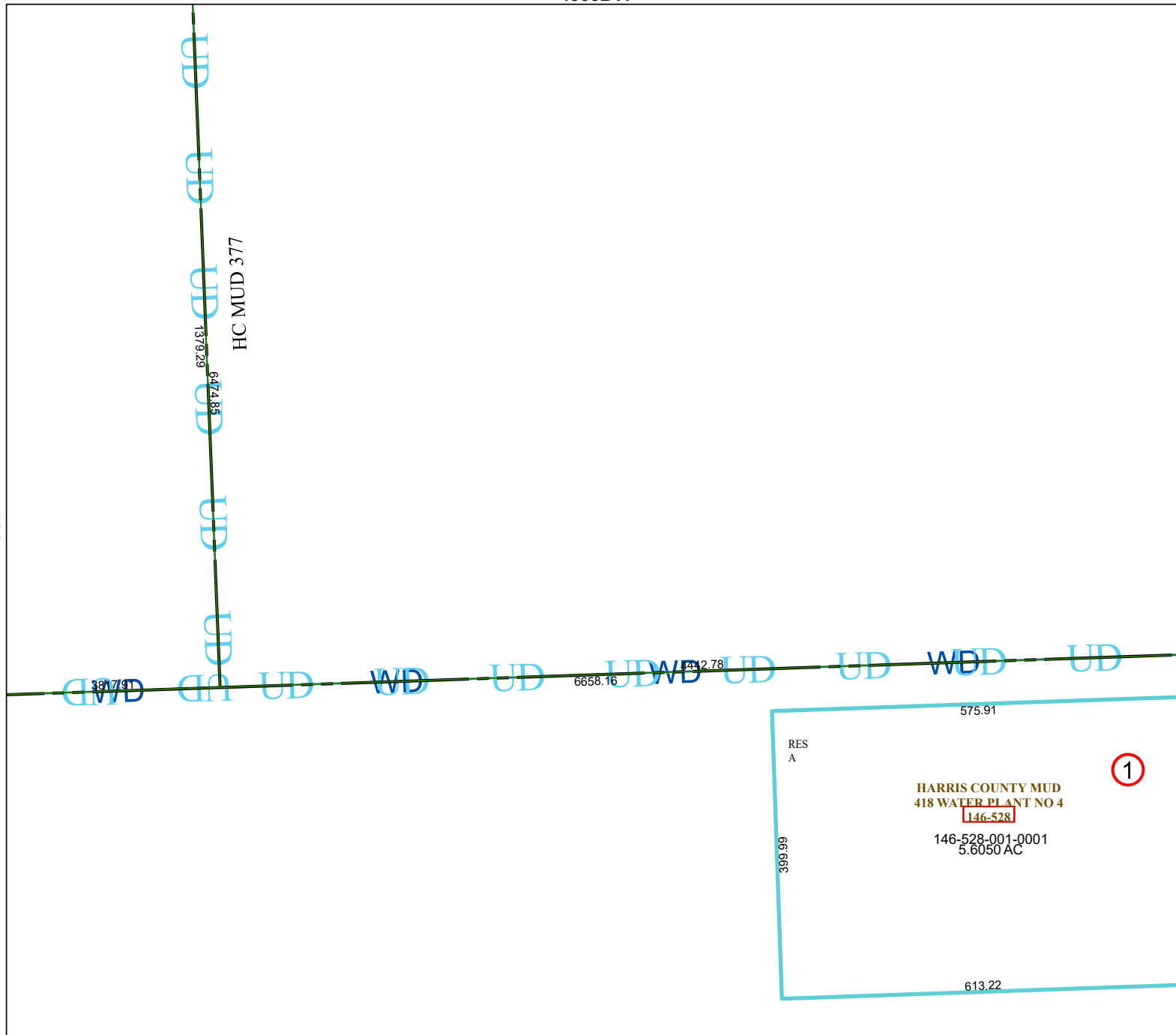

HC MUD 377

HARRIS COUNTY MUD  
418 WATER PLANT NO 4  
146-528  
146-528-001-0001  
5.6050 AC

1

3817.91

1379.29  
6474.85

6658.16

412.78

575.91

399.99

613.22

RES  
A