

4371D1

4371C8

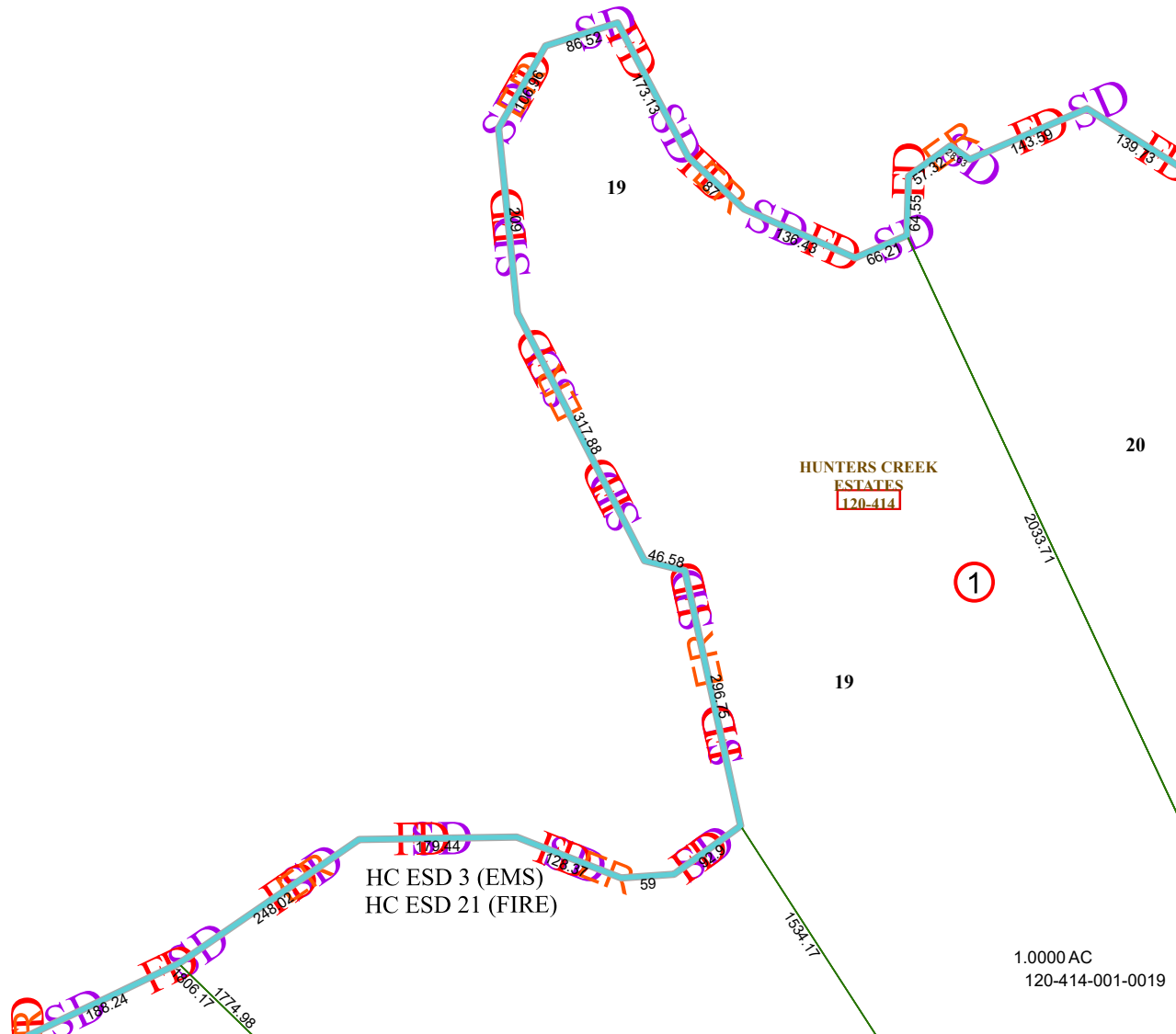

Harris Central Appraisal District



0 45 90 180 Feet

PUBLICATION DATE:
1/5/2023

Geospatial or map data maintained by the Harris Central Appraisal District is for informational purposes and may **not** have been prepared for or be suitable for legal, engineering, or surveying purposes. It does **not** represent an on-the-ground survey and only represents the approximate location of property boundaries.



MAP LOCATION

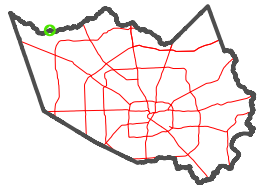

FACET 4371D5

3	4	1	2	3
7	8	5	6	7
11	12	9	10	11

1.0000 AC
120-414-001-0019

4371D9