

Harris Central Appraisal District



0 45 90 180 Feet

PUBLICATION DATE:
12/30/2023

Geospatial or map data maintained by the Harris Central Appraisal District is for informational purposes and may not have been prepared for or be suitable for legal, engineering, or surveying purposes. It does not represent an on-the-ground survey and only represents the approximate location of property boundaries.



MAP LOCATION

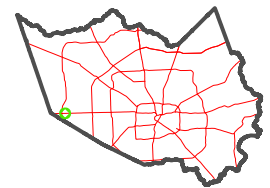

FACET 4458C8

2	3	4	5	6
6	7	8	9	10
10	11	12	9	10

4458C4

1C-2

1B

WESTSIDE MALL PAR
R/PAND EXTENSION
126-774

WESTSIDE
PARKWAY
121-498

1281.72

1281.72

1280.67

300.19

1670.15

3063.93

047-182-000-0023
6.4500 AC

H.C.M.U.D. 62

HC MUD 61

140

UD

UD

UD

UD

UD

UD

UD

UD

UD

UD

UD

UD

UD

UD

UD

UD

UD

2061

4458C7

4458D5

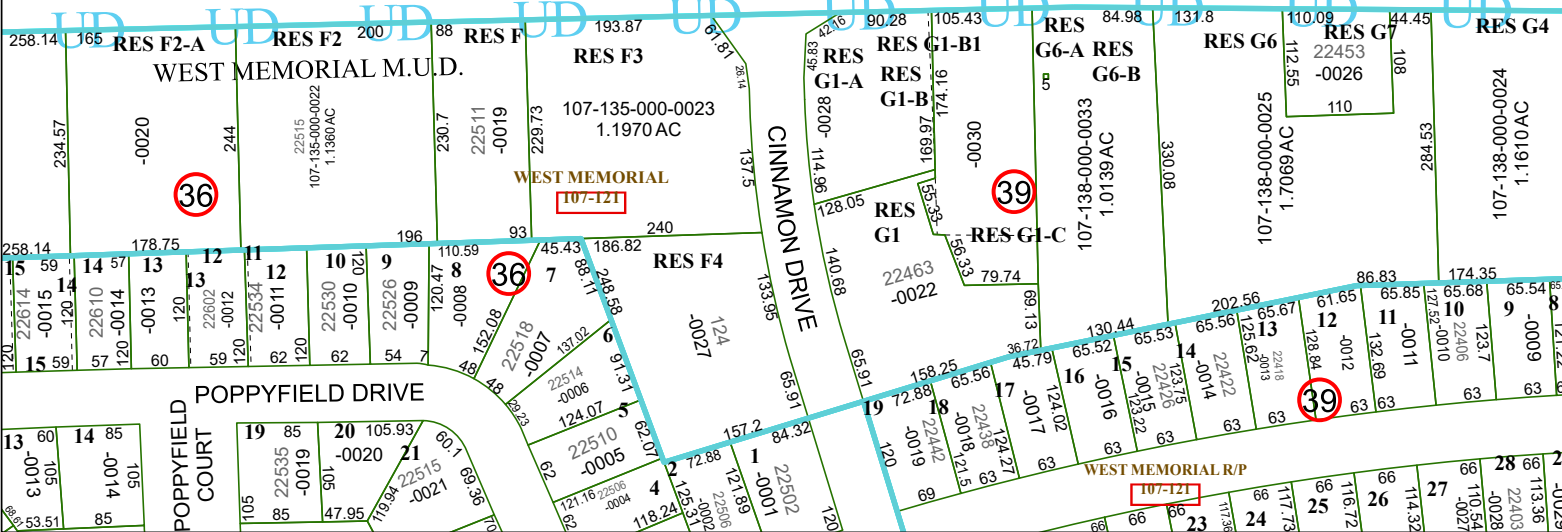

4458C12