

Harris Central Appraisal District



0 45 90 180 Feet

PUBLICATION DATE:
1/29/2024

Geospatial or map data maintained by the Harris Central Appraisal District is for informational purposes and may not have been prepared for or be suitable for legal, engineering, or surveying purposes. It does not represent an on-the-ground survey and only represents the approximate location of property boundaries.

MAP LOCATION

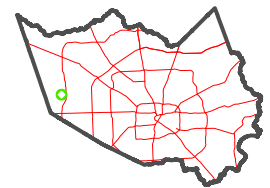

FACET 4461C5

3	4	1	2	3
7	8	5	6	7
11	12	9	10	11

4461C1

4461C9

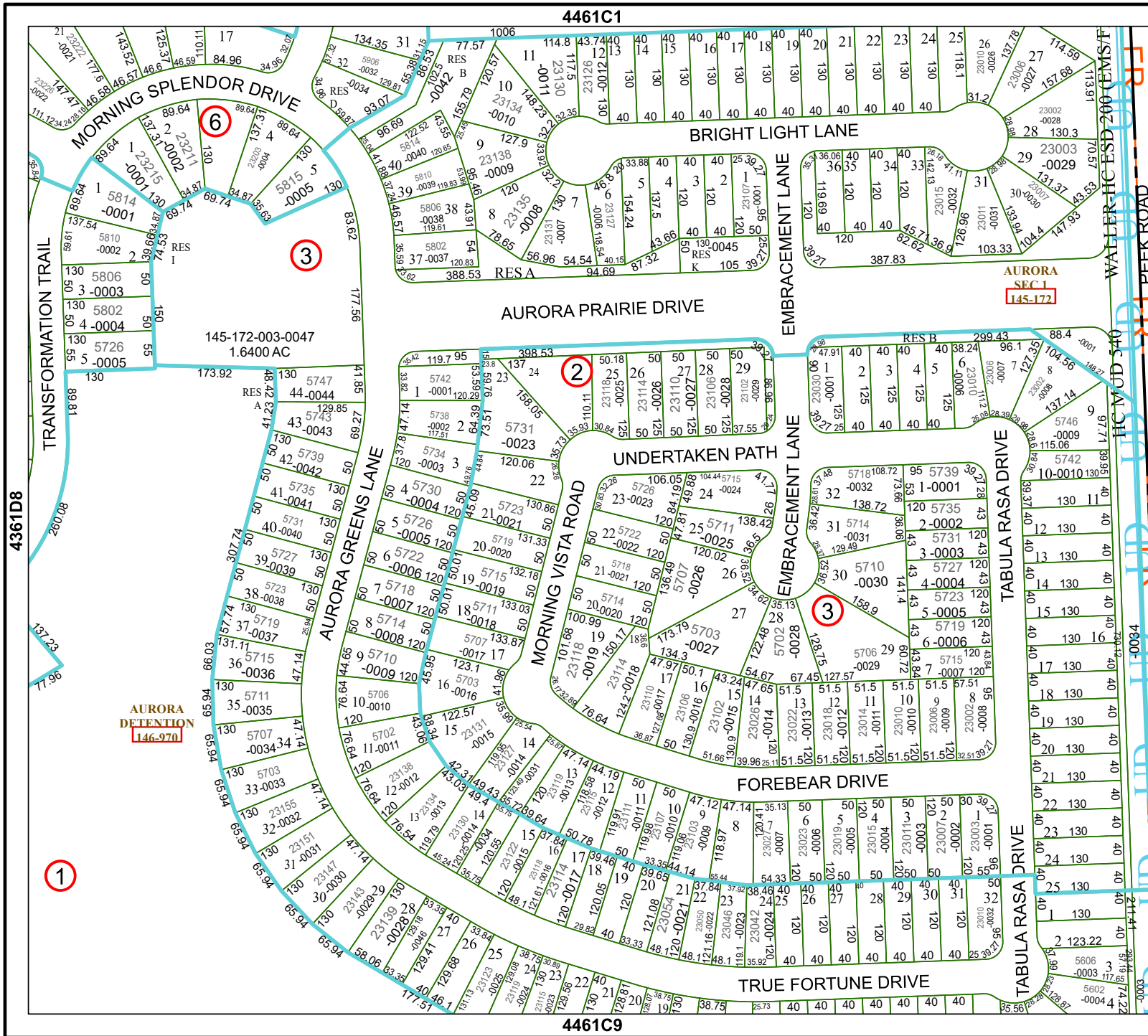

AURORA DETENTION
146-970

AURORA SEC 1
145-172