

4462D2

4462D10

Harris Central Appraisal District



0 45 90 180 Feet

PUBLICATION DATE: 5/6/2024

Geospatial or map data maintained by the Harris Central Appraisal District is for informational purposes and may not have been prepared for or be suitable for legal, engineering, or surveying purposes. It does not represent an on-the-ground survey and only represents the approximate location of property boundaries.



MAP LOCATION

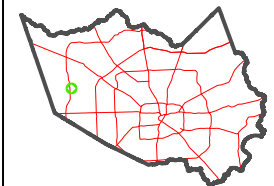

FACET 4462D6

4	1	2	3	4
8	5	6	7	8
12	9	10	11	12

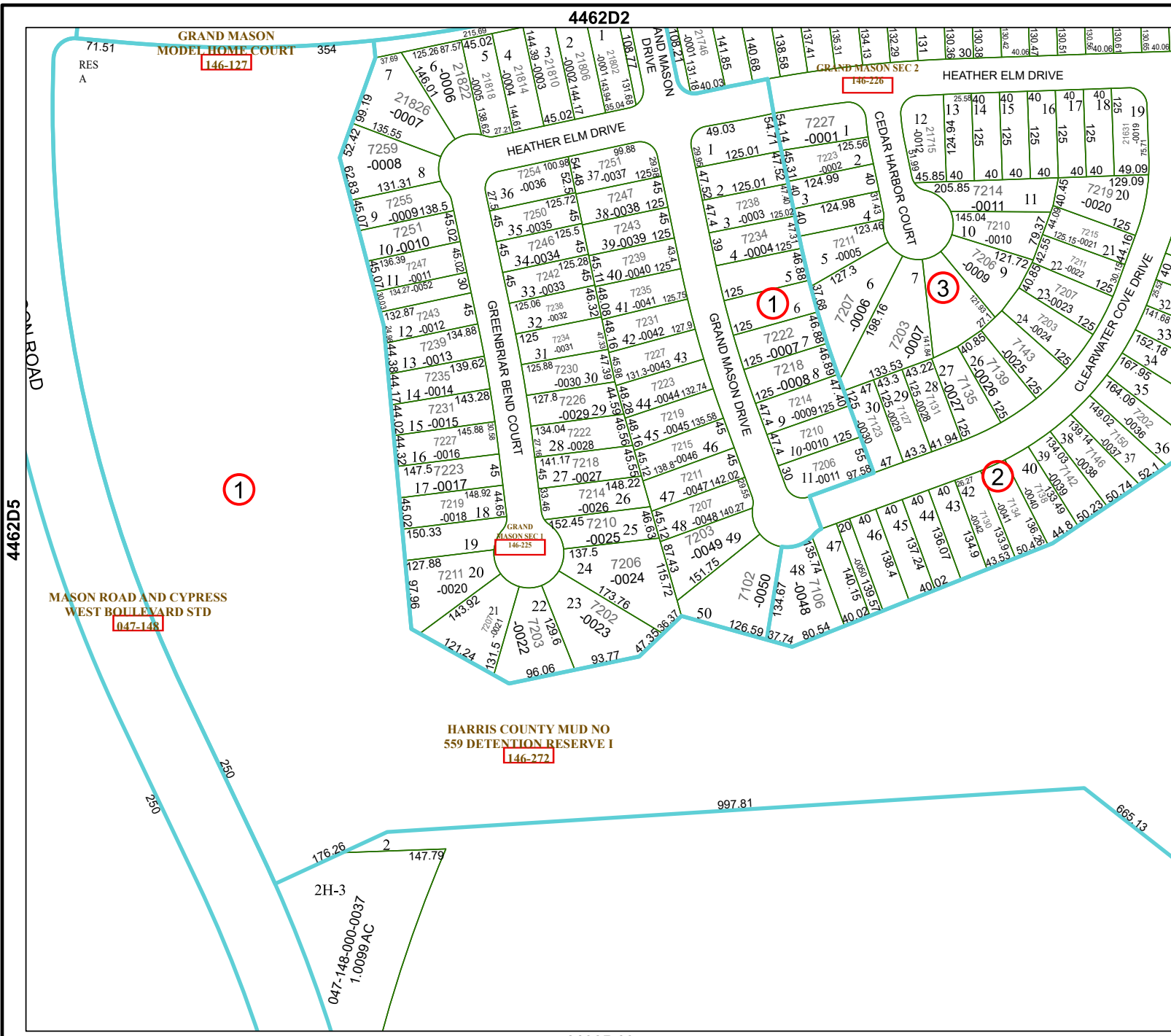

GRAND MASON MODEL HOME COURT 146-127

GRAND MASON SEC 2 146-226

GRAND MASON SEC 1 146-225

HARRIS COUNTY MUD NO 559 DETENTION RESERVE I 146-272

MASON ROAD AND CYPRESS WEST BOULEVARD STD 047-148

2H-3 047-148-000-0037 1.0089 AC