

# Harris Central Appraisal District



0 45 90 180 Feet

PUBLICATION DATE:  
1/5/2023

Geospatial or map data maintained by the Harris Central Appraisal District is for informational purposes and may not have been prepared for or be suitable for legal, engineering, or surveying purposes. It does not represent an on-the-ground survey and only represents the approximate location of property boundaries.

MAP LOCATION

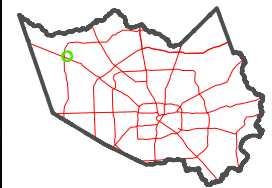

## FACET 4467C4

10	11	12	9	10
2	3	4	1	2
6	7	8	5	6

4467A12

4467C8

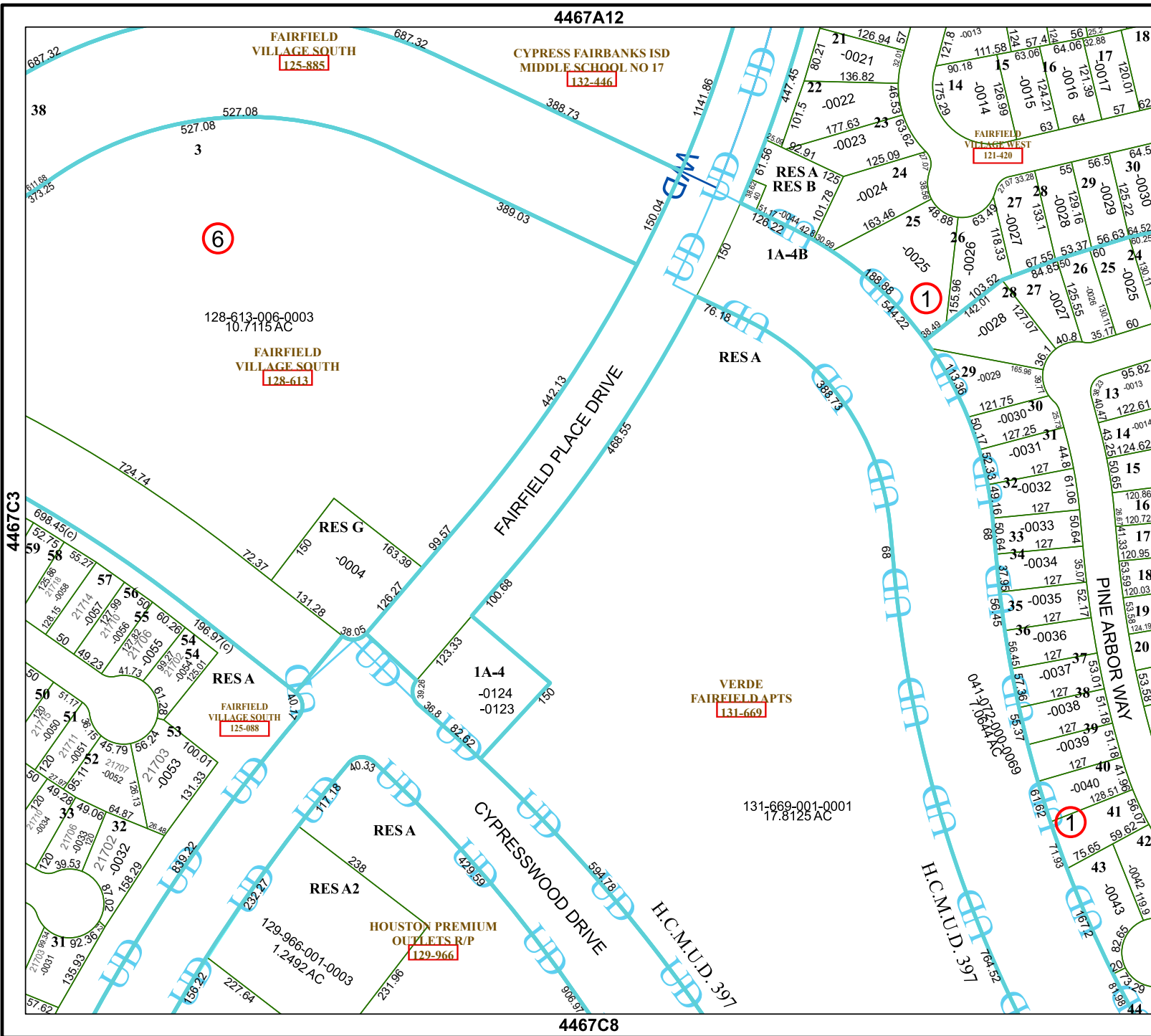

6

1

7

FAIRFIELD VILLAGE SOUTH  
125-885

CYPRESS FAIRBANKS ISD  
MIDDLE SCHOOL NO 17  
132-446

128-613-006-0003  
10.7115 AC

FAIRFIELD VILLAGE SOUTH  
128-613

1A-4B

RESA

RES G

RESA

FAIRFIELD VILLAGE SOUTH  
125-888

1A-4

-0124  
-0123

VERDE FAIRFIELD APTS  
131-669

131-669-001-0001  
17.8125 AC

RESA

RESA2

HOUSTON PREMIUM OUTLETS R/P  
129-966

129-966-001-0003  
1.2492 AC

H.C.M.U.D. 397

PINE ARBOR WAY

H.C.M.U.D. 397

4467C3

4467D1