

4467C2

RES A

Harris Central Appraisal District



0 45 90 180 Feet

PUBLICATION DATE:
12/30/2023

Geospatial or map data maintained by the Harris Central Appraisal District is for informational purposes and may **not** have been prepared for or be suitable for legal, engineering, or surveying purposes. It does **not** represent an on-the-ground survey and only represents the approximate location of property boundaries.



MAP LOCATION

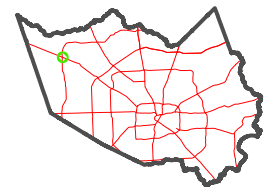

FACET 4467C6

4	1	2	3	4
8	5	6	7	8
12	9	10	11	12

FAIRFIELD HEB
129-804

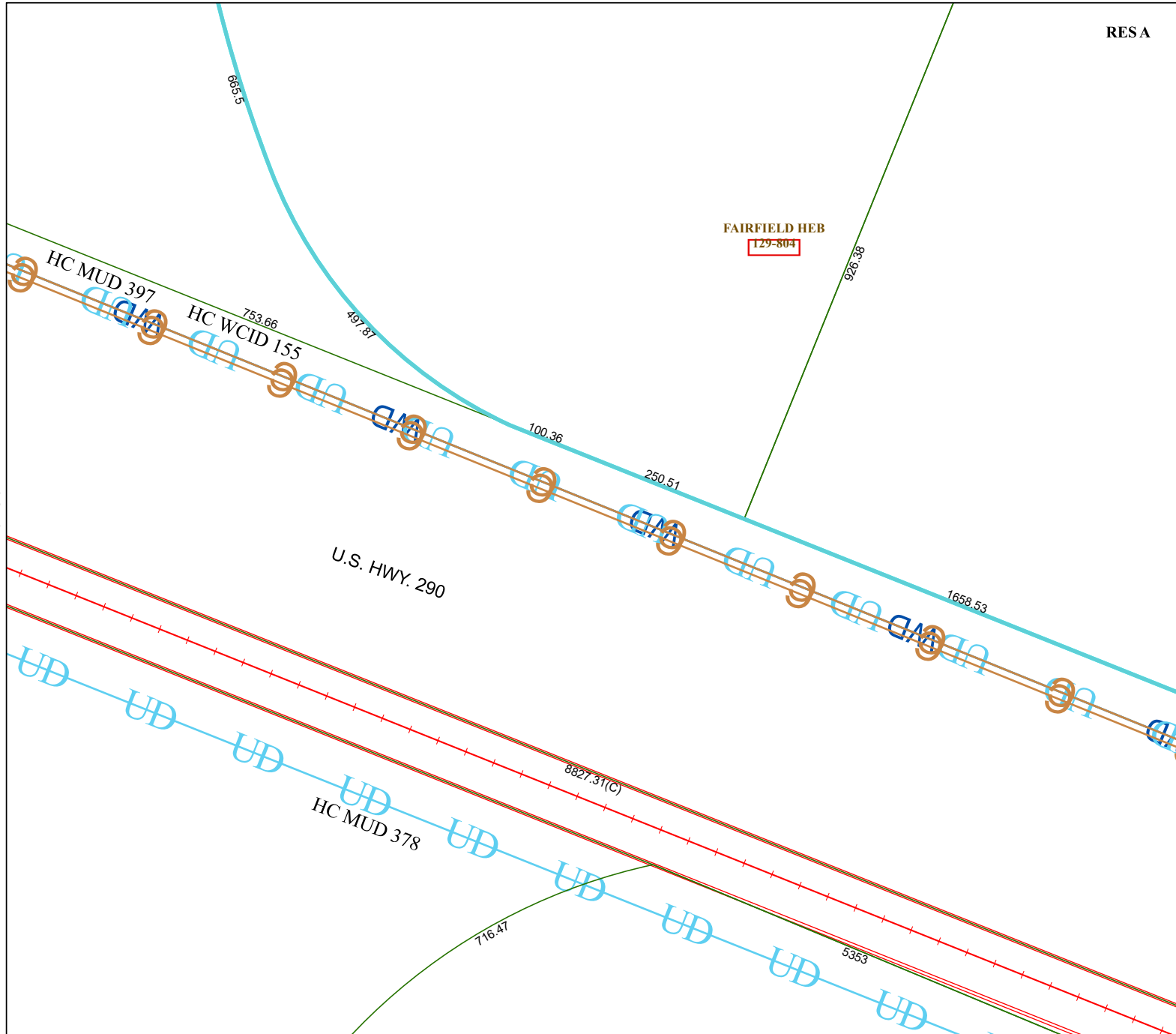

4467C10

4467C5

4467C7