

# Harris Central Appraisal District



0 45 90 180 Feet

PUBLICATION DATE: 1/5/2023

Geospatial or map data maintained by the Harris Central Appraisal District is for informational purposes and may not have been prepared for or be suitable for legal, engineering, or surveying purposes. It does not represent an on-the-ground survey and only represents the approximate location of property boundaries.



MAP LOCATION

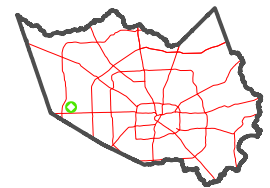

## FACET 4559C5

3	4	1	2	3
7	8	5	6	7
11	12	9	10	11

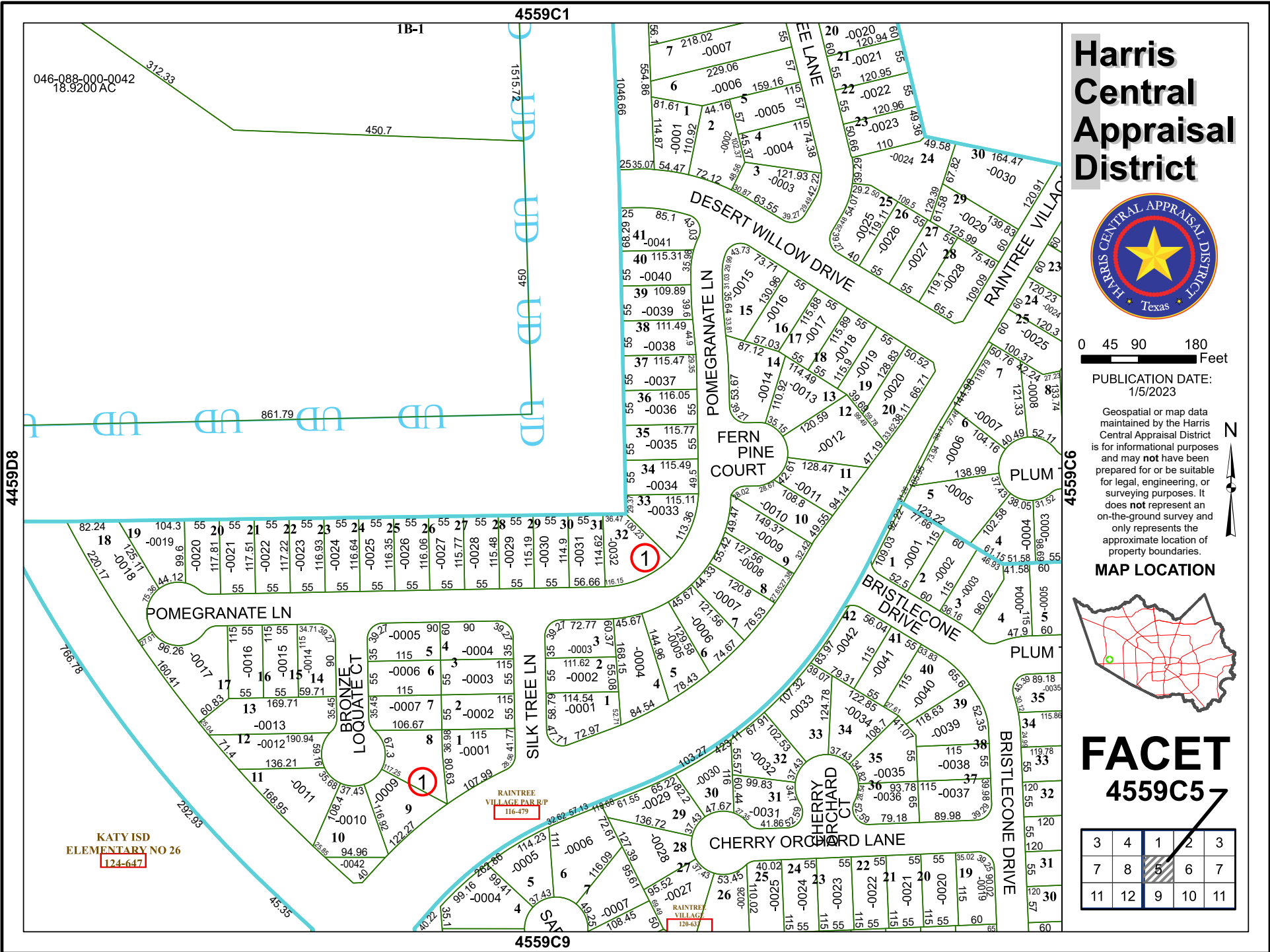

046-088-000-0042  
18.9200 AC

4459D8

4559C1

4559C9

4559C6

1B-1

KATY ISD  
ELEMENTARY NO 26  
124-647

RAIN TREE VILLAGE PAR R/P  
116-479

RAIN TREE VILLAGE  
128-437