

# Harris Central Appraisal District



0 45 90 180 Feet

PUBLICATION DATE: 5/6/2024

Geospatial or map data maintained by the Harris Central Appraisal District is for informational purposes and may not have been prepared for or be suitable for legal, engineering, or surveying purposes. It does not represent an on-the-ground survey and only represents the approximate location of property boundaries.

MAP LOCATION

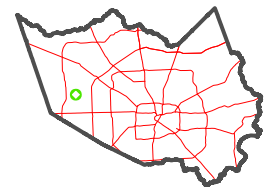

## FACET 4561D5

3	4	1	2	3
7	8	5	6	7
11	12	9	10	11

4561D1

SUMMERLIN DRIVE

BEACHY COURT

RESA

AVENTINE PLANTATION DRIVE

CYPRESS FAIRBANKS ISD ELEMENTARY SCHOOL NO 51

RESA

131-806-001-0001  
15.9090 AC

4561D9

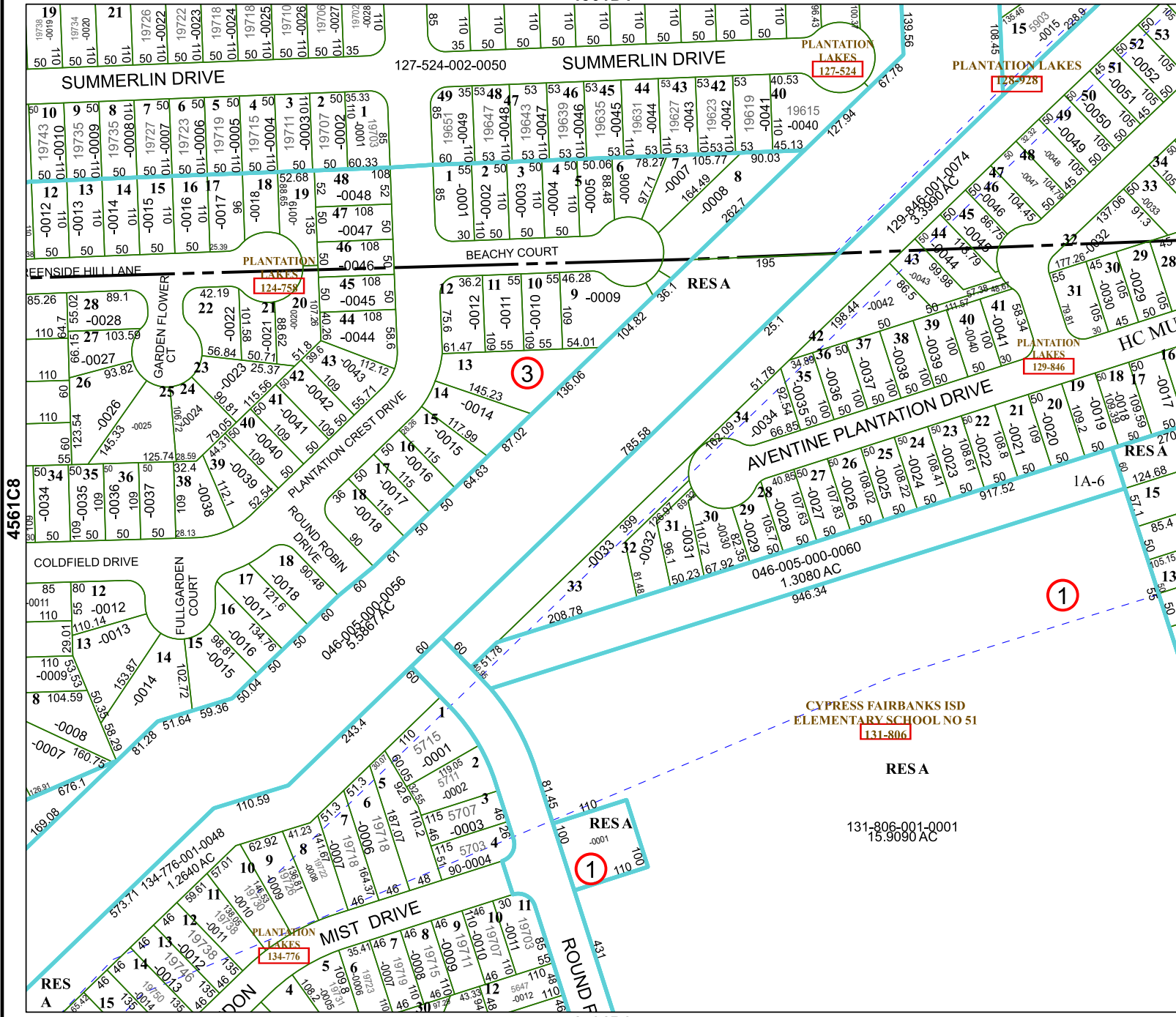

4561C8

4561D6