

4561D2

CYPRESS-FAIRBANKS ISD
ELEMENTARY SCHOOL NO 47
128-704

14G-3

14D-13

765.41 -0457
1.0110 AC

IA-4 285.97

RESA

1

135-447-001-0001
11.3550 AC

0 45 90 180 Feet

PUBLICATION DATE:
1/5/2023

Geospatial or map data maintained by the Harris Central Appraisal District is for informational purposes and may not have been prepared for or be suitable for legal, engineering, or surveying purposes. It does not represent an on-the-ground survey and only represents the approximate location of property boundaries.



MAP LOCATION

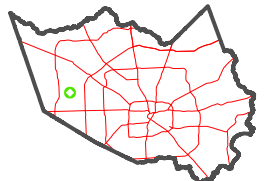

FACET
4561D6

4	1	2	3	4
8	5	6	7	8
12	9	10	11	12

4561D10

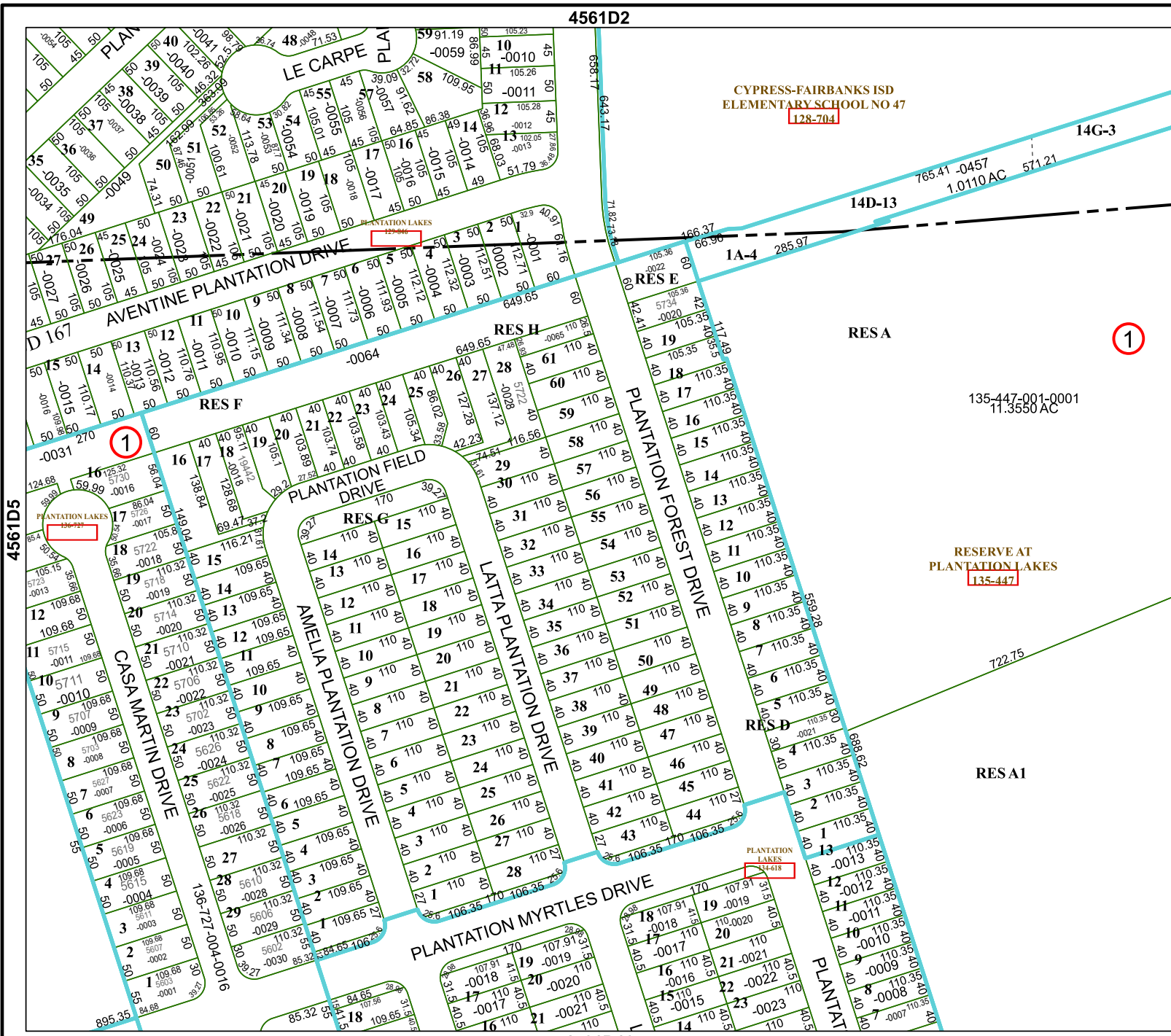

4561D5

4561D7

RESA1

RESERVE AT
PLANTATION LAKES
135-447

PLANTATION LAKES
135-448