

Harris Central Appraisal District



0 45 90 180 Feet

PUBLICATION DATE:
12/30/2023

Geospatial or map data maintained by the Harris Central Appraisal District is for informational purposes and may not be suitable for legal, engineering, or surveying purposes. It does not represent an on-the-ground survey and only represents the approximate location of property boundaries.

MAP LOCATION

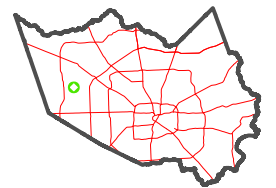

FACET 4562D1

11	12	9	10	11
3	4	1	2	3
7	8	5	6	7

4562B9

AMHURST
SEC 2
117-715

WEST HOUSTON
BAPTIST CHURCH
124-118

4562D5

LANCASTER
115-180

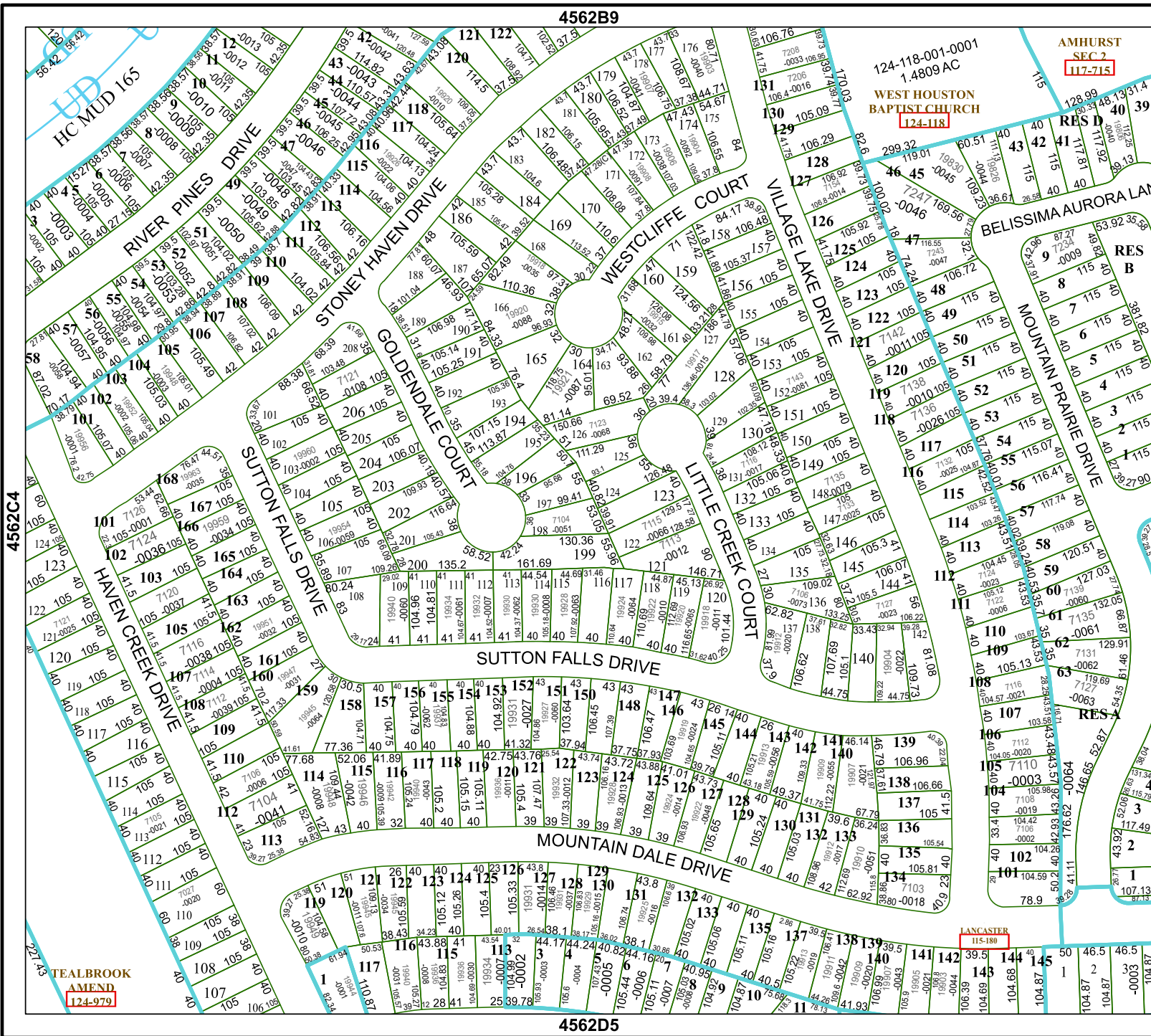

HC MUD 165

4562D2

4562C4

TEALBROOK
AMEND
124-979