

Harris Central Appraisal District



0 45 90 180 Feet

PUBLICATION DATE: 4/3/2023

Geospatial or map data maintained by the Harris Central Appraisal District is for informational purposes and may not have been prepared for or be suitable for legal, engineering, or surveying purposes. It does not represent an on-the-ground survey and only represents the approximate location of property boundaries.

MAP LOCATION

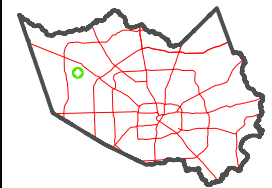

FACET 4564B5

3	4	1	2	3
7	8	5	6	7
11	12	9	10	11

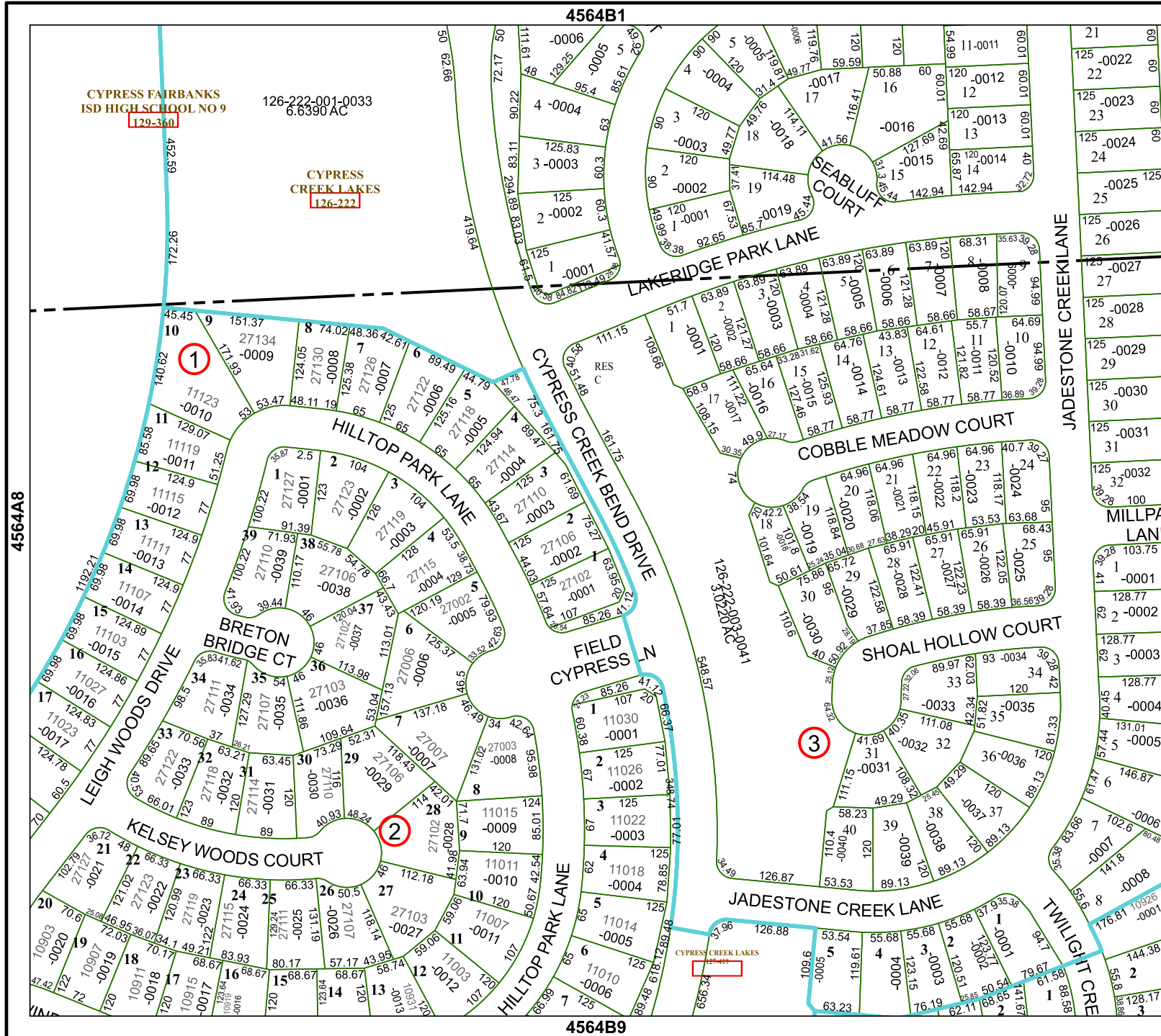

CYPRESS FAIRBANKS
ISD HIGH SCHOOL NO 9
129-360

126-222-001-0033
6.6390 AC

CYPRESS
CREEK LAKES
126-222

4564B1

4564B9

4564A8

4564B6