

4570C1

4B

21114
1.2069 AC

4470D8

4

3
042-101-000-Q011
10.2600 AC

2670 2839 417.55
2258.55 2258.57 495.69 346.22 691.18
187.2 877.78 346.22

3A

3A-1

4570C9

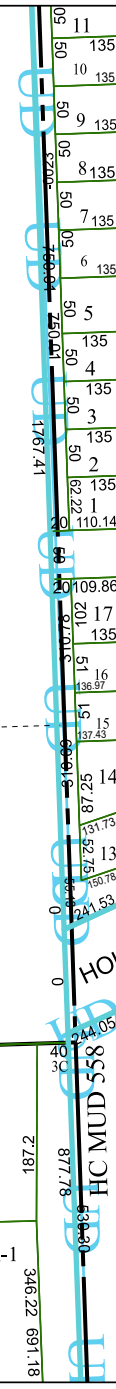

Harris Central Appraisal District



0 45 90 180 Feet

PUBLICATION DATE:
12/30/2023

Geospatial or map data maintained by the Harris Central Appraisal District is for informational purposes and may not have been prepared for or be suitable for legal, engineering, or surveying purposes. It does not represent an on-the-ground survey and only represents the approximate location of property boundaries.



MAP LOCATION

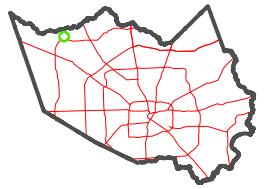

FACET 4570C5

3	4	1	2	3
7	8	5	6	7
11	12	9	10	11