

4658C2

Harris Central Appraisal District



0 45 90 180 Feet

PUBLICATION DATE: 5/21/2024

Geospatial or map data maintained by the Harris Central Appraisal District is for informational purposes and may not have been prepared for or be suitable for legal, engineering, or surveying purposes. It does not represent an on-the-ground survey and only represents the approximate location of property boundaries.



MAP LOCATION

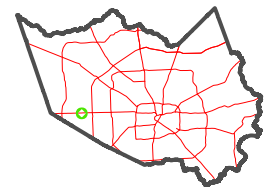

FACET 4658C6

4	1	2	3	4
8	5	6	7	8
12	9	10	11	12

CITY OF HOUSTON

HC ESD 48 (EMS/FIRE)

I.H. 10

4658C5

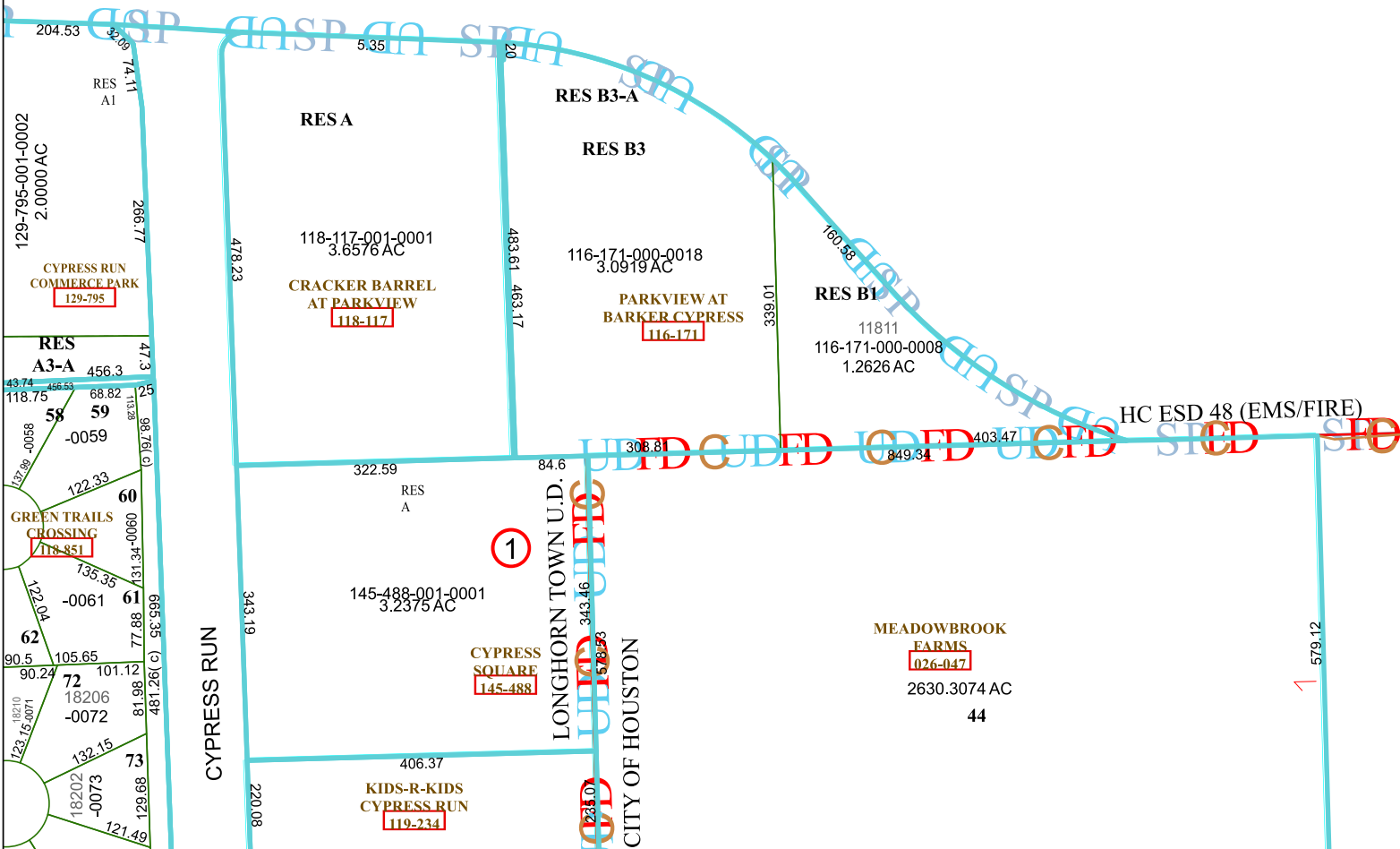

HC ESD 48 (EMS/FIRE)

1

LONGHORN TOWN U.D.
CITY OF HOUSTON

4658C10