

# Harris Central Appraisal District



0 45 90 180 Feet

PUBLICATION DATE: 1/9/2025

Geospatial or map data maintained by the Harris Central Appraisal District is for informational purposes and may not have been prepared for or be suitable for legal, engineering, or surveying purposes. It does not represent an on-the-ground survey and only represents the approximate location of property boundaries.

MAP LOCATION

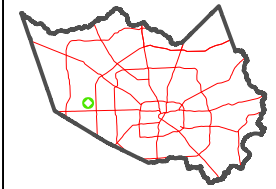

## FACET 4659A12

6	7	8	5	6
10	11	12	9	10
2	3	4	1	2

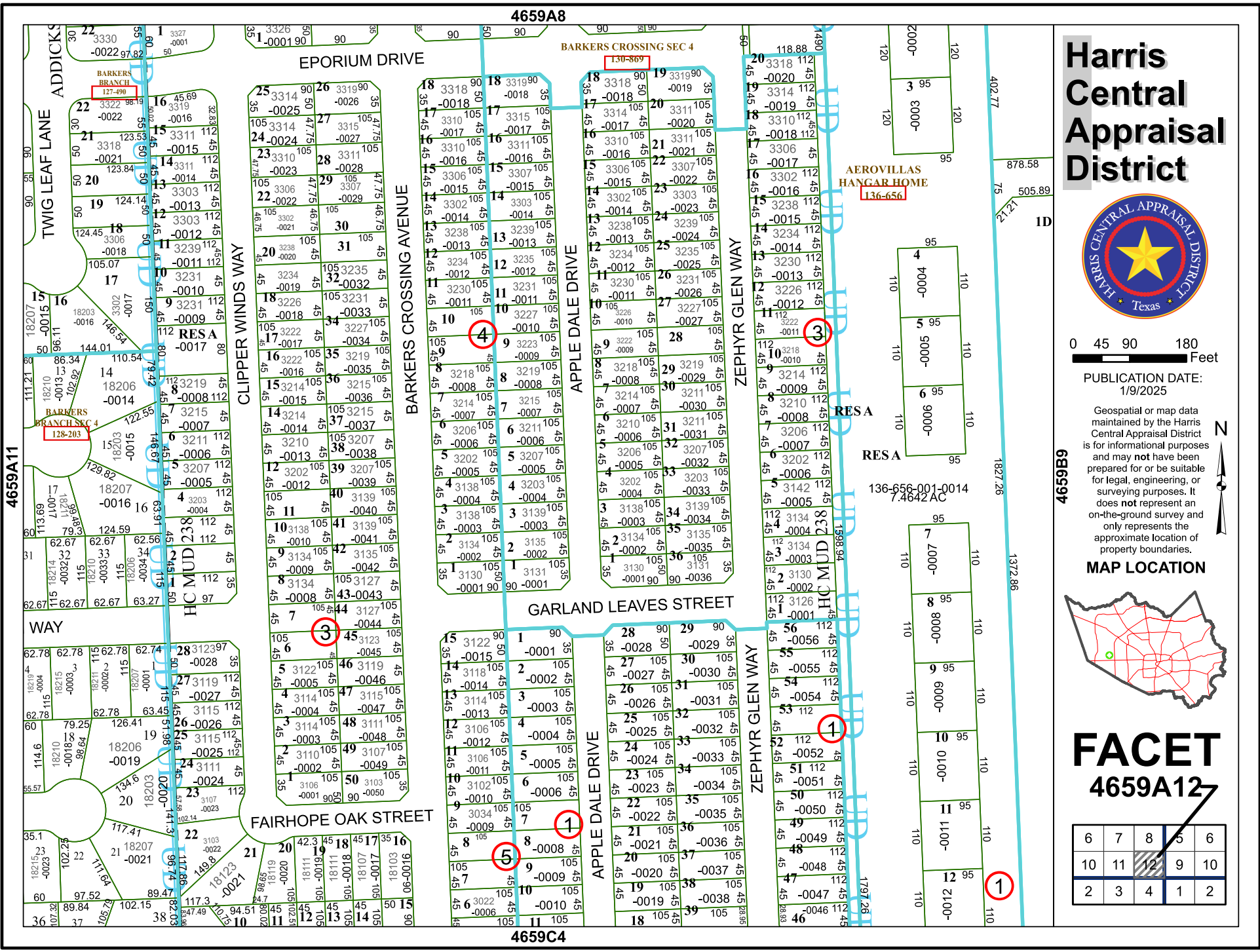

4659A8

4659C4

4659A11

4659B

1D

1

