

Harris Central Appraisal District



0 45 90 180 Feet

PUBLICATION DATE: 5/6/2024

Geospatial or map data maintained by the Harris Central Appraisal District is for informational purposes and may not have been prepared for or be suitable for legal, engineering, or surveying purposes. It does not represent an on-the-ground survey and only represents the approximate location of property boundaries.

MAP LOCATION

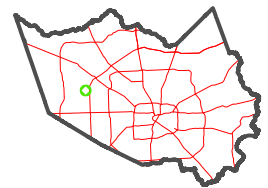

FACET 4661B3

9	10	11	12	9
1	2	3	4	1
5	6	7	8	5

4662D11

4661B7

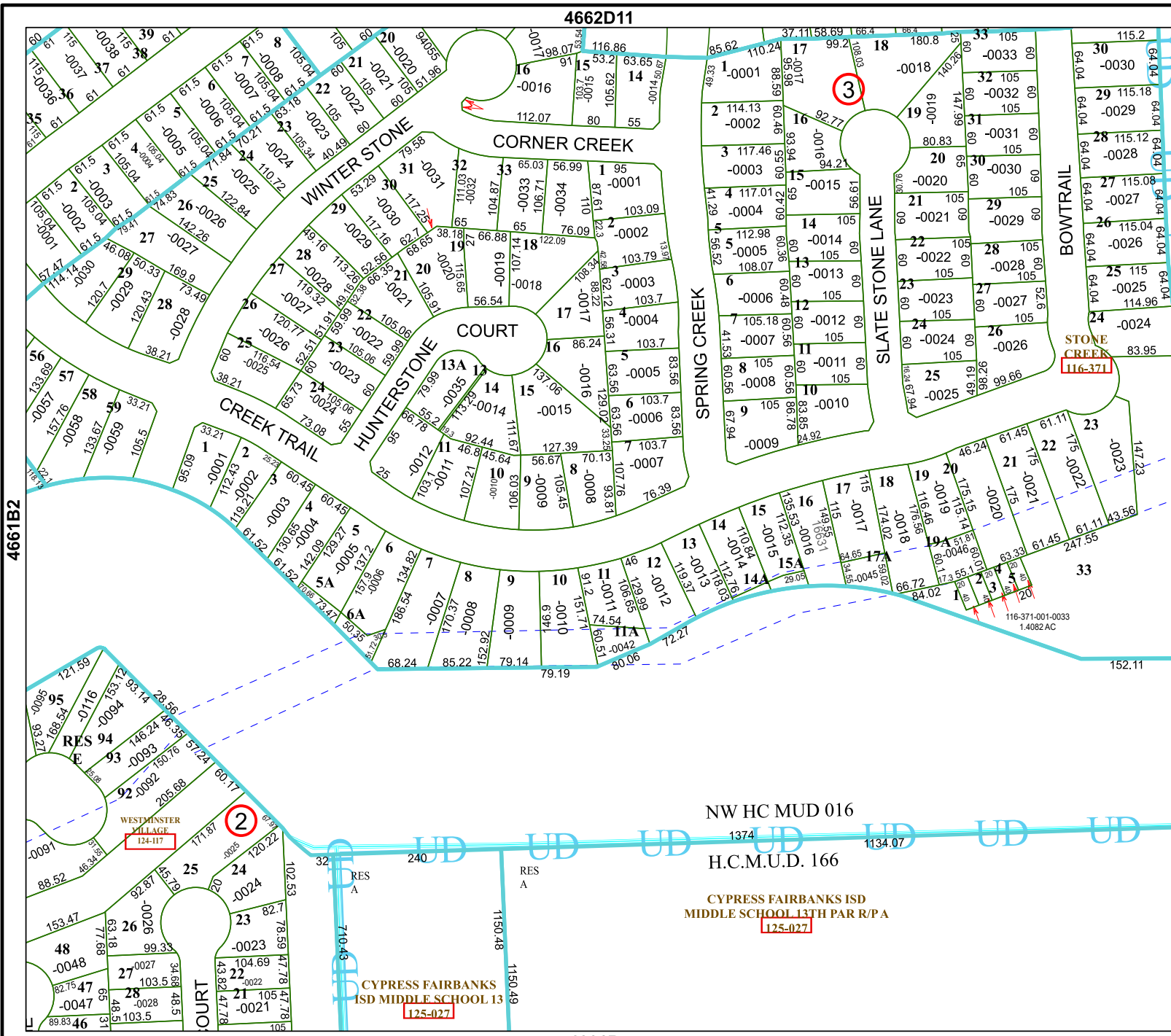

NW HC MUD 016

H.C.M.U.D. 166

CYPRESS FAIRBANKS ISD
MIDDLE SCHOOL 13TH PAR R/P A
125-027

CYPRESS FAIRBANKS
ISD MIDDLE SCHOOL 13
125-027

WESTMINSTER VILLAGE
124-117

RES 94
124-117