

Harris Central Appraisal District



0 45 90 180 Feet

PUBLICATION DATE: 1/5/2023

Geospatial or map data maintained by the Harris Central Appraisal District is for informational purposes and may not have been prepared for or be suitable for legal, engineering, or surveying purposes. It does not represent an on-the-ground survey and only represents the approximate location of property boundaries.

MAP LOCATION

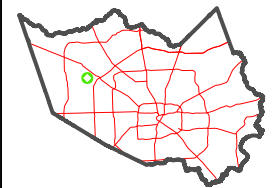

FACET 4663B1

11	12	9	10	11
3	4	1	2	3
7	8	5	6	7

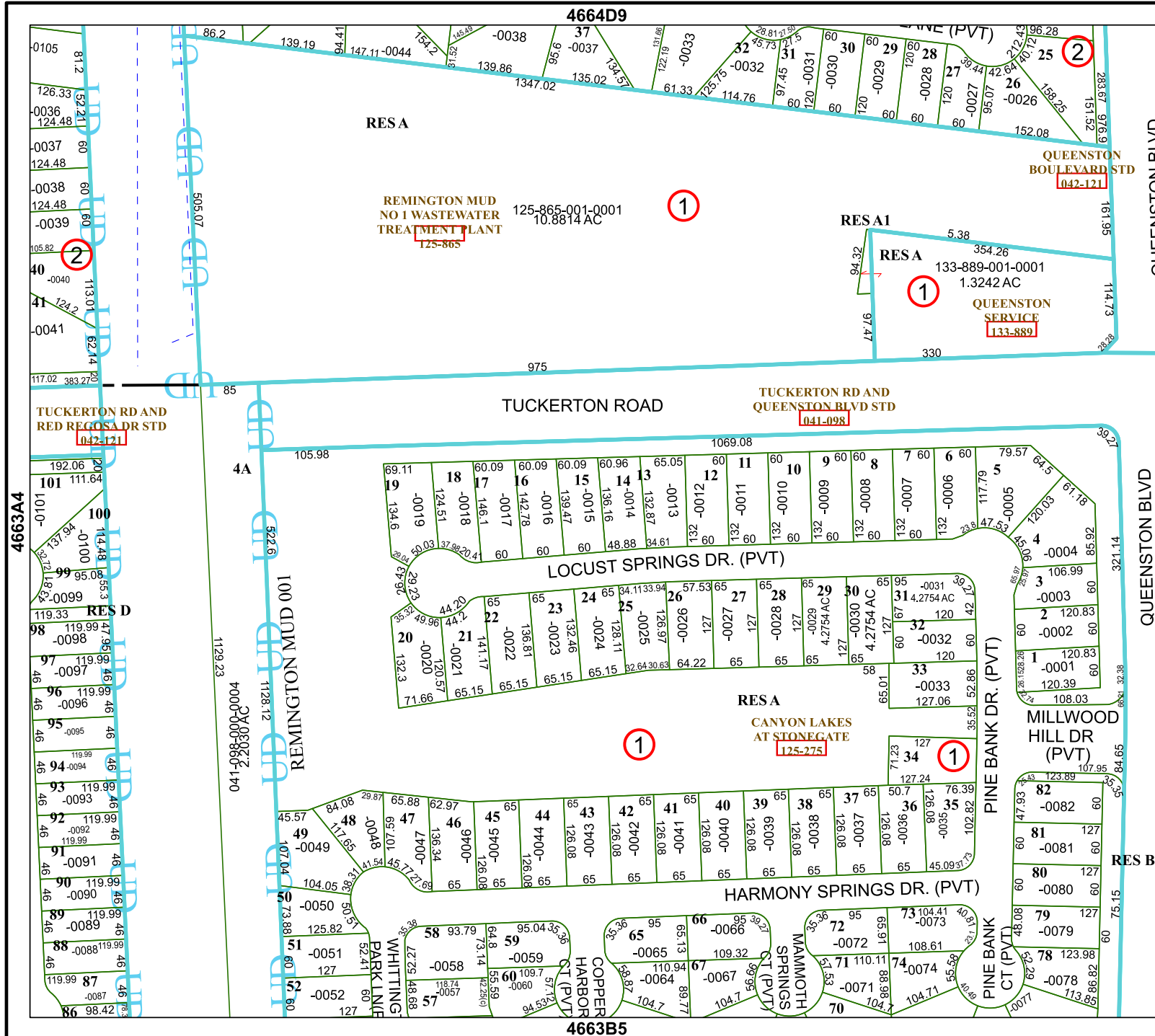

4663A4

4663B5

QUEENSTON BLVD

QUEENSTON BLVD

4663B2

4664D9

4663B5