

4663C2

CYPRESS-FAIRBANKS
ISD ESC AND STADIUM
125-814

RES AI
BARKER CYPRESS
RESERVE
141-240
141-240-001-0003
RES A2
1.0100 AC

Harris Central Appraisal District



0 45 90 180 Feet

PUBLICATION DATE:
4/22/2024

Geospatial or map data maintained by the Harris Central Appraisal District is for informational purposes and may not have been prepared for or be suitable for legal, engineering, or surveying purposes. It does not represent an on-the-ground survey and only represents the approximate location of property boundaries.

MAP LOCATION

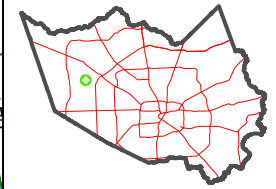

FACET 4663C6

4	1	2	3	4
8	5	6	7	8
12	9	10	11	12

4663C10

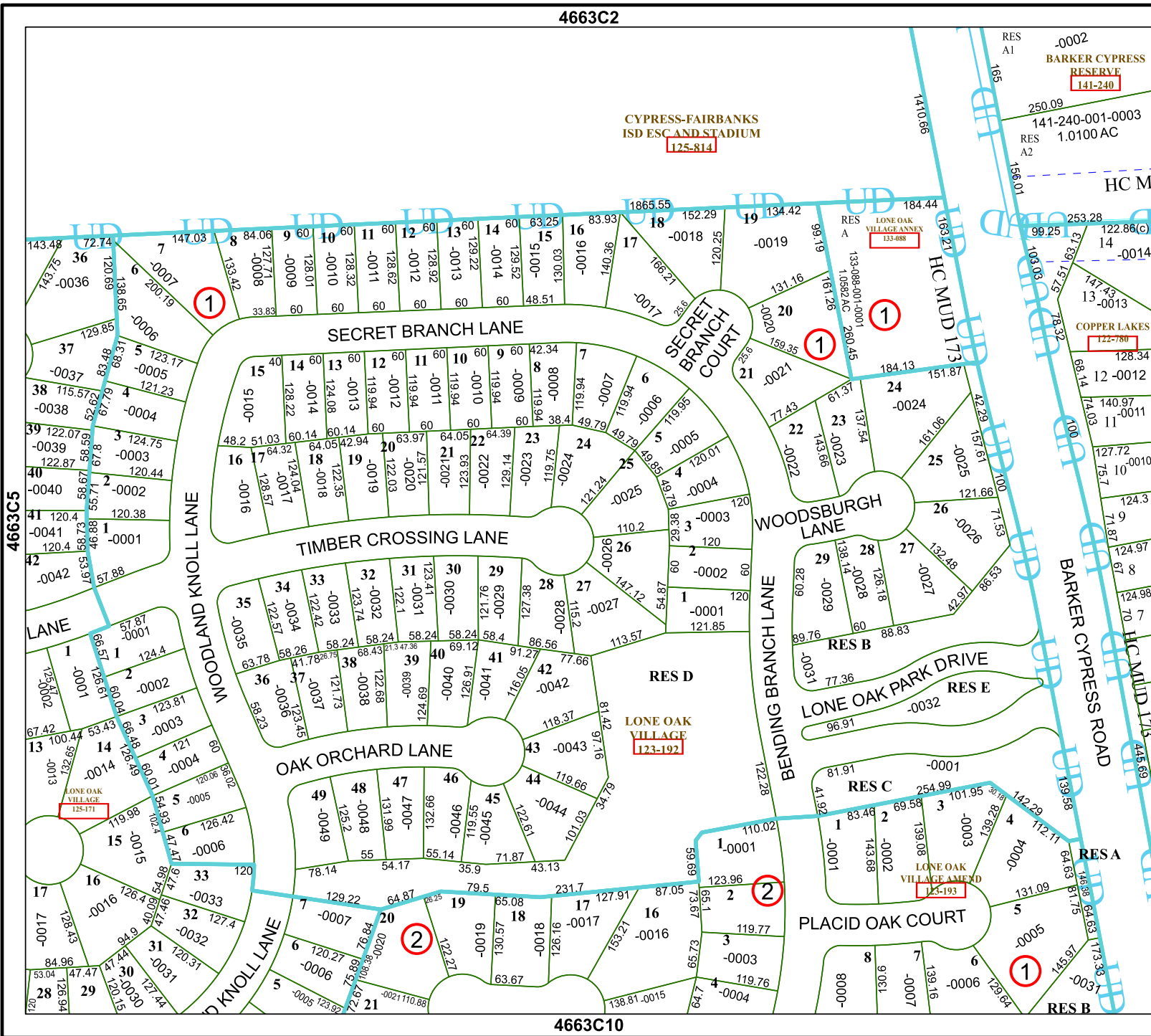

4663C5

4663C3

LONE OAK VILLAGE
125-171

LONE OAK VILLAGE
123-192

LONE OAK VILLAGE ANNEX
133-088

COPPER LAKES
122-780

LONE OAK VILLAGE ANNEX
125-193

1

1

2

2

1