

Harris Central Appraisal District



0 45 90 180 Feet

PUBLICATION DATE:
1/5/2023

Geospatial or map data maintained by the Harris Central Appraisal District is for informational purposes and may not have been prepared for or be suitable for legal, engineering, or surveying purposes. It does not represent an on-the-ground survey and only represents the approximate location of property boundaries.

MAP LOCATION

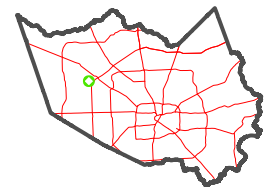

FACET

4663D4

10	11	12	9	10
2	3	4	1	2
6	7	8	5	6

4663B12

4663D8

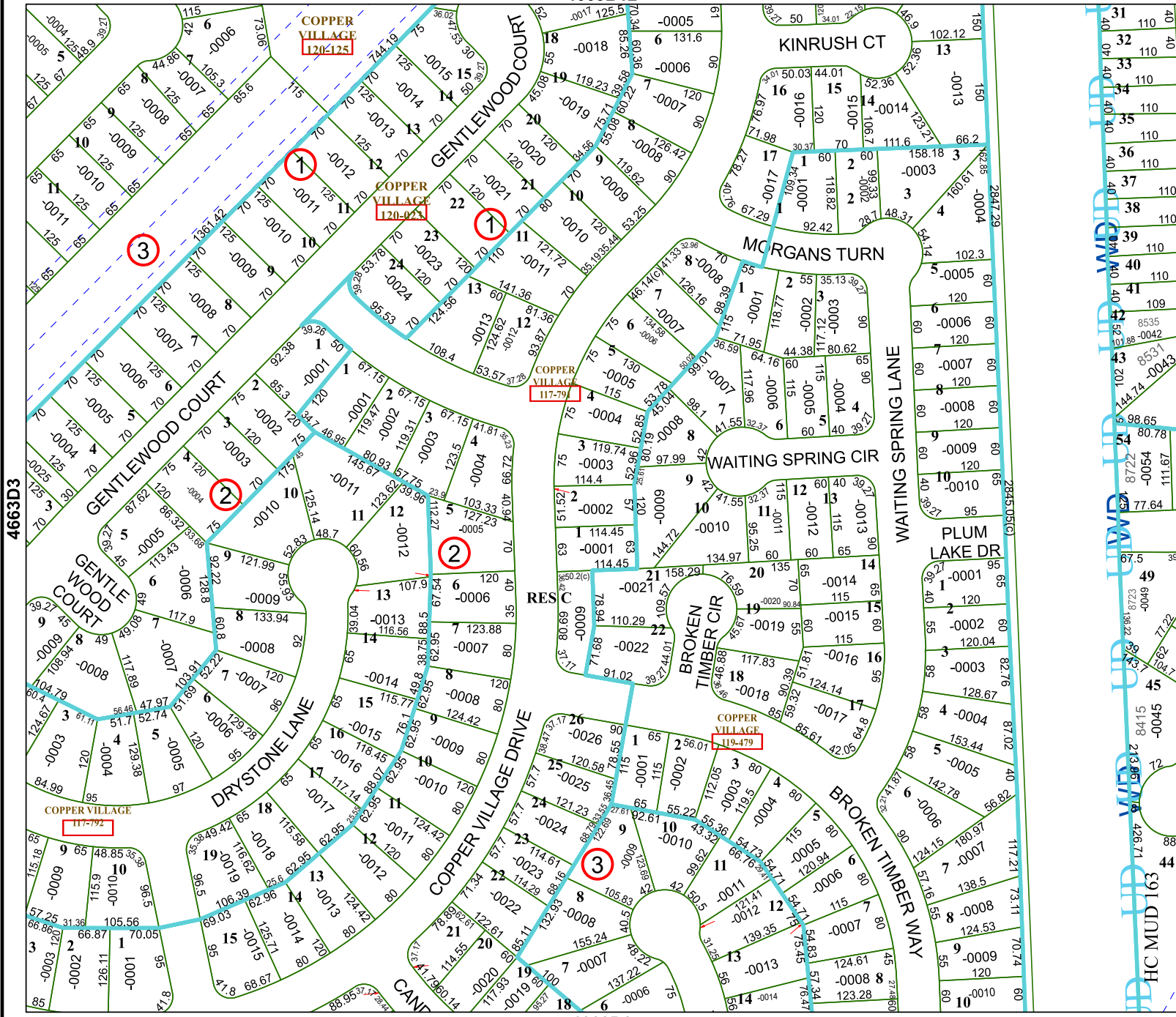

4763C1

4663D3

31 110
32 110
33 110
34 110
35 110
36 110
37 110
38 110
39 110
40 110
41 109
42 110
43 8535
44 8531
45 98.65
46 80.78
47 5050-
48 7272
49 77.64
50 79.11
51 67.5
52 6400-
53 6278
54 573.7
55 104.7
56 49
57 6400-
58 5148
59 2138
60 42671
61 117.21
62 73.11
63 70.74
64 80