

Harris Central Appraisal District



0 45 90 180 Feet

PUBLICATION DATE:
2/13/2024

Geospatial or map data maintained by the Harris Central Appraisal District is for informational purposes and may not have been prepared for or be suitable for legal, engineering, or surveying purposes. It does not represent an on-the-ground survey and only represents the approximate location of property boundaries.

MAP LOCATION

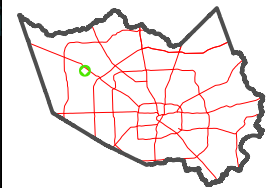

FACET

4665C11

5	6	7	8	5
9	10	11	12	9
1	2	3	4	1

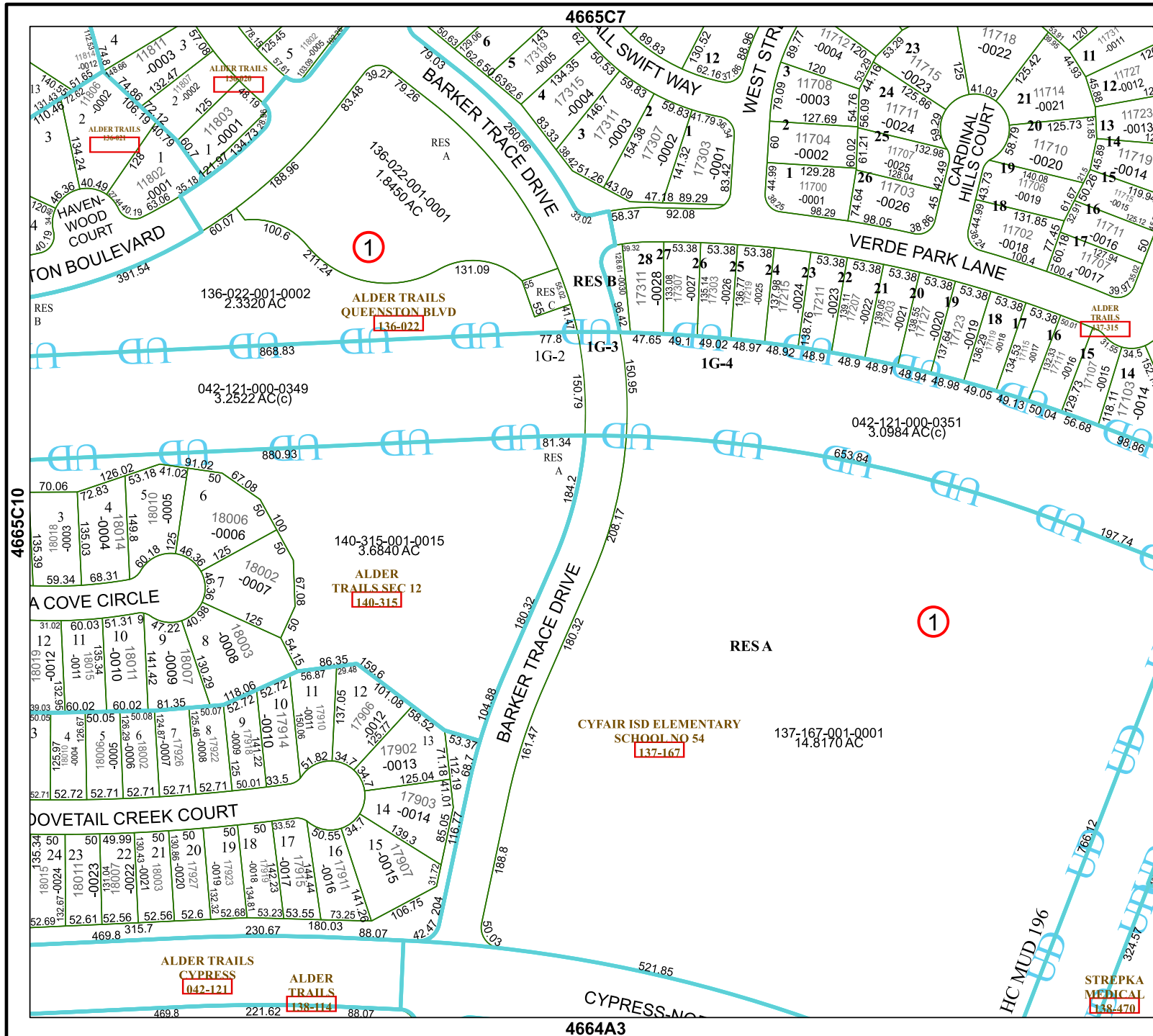

4665C7

4664A3

4665C10

4665C12

ALDER TRAILS
CYPRESS
136-022

ALDER TRAILS
138-114

ALDER TRAILS
QUEENSTON BLVD
136-022

ALDER TRAILS SEC 12
140-315

CYFAIR ISD ELEMENTARY
SCHOOL NO 54
137-167

137-167-001-0001
14.8170 AC

STREPKA
MEDICAL
138-470

1

1

