

Harris Central Appraisal District



0 45 90 180 Feet

PUBLICATION DATE: 1/23/2024

Geospatial or map data maintained by the Harris Central Appraisal District is for informational purposes and may not have been prepared for or be suitable for legal, engineering, or surveying purposes. It does not represent an on-the-ground survey and only represents the approximate location of property boundaries.

MAP LOCATION

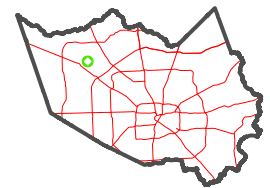

FACET

4666B11

5	6	7	8	5
9	10	11	12	9
1	2	3	4	1

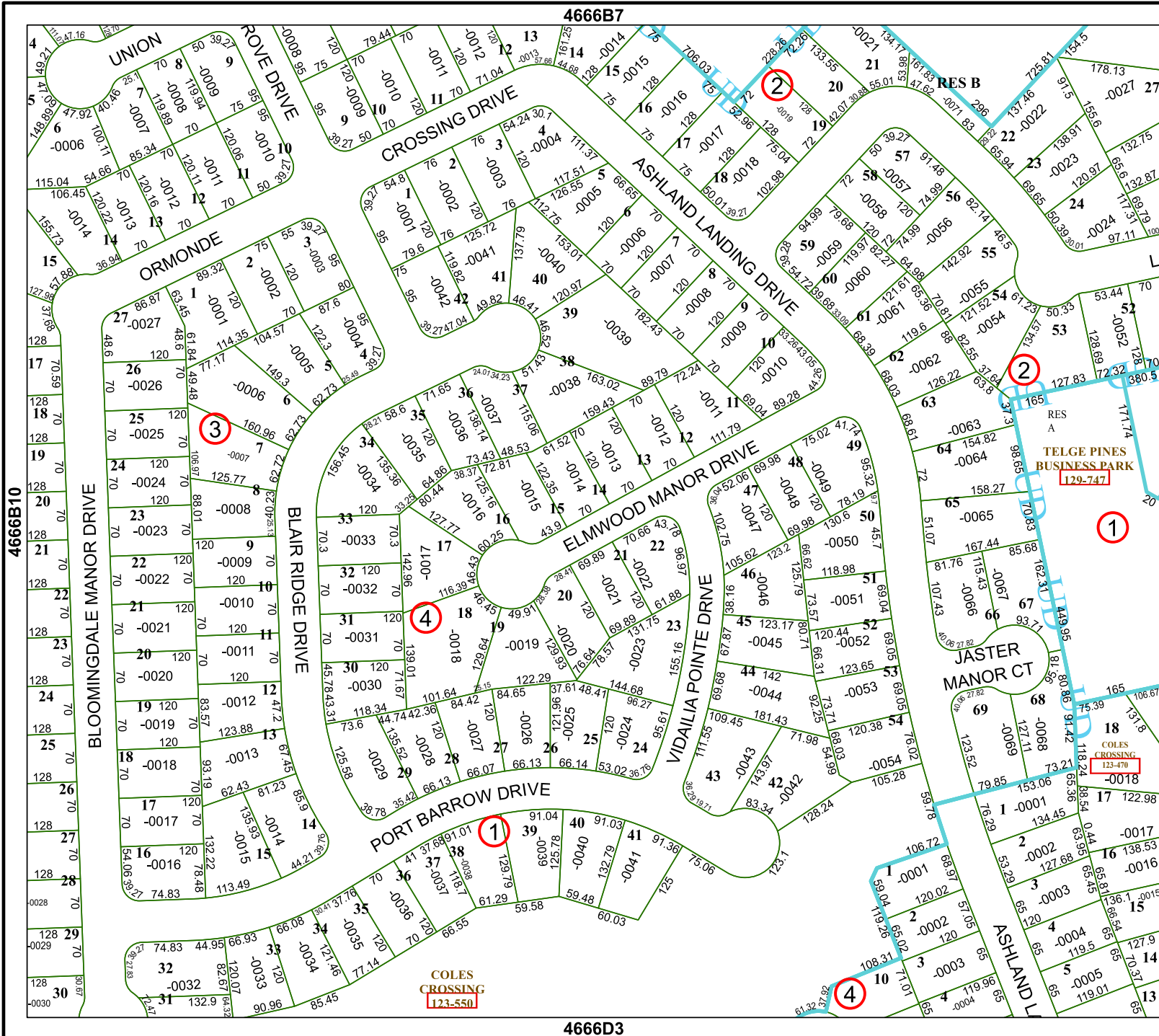

4666B7

4666D3

4666B10

4666B12