

Harris Central Appraisal District



0 45 90 180 Feet

PUBLICATION DATE:
2/13/2024

Geospatial or map data maintained by the Harris Central Appraisal District is for informational purposes and may not have been prepared for or be suitable for legal, engineering, or surveying purposes. It does not represent an on-the-ground survey and only represents the approximate location of property boundaries.

MAP LOCATION

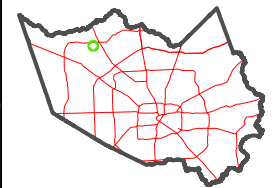

FACET 4769C10

8	5	6	7	8
12	9	10	11	12
4	1	2	3	4

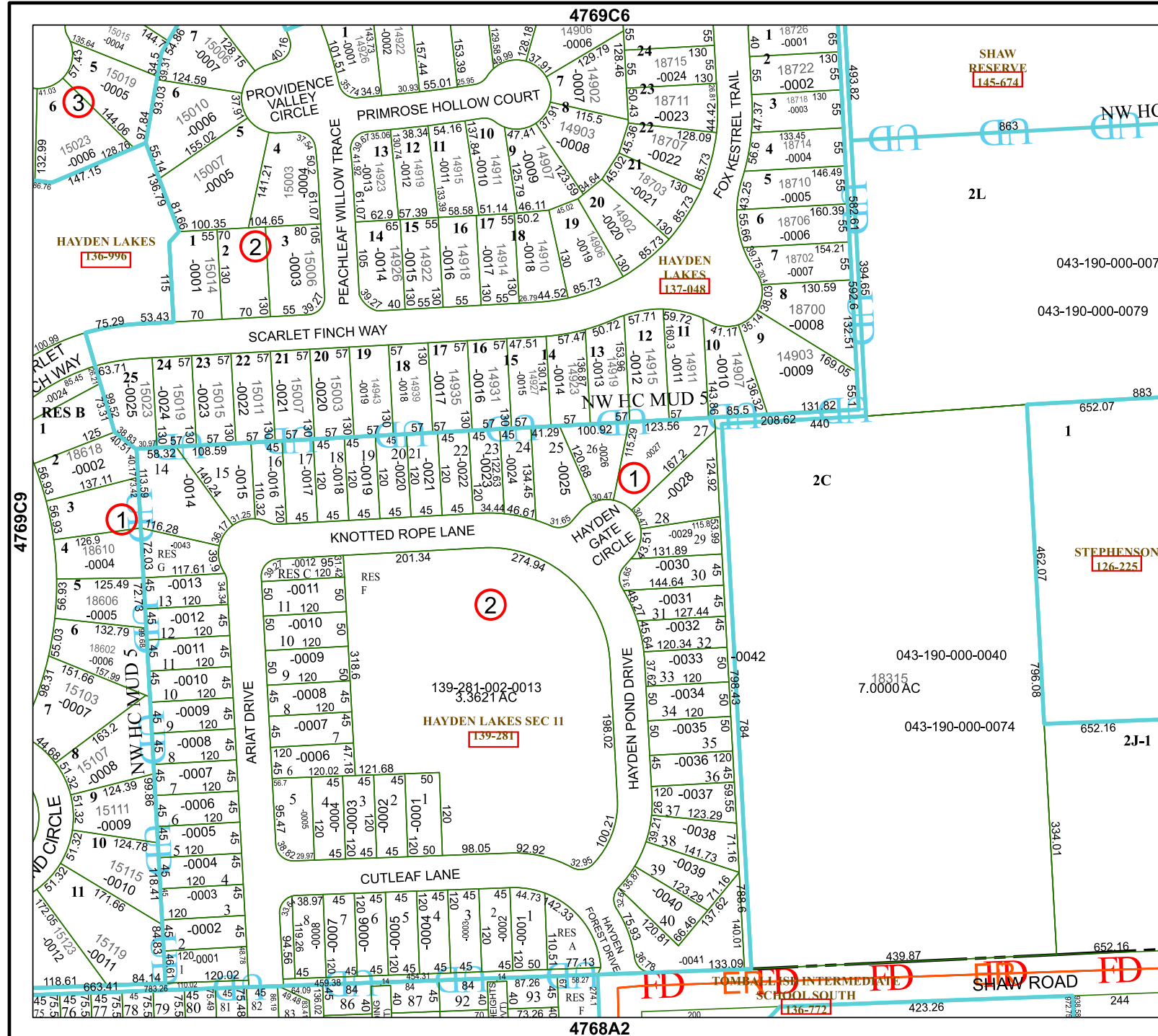

SHAW RESERVE
145-674

HAYDEN LAKES
136-996

HAYDEN LAKES
137-048

STEPHENSON
126-225

HAYDEN LAKES SEC II
139-281

4768A2

FD TOMPALEISI INTERMEDIATE SCHOOL SOUTH
136-772

SHAW ROAD FD