

4854A9

CITY OF HOUSTON

Harris Central Appraisal District



0 45 90 180 Feet

PUBLICATION DATE: 1/5/2023

Geospatial or map data maintained by the Harris Central Appraisal District is for informational purposes and may not have been prepared for or be suitable for legal, engineering, or surveying purposes. It does not represent an on-the-ground survey and only represents the approximate location of property boundaries.

MAP LOCATION

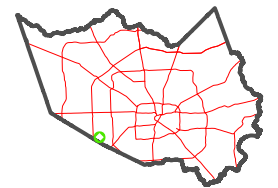

FACET 4854C1

11	12	9	10	11
3	4	1	2	3
7	8	5	6	7

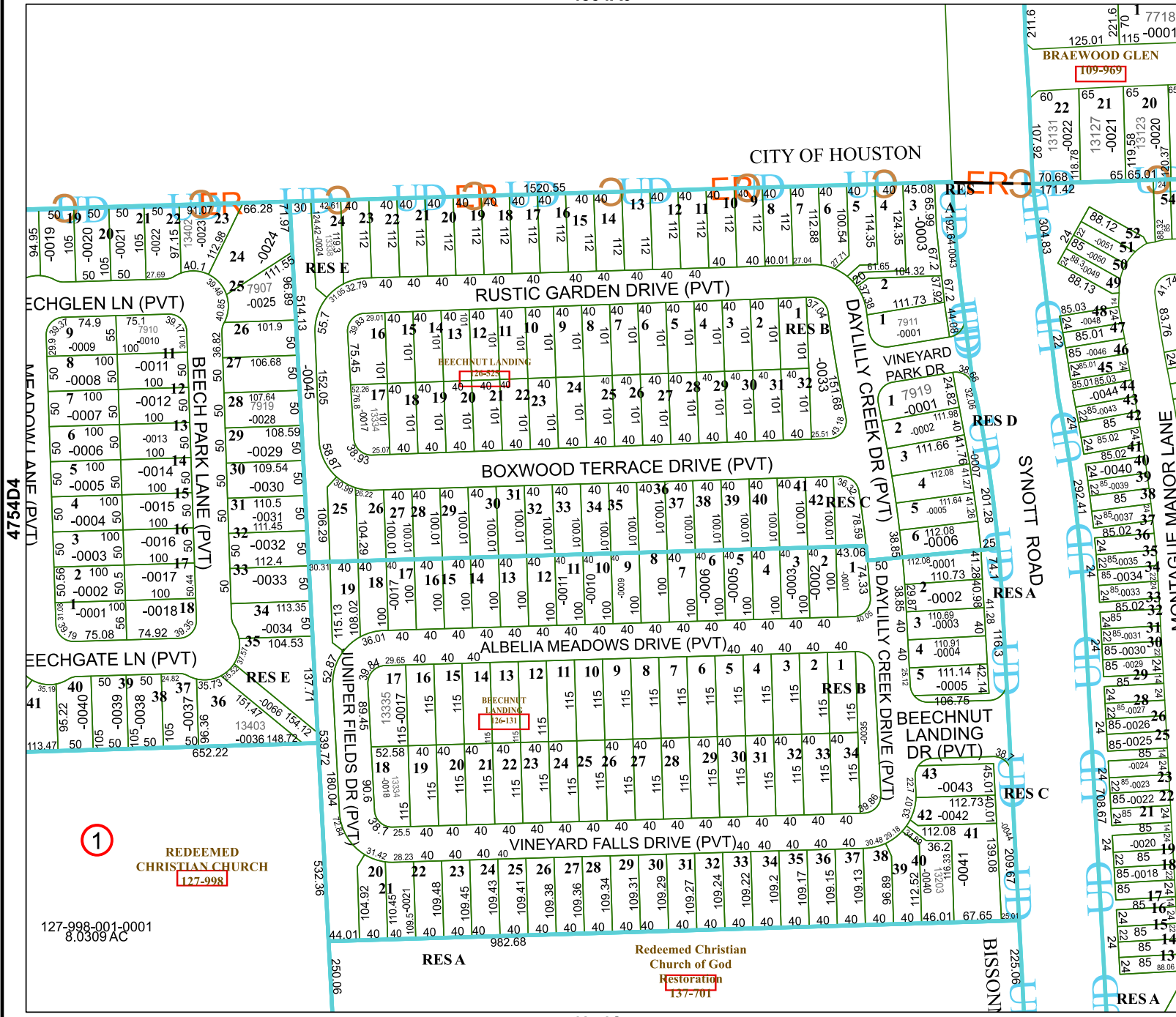

REDEEMED CHRISTIAN CHURCH 127-998

Redeemed Christian Church of God Restoration 137-701

4854C5

127-998-001-0001 8.0309 AC

1