

4856D6

4855B2

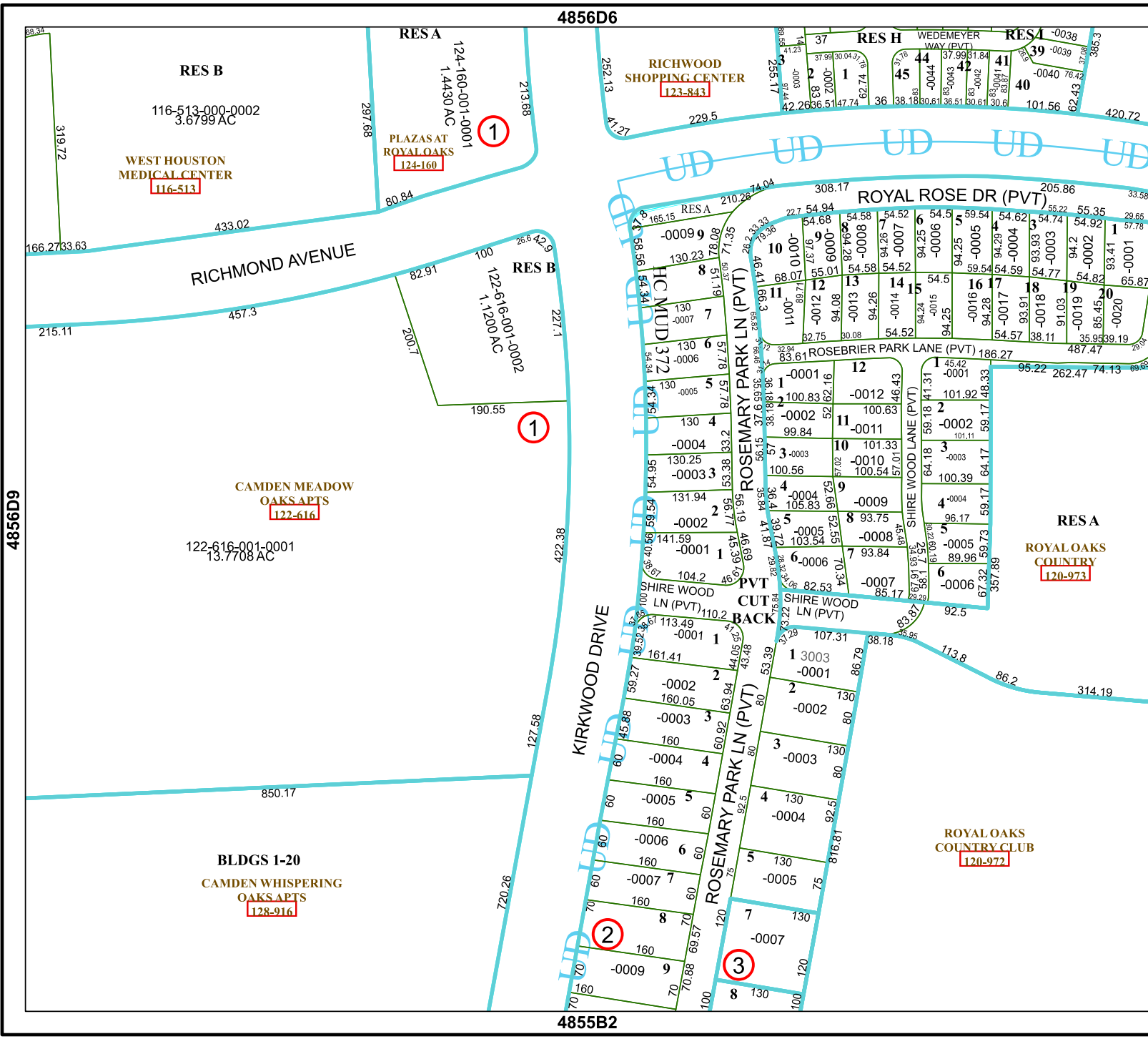

Harris Central Appraisal District



0 45 90 180 Feet

PUBLICATION DATE: 6/5/2023

Geospatial or map data maintained by the Harris Central Appraisal District is for informational purposes and may not have been prepared for or be suitable for legal, engineering, or surveying purposes. It does not represent an on-the-ground survey and only represents the approximate location of property boundaries.

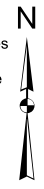

MAP LOCATION

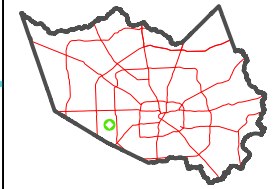

FACET 4856D10

8	5	6	7	8
12	9	10	11	12
4	1	2	3	4

4856D9

4856D11

RES B
116-513-000-0002
3.6799 AC
WEST HOUSTON MEDICAL CENTER
116-513

RES A
124-160-001-0001
1.4430 AC
PLAZAS AT ROYAL OAKS
124-160

RICHWOOD SHOPPING CENTER
123-843

RES H WEDEMAYER WAY (PVT)
RES A -0038
39 -0039
40 -0040
41 -0041
42 -0042
43 -0043

RICHMOND AVENUE

RES B
122-616-001-00022
1.1200 AC

HC MUD 372

ROYAL ROSE DR (PVT)

ROSEMARY PARK LN (PVT)

ROSEBRIER PARK LANE (PVT)

SHIRE WOOD LANE (PVT)

CAMDEN MEADOW OAKS APTS
122-616
122-616-001-0001
13.7708 AC

RES A
ROYAL OAKS COUNTRY
120-973

SHIRE WOOD LN (PVT)

CUT BACK LN (PVT)

SHIRE WOOD LN (PVT)

BLDGS 1-20
CAMDEN WHISPERING OAKS APTS
128-916

ROYAL OAKS COUNTRY CLUB
120-972

KIRKWOOD DRIVE

ROSEMARY PARK LN (PVT)

2

3