

# Harris Central Appraisal District



0 45 90 180 Feet

PUBLICATION DATE: 1/5/2023

Geospatial or map data maintained by the Harris Central Appraisal District is for informational purposes and may not be suitable for legal, engineering, or surveying purposes. It does not represent an on-the-ground survey and only represents the approximate location of property boundaries.

MAP LOCATION

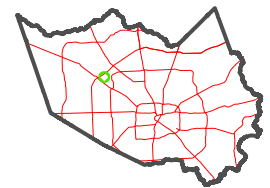

## FACET 4864D9

7	8	5	6	7
11	12	9	10	11
3	4	1	2	3

BLDGS 1 THRU 28

JONES ROAD APARTMENTS  
[119-820]

4864D5

4863B1

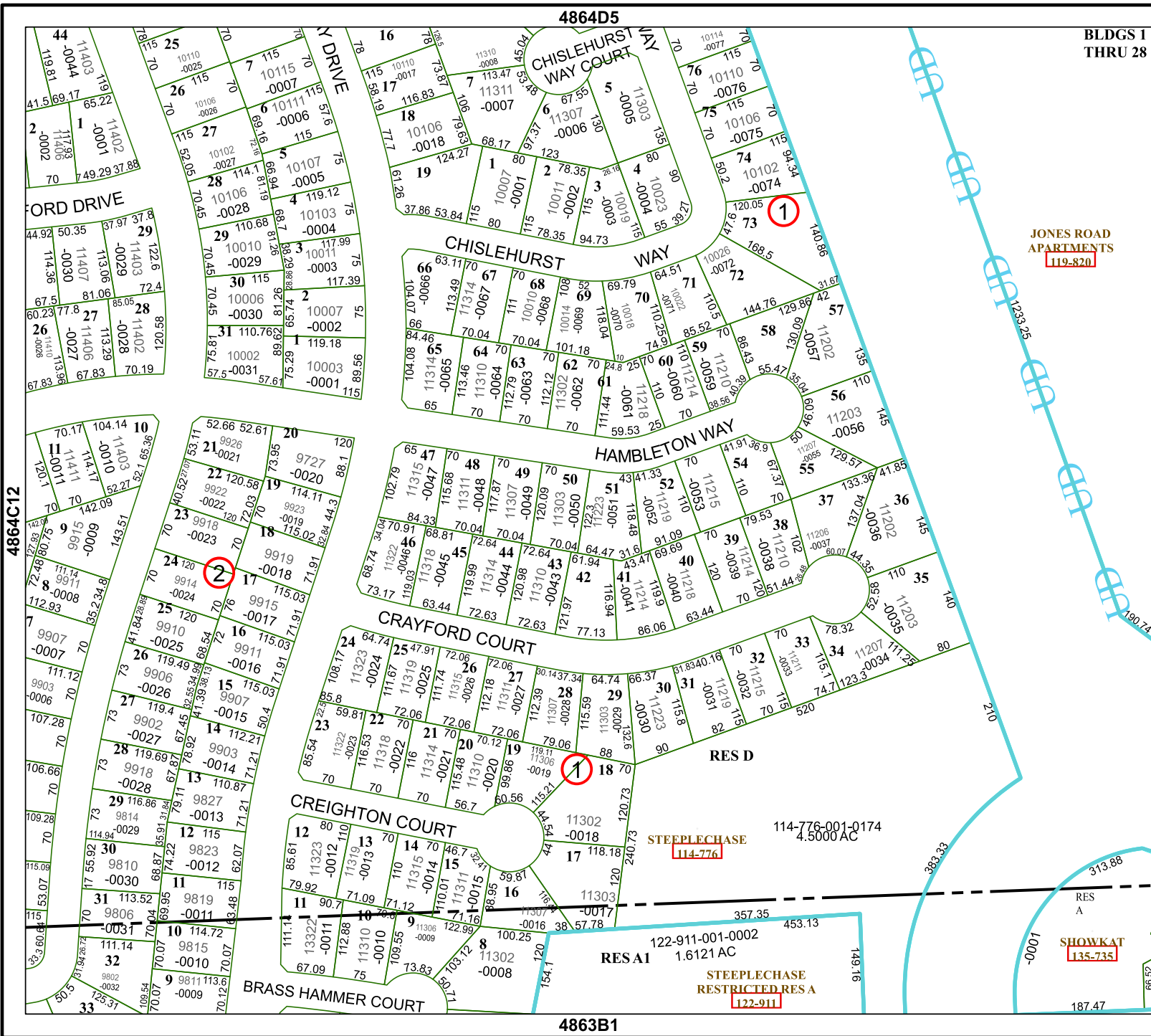

4864C12

4864D10

STEEPLECHASE  
[114-776]

STEEPLECHASE RESTRICTED RES A  
[122-911]

SHOWKAT  
[135-735]

RES D 114-776-001-0174 4.5000 AC

RES A1 122-911-001-0002 1.6121 AC

RES A