

# Harris Central Appraisal District



0 45 90 180 Feet

PUBLICATION DATE: 1/5/2023

Geospatial or map data maintained by the Harris Central Appraisal District is for informational purposes and may not have been prepared for or be suitable for legal, engineering, or surveying purposes. It does not represent an on-the-ground survey and only represents the approximate location of property boundaries.

MAP LOCATION

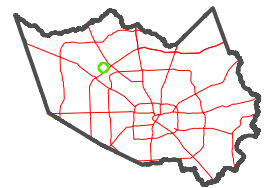

## FACET 4865B10

8	5	6	7	8
12	9	10	11	12
4	1	2	3	4

4865B6

4865D2

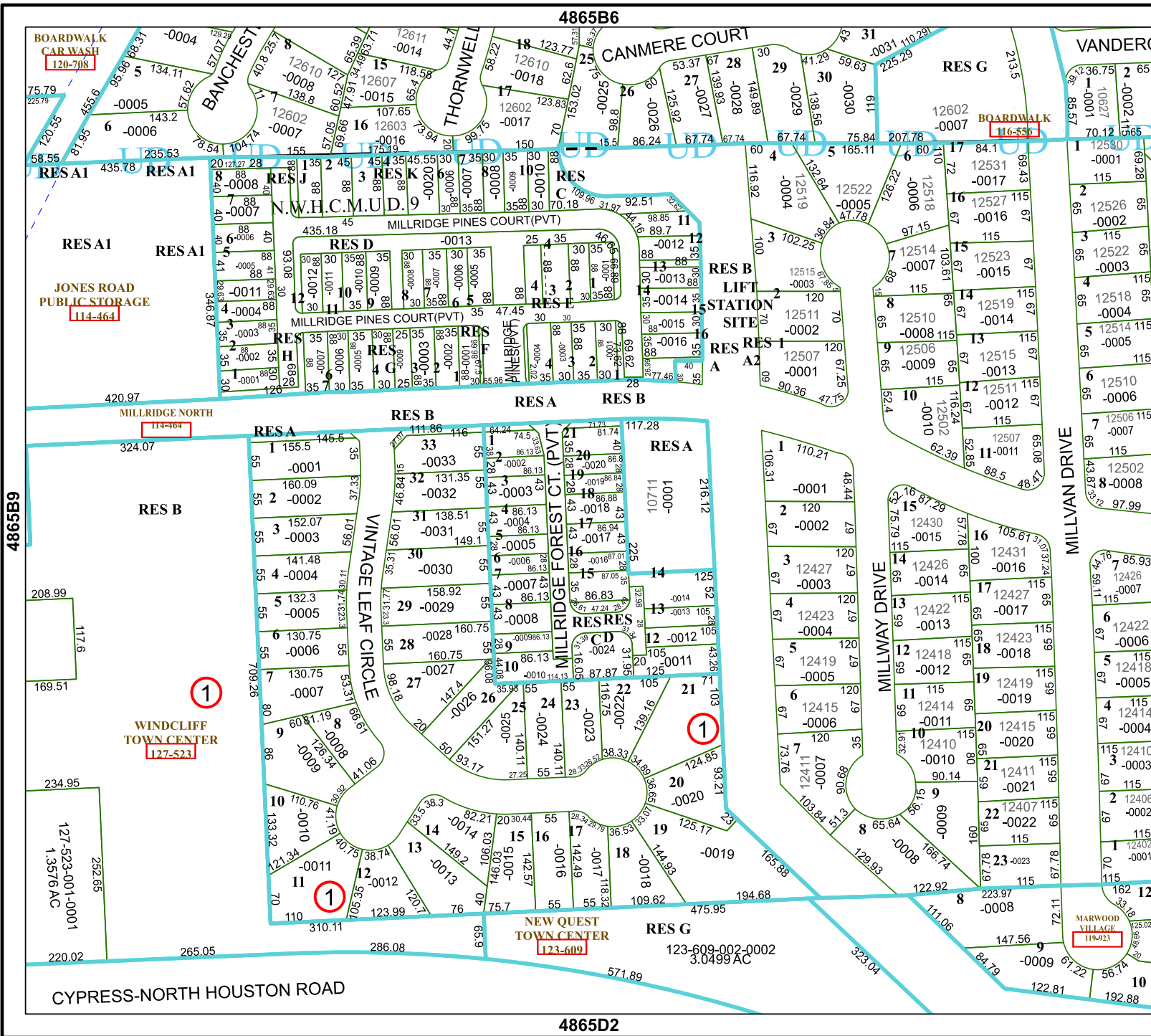

BOARDWALK CAR WASH  
120-708

BOARDWALK  
116-556

JONES ROAD PUBLIC STORAGE  
114-464

MILLRIDGE NORTH  
114-404

WINDCLIFF TOWN CENTER  
127-523

NEW QUEST TOWN CENTER  
123-609

MARWOOD VILLAGE  
119-923

1

1

1

4865B11