

4955B9

4955D5

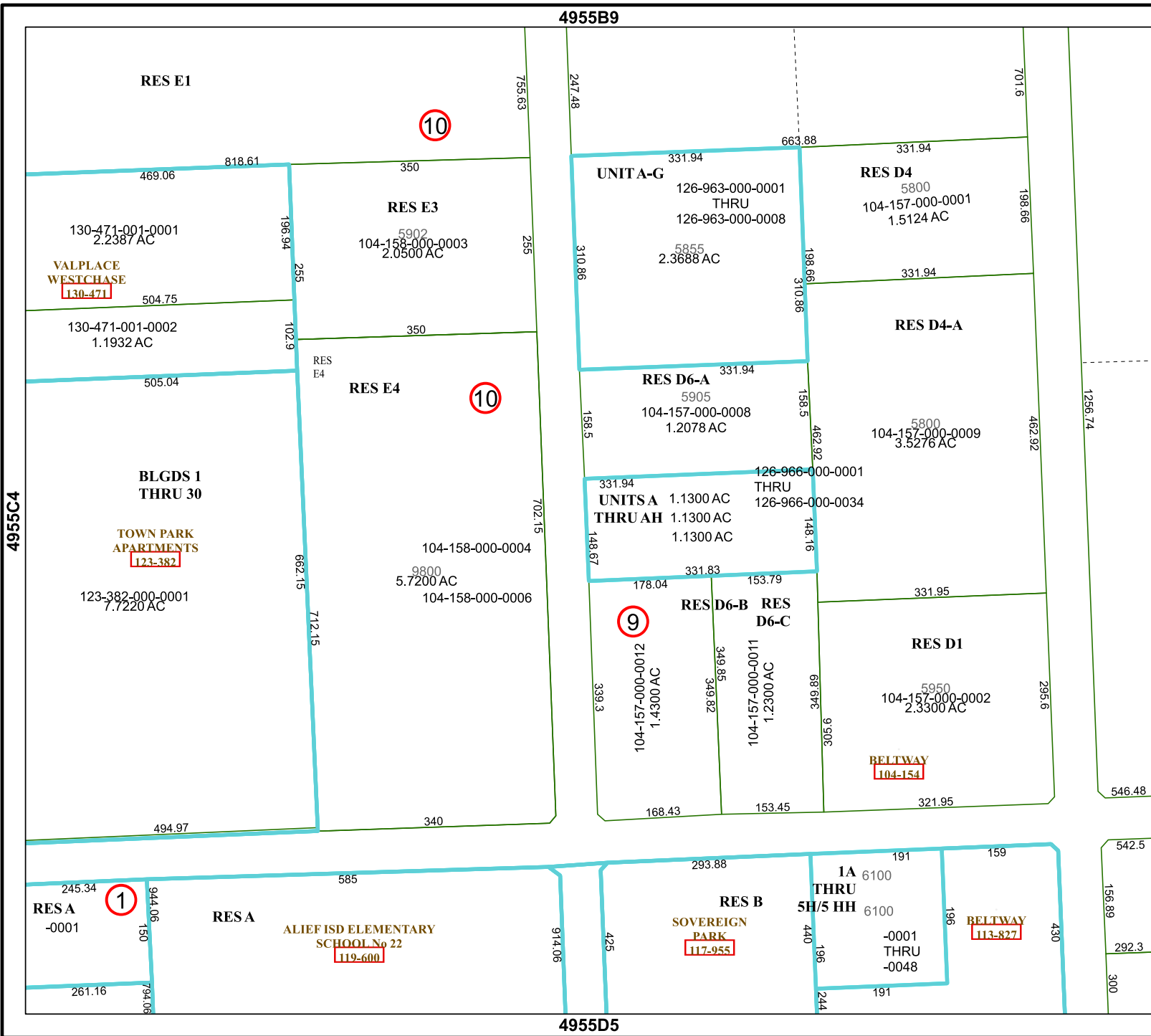

Harris Central Appraisal District



0 45 90 180 Feet

PUBLICATION DATE: 12/30/2023

Geospatial or map data maintained by the Harris Central Appraisal District is for informational purposes and may not be suitable for legal, engineering, or surveying purposes. It does not represent an on-the-ground survey and only represents the approximate location of property boundaries.



MAP LOCATION

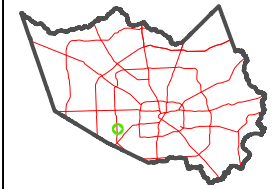

FACET 4955D1

11	12	9	10	11
3	4	1	2	3
7	8	5	6	7

4955C4

4955D2

1

10

10

9

113-827

117-955

VALPLACE WESTCHASE 130-471

TOWN PARK APARTMENTS 123-382

ALIEF ISD ELEMENTARY SCHOOL No 22 119-600

UNITA-G 26-963-000-0001 THRU 126-963-000-0008 5855 2.3688 AC

RES D4 5800 104-157-000-0001 1.5124 AC

RES D6-A 5905 104-157-000-0008 1.2078 AC

UNITS A THRU AH 1.1300 AC

RES D6-B RES D6-C 1100-000-0000 THRU 104-157-151-0001 1.4300 AC

RES D1 5950 104-157-000-0002 2.3300 AC

RES A -0001

RES A

RES B SOVEREIGN PARK 117-955

1A THRU 5H/5 HH -0001 THRU -0048

BELTWAY 113-827