

4956C4

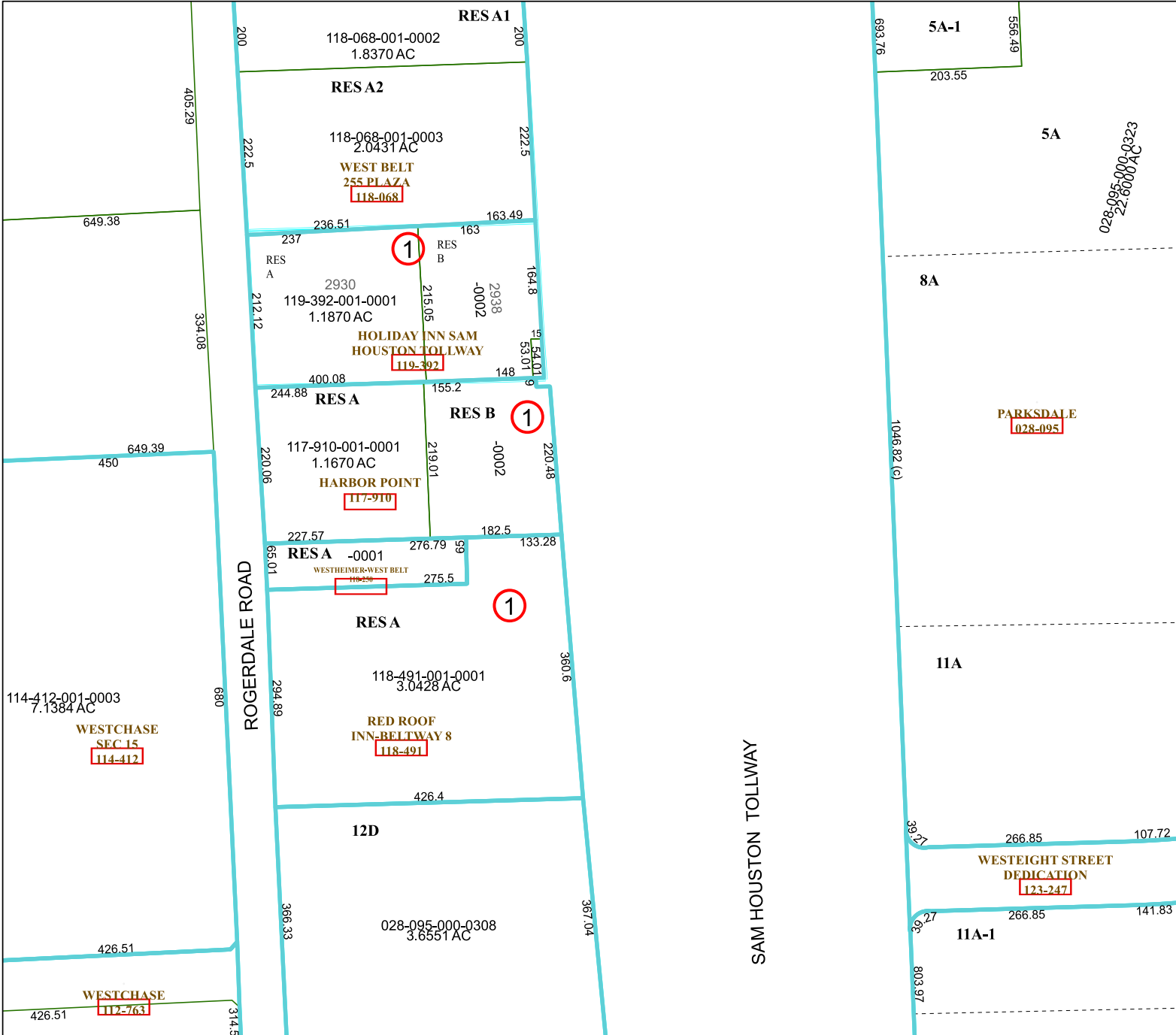

4956C12

Harris Central Appraisal District



0 45 90 180 Feet

PUBLICATION DATE: 1/5/2023

Geospatial or map data maintained by the Harris Central Appraisal District is for informational purposes and may not have been prepared for or be suitable for legal, engineering, or surveying purposes. It does not represent an on-the-ground survey and only represents the approximate location of property boundaries.



MAP LOCATION

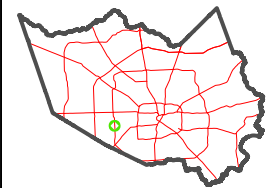

FACET 4956C8

2	3	4	1	2
6	7	8	5	6
10	11	12	9	10

4956C7

4956D5

SAM HOUSTON TOLLWAY

5A-1

5A

8A

PARKSDALE 028-095

11A

11A-1