

4965D7

4965D10

# Harris Central Appraisal District



0 50 100 200 Feet

PUBLICATION DATE:  
12/9/2025

Geospatial or map data maintained by the Harris Central Appraisal District is for informational purposes and may **not** have been prepared for or be suitable for legal, engineering, or surveying purposes. It does **not** represent an on-the-ground survey and only represents the approximate location of property boundaries.



## MAP LOCATION

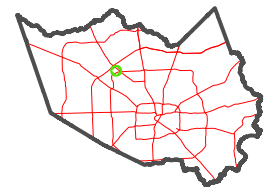

## FACET 4965D11

5	6	7	8	5
9	10	11	12	9
1	2	3	4	1

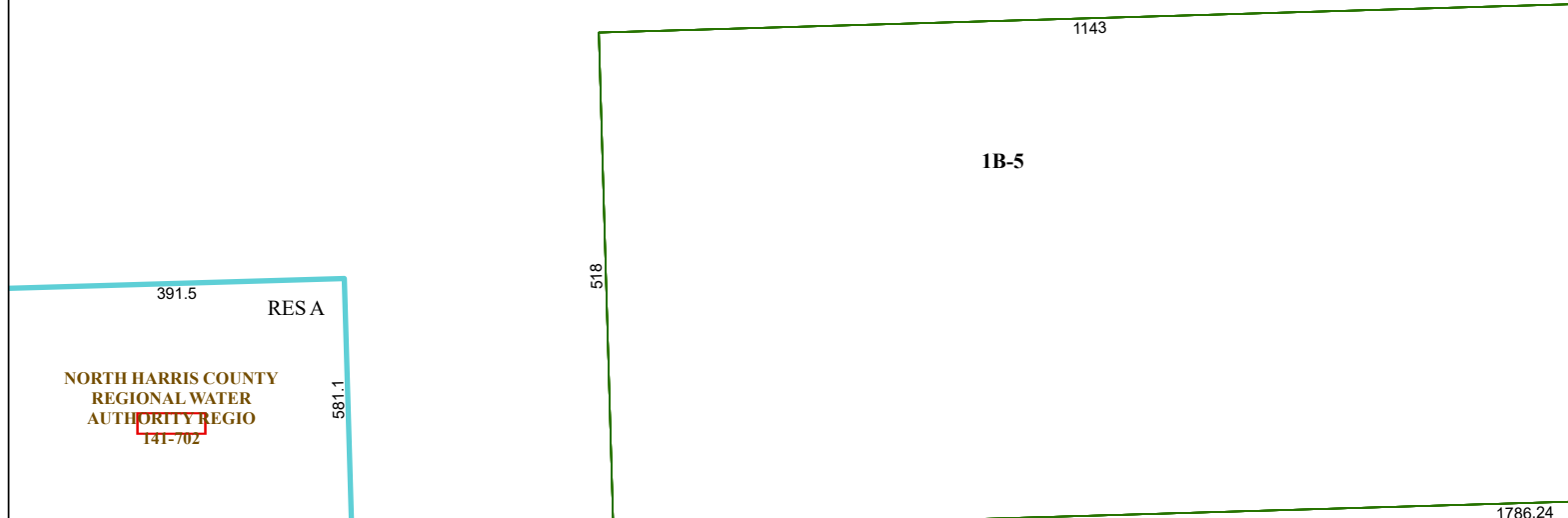

4964B3

1786.24