

# Harris Central Appraisal District



0 45 90 180 Feet

PUBLICATION DATE:  
5/11/2023

Geospatial or map data maintained by the Harris Central Appraisal District is for informational purposes and may not have been prepared for or be suitable for legal, engineering, or surveying purposes. It does not represent an on-the-ground survey and only represents the approximate location of property boundaries.

MAP LOCATION

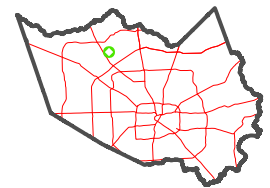

## FACET

### 4968C9

7	8	5	6	7
11	12	9	10	11
3	4	1	2	3

4968C5

4967A1

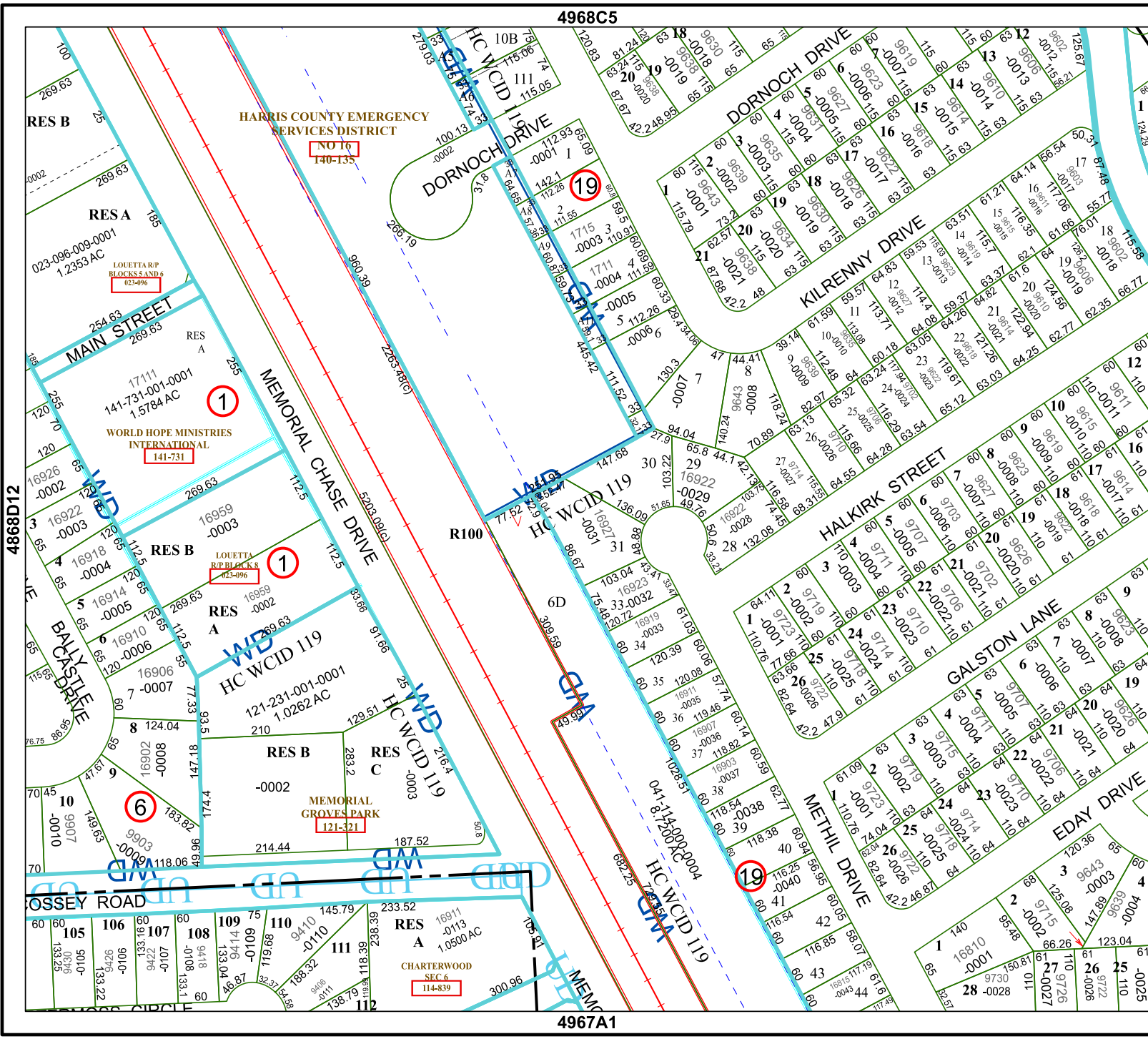

HARRIS COUNTY EMERGENCY SERVICES DISTRICT  
NO 16  
140-135

LOUETTA REPUBLICAN  
BLOCKS AND  
023-496

WORLD HOPE MINISTRIES INTERNATIONAL  
141-731

1

1

6

MEMORIAL GROVES PARK  
121-321

CHARTERWOOD SEC 6  
114-839