

# Harris Central Appraisal District



0 45 90 180 Feet

PUBLICATION DATE: 1/5/2023

Geospatial or map data maintained by the Harris Central Appraisal District is for informational purposes and may not have been prepared for or be suitable for legal, engineering, or surveying purposes. It does not represent an on-the-ground survey and only represents the approximate location of property boundaries.

MAP LOCATION

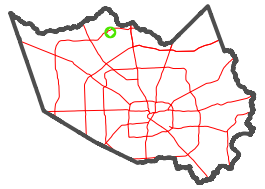

## FACET 4970B4

10	11	12	9	10
2	3	4	1	2
6	7	8	5	6

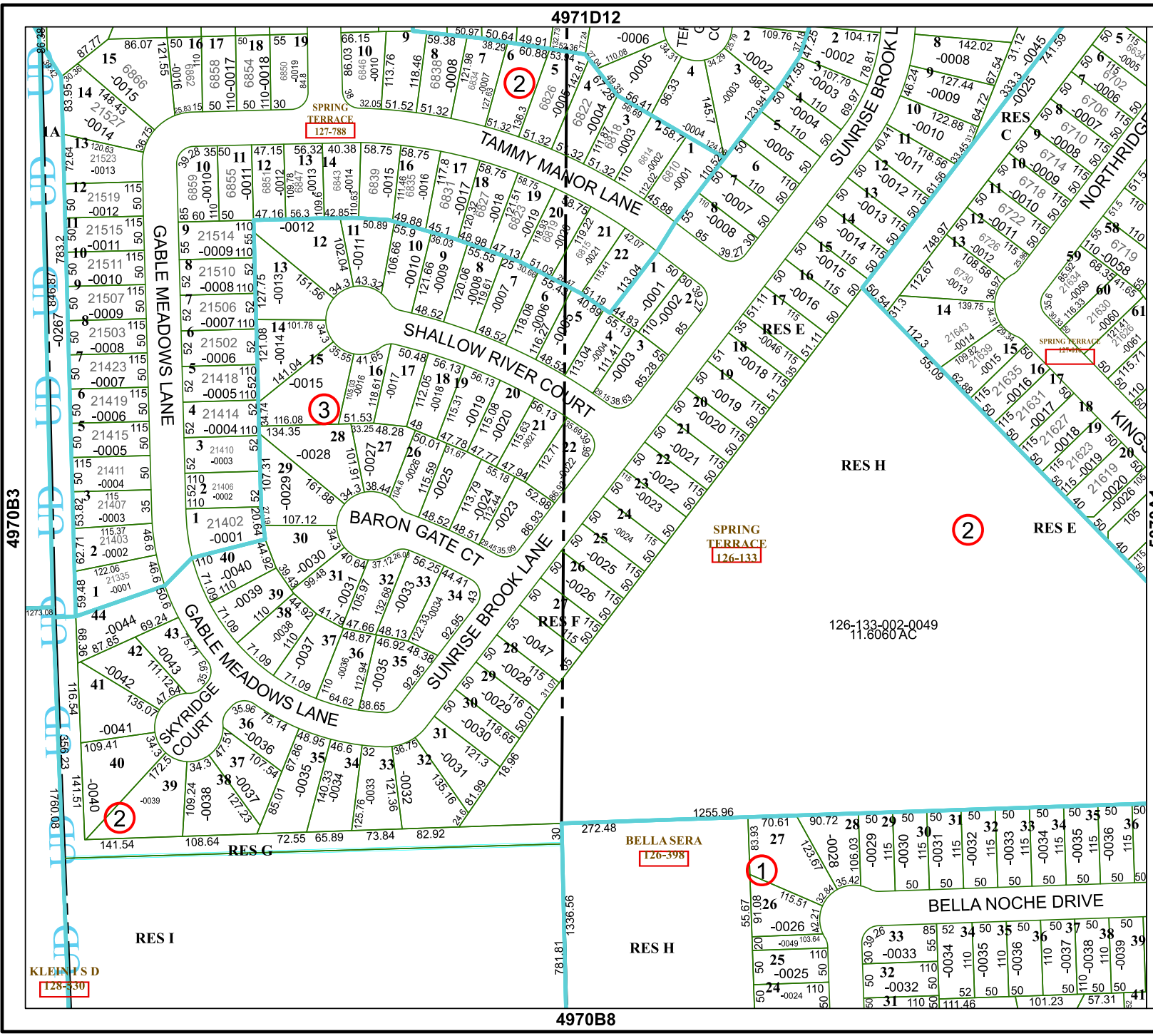

KLEIN'S D  
128-330

4970B3

4971D12

4970B8

5070A1

