

Harris Central Appraisal District



0 45 90 180 Feet

PUBLICATION DATE: 1/6/2023

Geospatial or map data maintained by the Harris Central Appraisal District is for informational purposes and may not have been prepared for or be suitable for legal, engineering, or surveying purposes. It does not represent an on-the-ground survey and only represents the approximate location of property boundaries.

MAP LOCATION

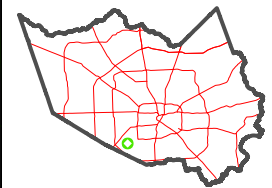

FACET 5053D3

9	10	11	12	9
1	2	3	4	1
5	6	7	8	5

5053B11

5053D7

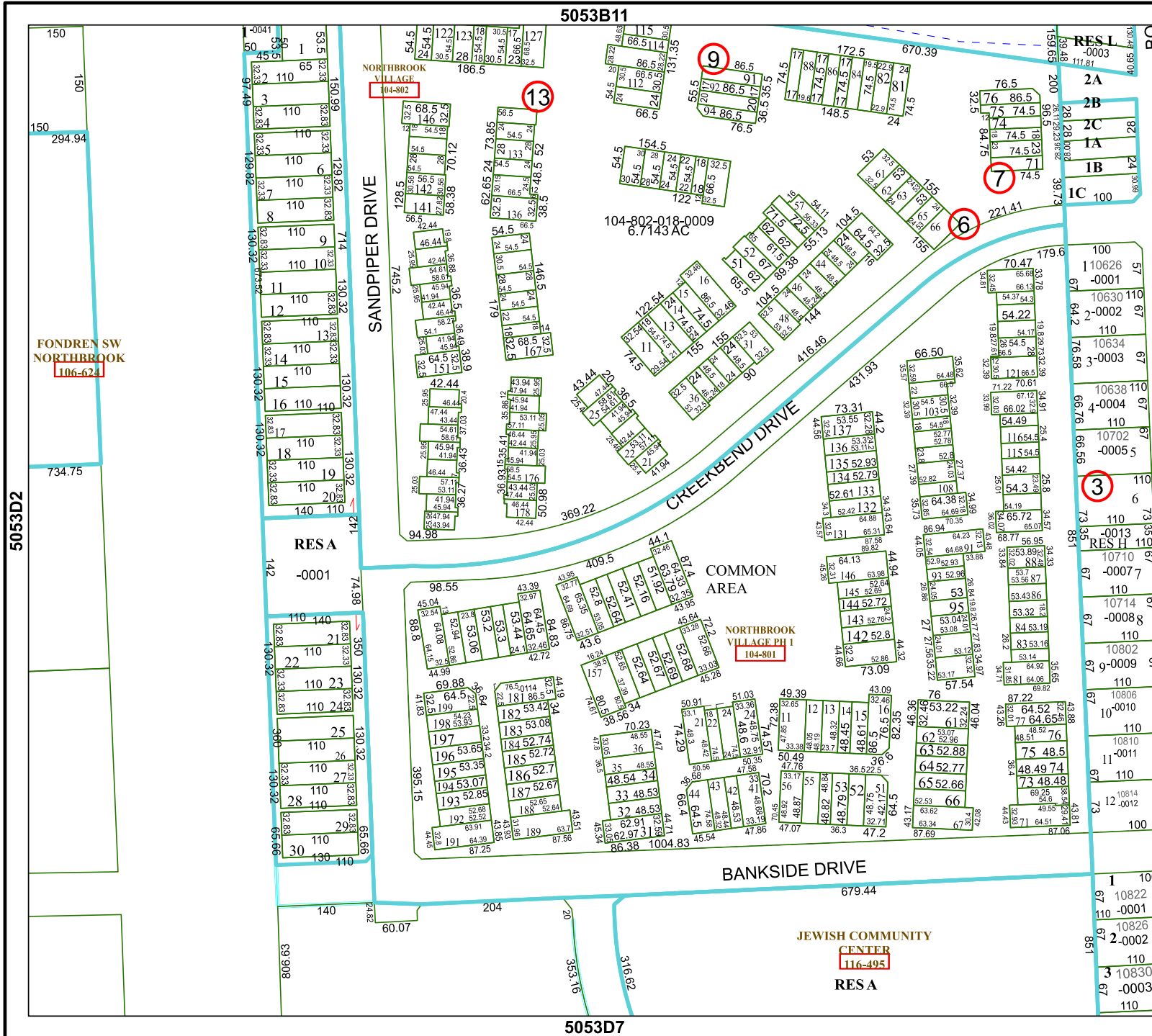

FONDREN SW NORTHROOK 106-624

5053D2

JEWISH COMMUNITY CENTER 116-495

NORTHBROOK VILLAGE 104-802

104-802-018-0009 6.7443 AC

NORTHBROOK VILLAGE PH I 104-801

RESA -0001

COMMON AREA

RESA