

5056D7

3300  
136-609-001-0001  
17.6200 AC

# Harris Central Appraisal District



0 45 90 180 Feet

PUBLICATION DATE:  
12/30/2023

Geospatial or map data maintained by the Harris Central Appraisal District is for informational purposes and may not have been prepared for or be suitable for legal, engineering, or surveying purposes. It does not represent an on-the-ground survey and only represents the approximate location of property boundaries.

MAP LOCATION

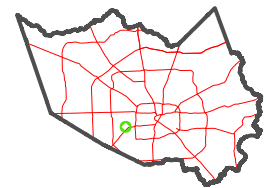

## FACET 5056D11

5	6	7	8	5
9	10	11	12	9
1	2	3	4	1

5055B3

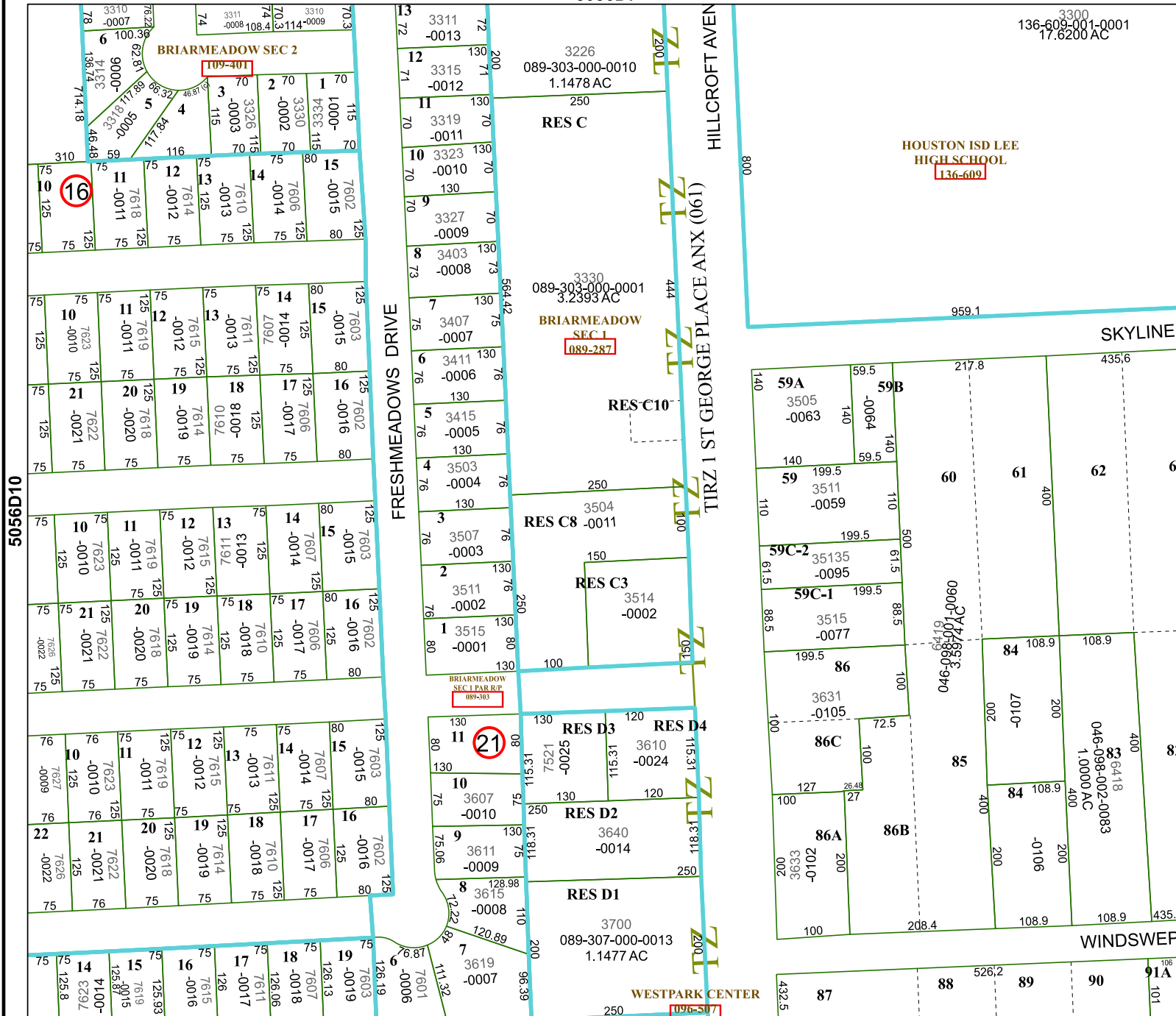

5056D10