

Harris Central Appraisal District



0 45 90 180 Feet

PUBLICATION DATE:
1/30/2023

Geospatial or map data maintained by the Harris Central Appraisal District is for informational purposes and may not have been prepared for or be suitable for legal, engineering, or surveying purposes. It does not represent an on-the-ground survey and only represents the approximate location of property boundaries.



MAP LOCATION

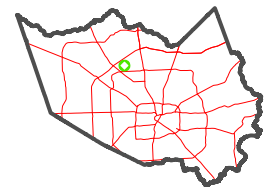

FACET 5065B2

12	9	10	11	12
4	1	2	3	4
8	5	6	7	8

5066D10

5065B6

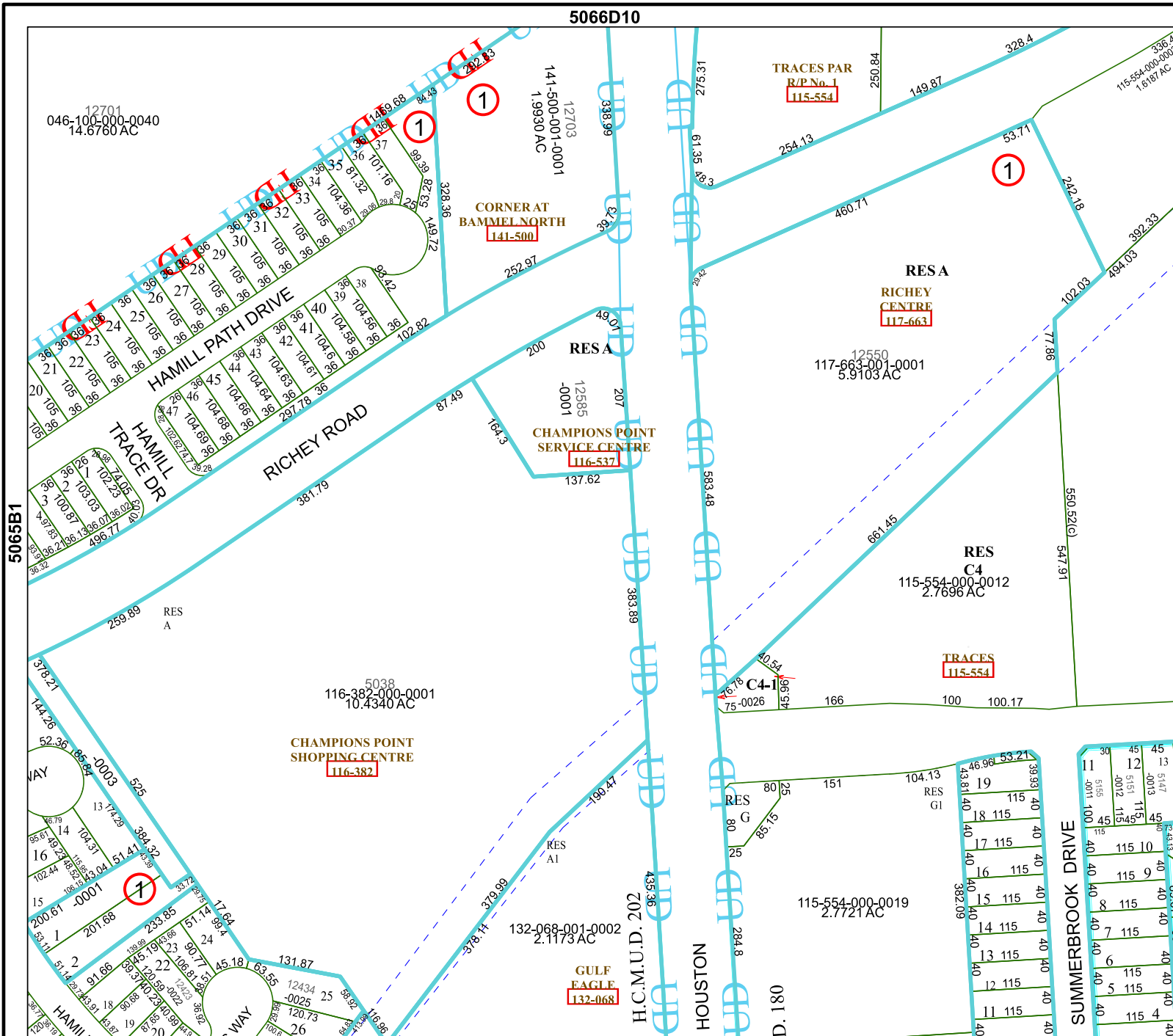

046-100-000-0040
14.6760 AC

12703
141-500-001-0001
1.9930 AC

CORNERAT
BAMMEL NORTH
141-500

TRACES PAR
R/P No. 1
115-554

RES A
RICHEY
CENTRE
117-663

RES A
CHAMPIONS POINT
SERVICE CENTRE
116-537

RES A
12550
117-663-001-0001
5.9103 AC

RES C4
115-554-000-0012
2.7696 AC

RES A
5038
116-382-000-0001
10.4340 AC

CHAMPIONS POINT
SHOPPING CENTRE
116-382

TRACES
115-554

RES G
80
115-554-000-0019
2.7721 AC

RES AI
132-068-001-0002
2.1173 AC

GULF
EAGLE
132-068

H.C.M.U.D. 202
435.36

HOUSTON

SUMMERBROOK DRIVE

5065B1

5065B3