

Harris Central Appraisal District



0 45 90 180 Feet

PUBLICATION DATE:
1/6/2023

Geospatial or map data maintained by the Harris Central Appraisal District is for informational purposes and may not have been prepared for or be suitable for legal, engineering, or surveying purposes. It does not represent an on-the-ground survey and only represents the approximate location of property boundaries.

MAP LOCATION

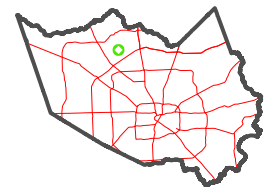

FACET 5068C1

11	12	9	10	11
3	4	1	2	3
7	8	5	6	7

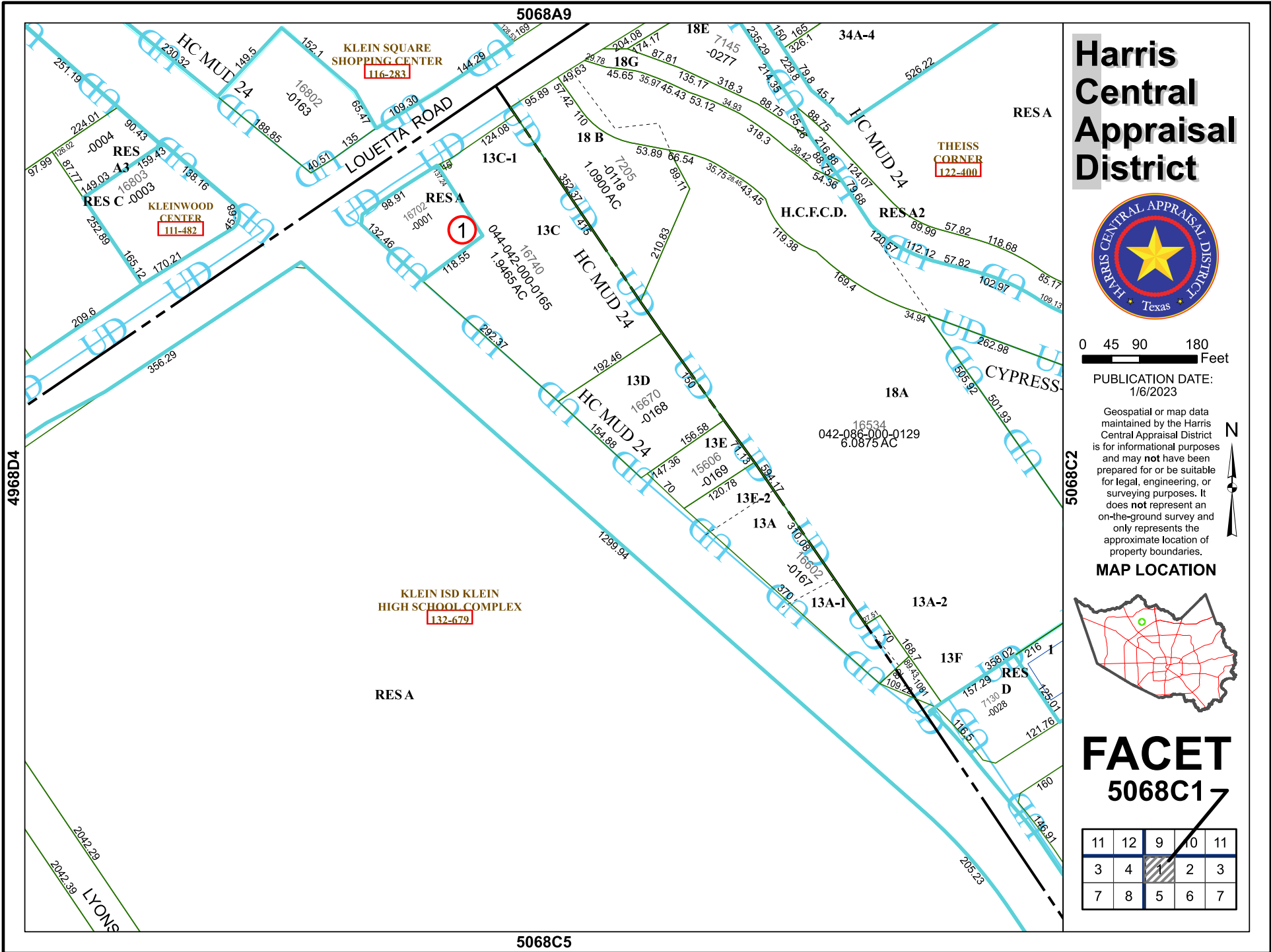

5068A9

5068C5

4968D4

5068C2

KLEIN ISD KLEIN HIGH SCHOOL COMPLEX
132-679

THEISS CORNER
122-400

1

