

Harris Central Appraisal District



0 45 90 180 Feet

PUBLICATION DATE:
3/25/2024

Geospatial or map data maintained by the Harris Central Appraisal District is for informational purposes and may not have been prepared for or be suitable for legal, engineering, or surveying purposes. It does not represent an on-the-ground survey and only represents the approximate location of property boundaries.



MAP LOCATION

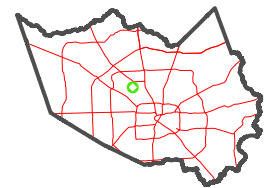

FACET 5162D1

11	12	9	10	11
3	4	1	2	3
7	8	5	6	7

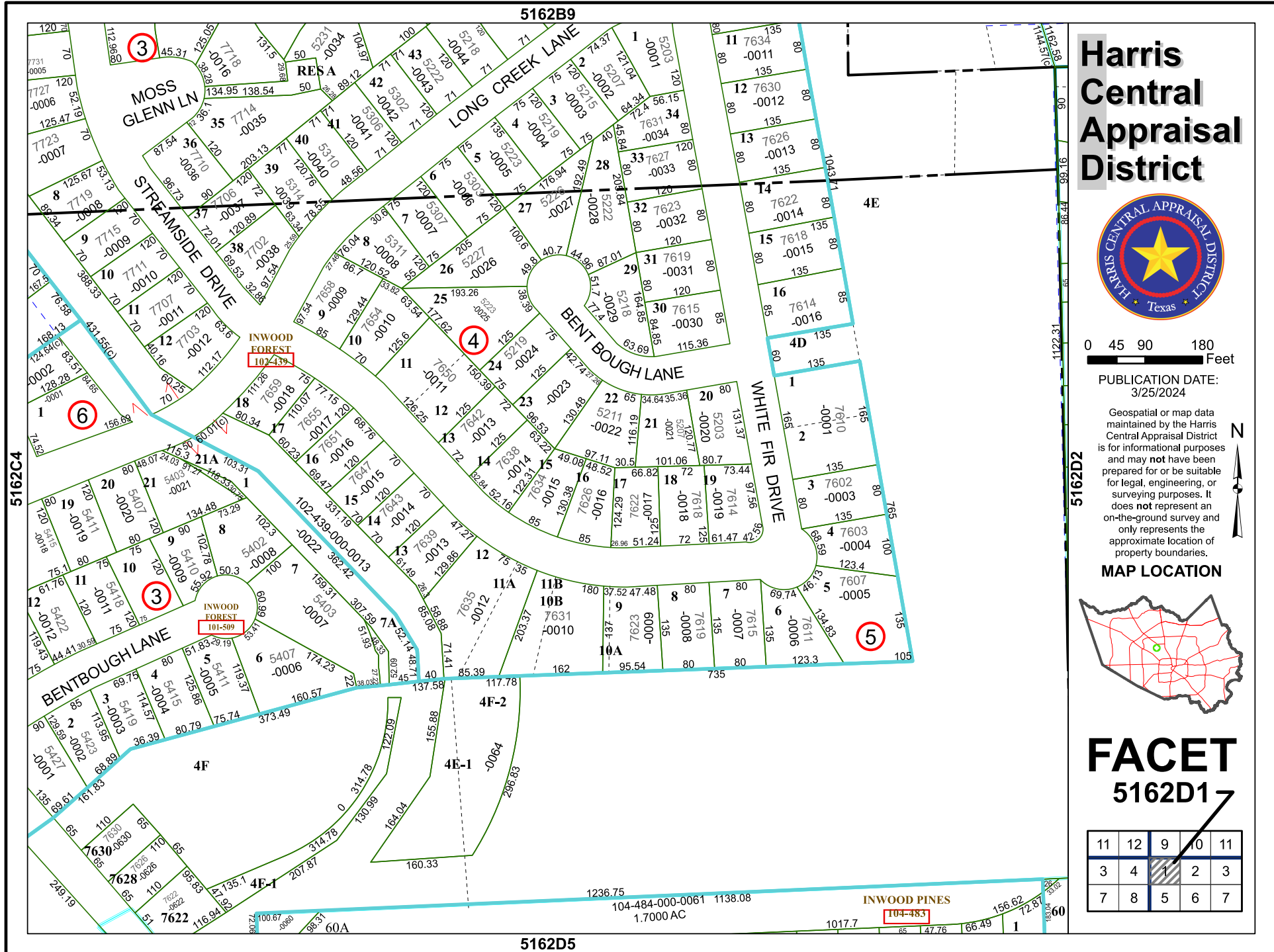

5162B9

5162D5

5162C4

5162D2

1162.58
1144.31C
80
99.16
86.44
1122.31

1236.75
104-484-000-0061 1138.08
1.7000 AC
1017.7 65 147.76 166.49 1

156.62
172.81
60