

Harris Central Appraisal District



0 45 90 180 Feet

PUBLICATION DATE: 1/6/2023

Geospatial or map data maintained by the Harris Central Appraisal District is for informational purposes and may not have been prepared for or be suitable for legal, engineering, or surveying purposes. It does not represent an on-the-ground survey and only represents the approximate location of property boundaries.

MAP LOCATION

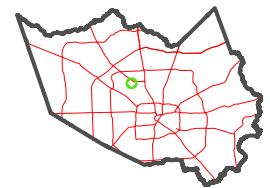

FACET 5163C12

6	7	8	5	6
10	11	12	9	10
2	3	4	1	2

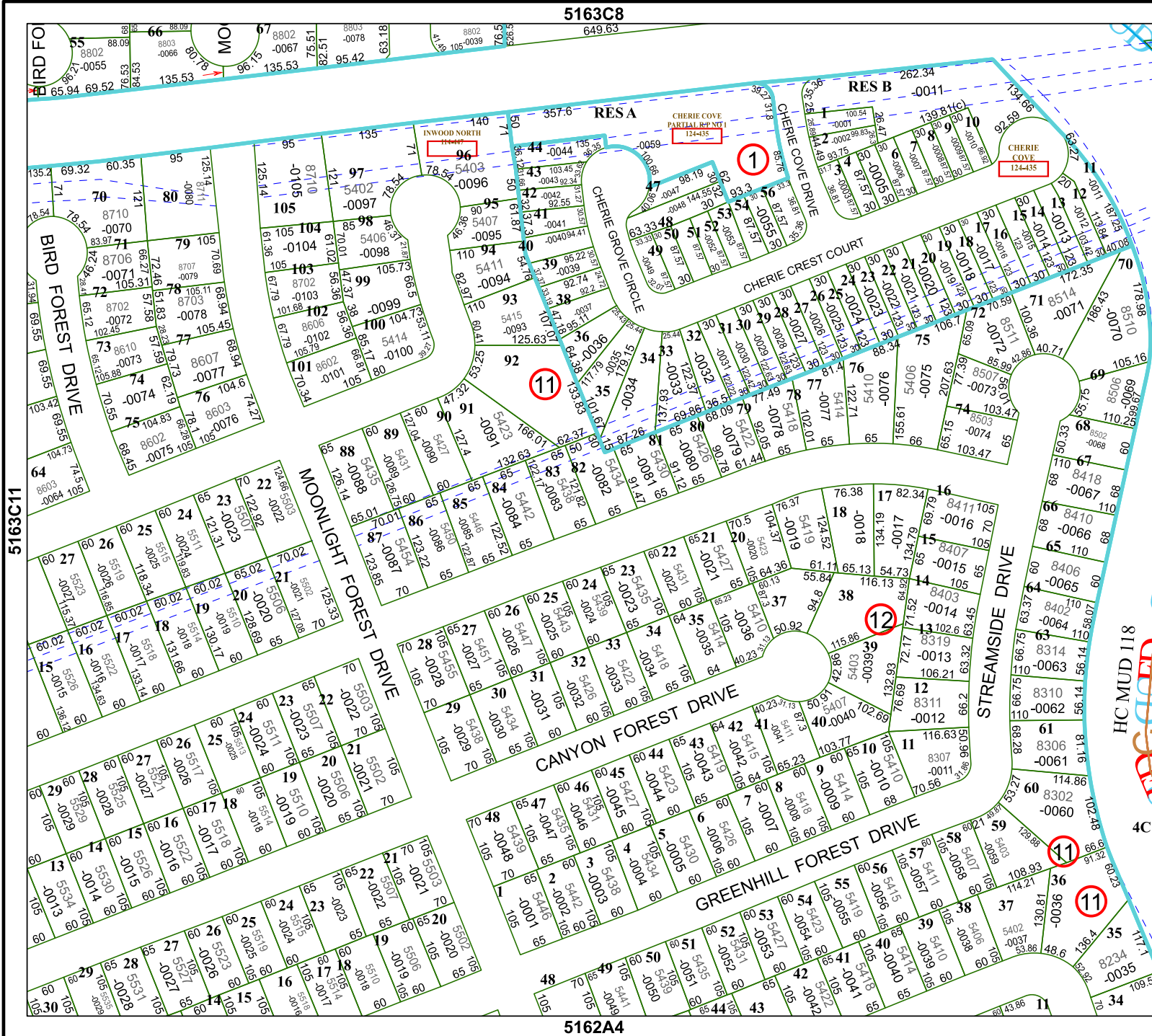

5163C11

BIRD FO

5163C8

5162A4

5163D9

HC MUD 118