

Harris Central Appraisal District



0 45 90 180 Feet

PUBLICATION DATE:
12/30/2023

Geospatial or map data maintained by the Harris Central Appraisal District is for informational purposes and may not have been prepared for or be suitable for legal, engineering, or surveying purposes. It does not represent an on-the-ground survey and only represents the approximate location of property boundaries.



MAP LOCATION

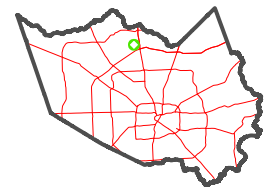

FACET 5169D6

4	1	2	3	4
8	5	6	7	8
12	9	10	11	12

5169D2

5169D10

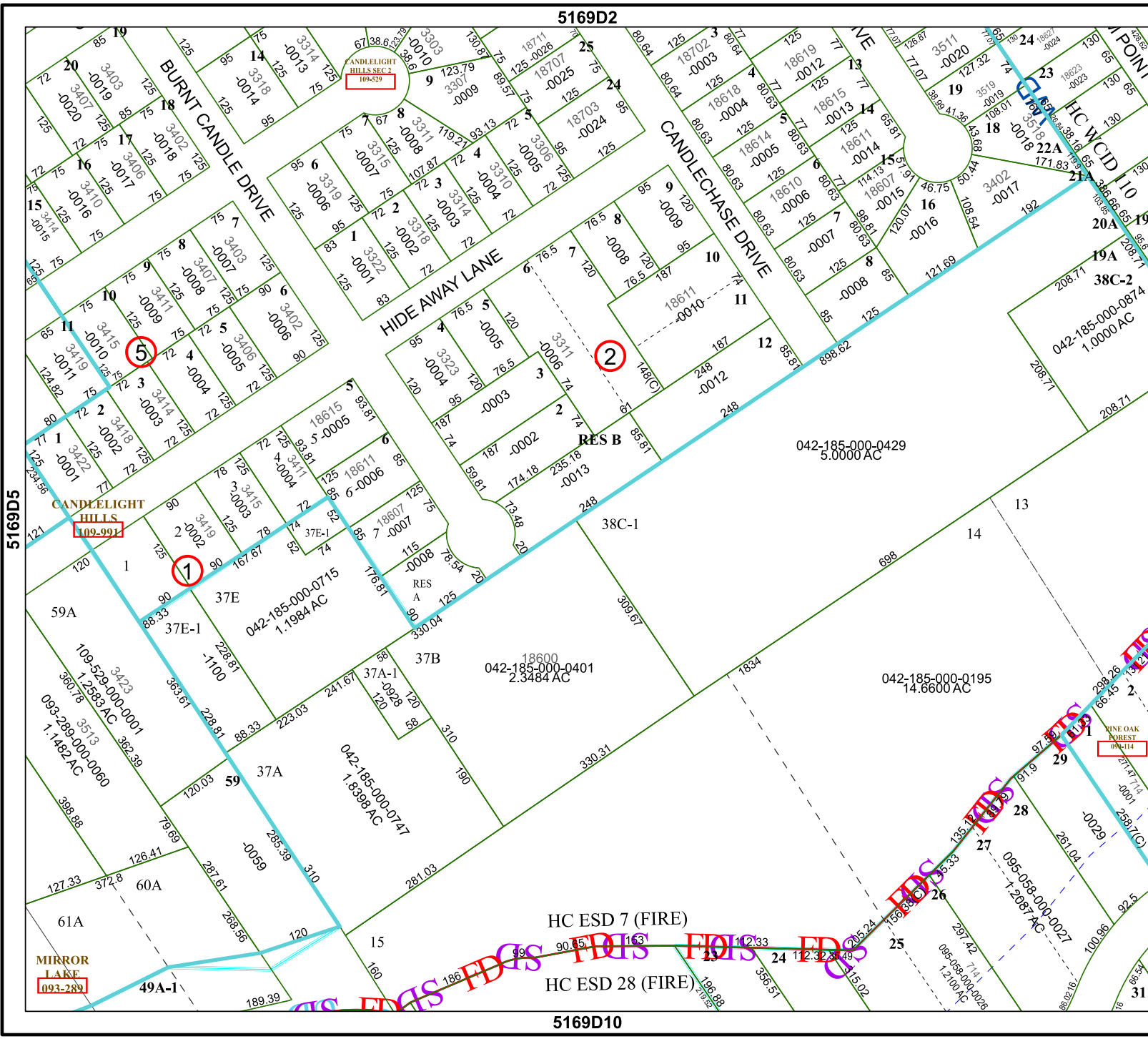

5169D5

5169D7

5169D11
5169D12
5169D13
5169D14
5169D15
5169D16
5169D17
5169D18
5169D19
5169D20
5169D21
5169D22
5169D23
5169D24
5169D25
5169D26
5169D27
5169D28
5169D29
5169D30
5169D31
5169D32
5169D33
5169D34
5169D35
5169D36
5169D37
5169D38
5169D39
5169D40
5169D41
5169D42
5169D43
5169D44
5169D45
5169D46
5169D47
5169D48
5169D49
5169D50
5169D51
5169D52
5169D53
5169D54
5169D55
5169D56
5169D57
5169D58
5169D59
5169D60
5169D61
5169D62
5169D63
5169D64
5169D65
5169D66
5169D67
5169D68
5169D69
5169D70
5169D71
5169D72
5169D73
5169D74
5169D75
5169D76
5169D77
5169D78
5169D79
5169D80
5169D81
5169D82
5169D83
5169D84
5169D85
5169D86
5169D87
5169D88
5169D89
5169D90
5169D91
5169D92
5169D93
5169D94
5169D95
5169D96
5169D97
5169D98
5169D99
5169D100