

# Harris Central Appraisal District



0 45 90 180 Feet

PUBLICATION DATE: 1/6/2023

Geospatial or map data maintained by the Harris Central Appraisal District is for informational purposes and may not have been prepared for or be suitable for legal, engineering, or surveying purposes. It does not represent an on-the-ground survey and only represents the approximate location of property boundaries.

MAP LOCATION

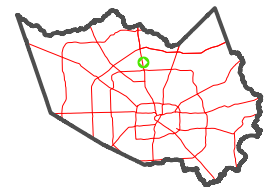

## FACET 5266D2

12	9	10	11	12
4	1	2	3	4
8	5	6	7	8

5266B10

5266D6

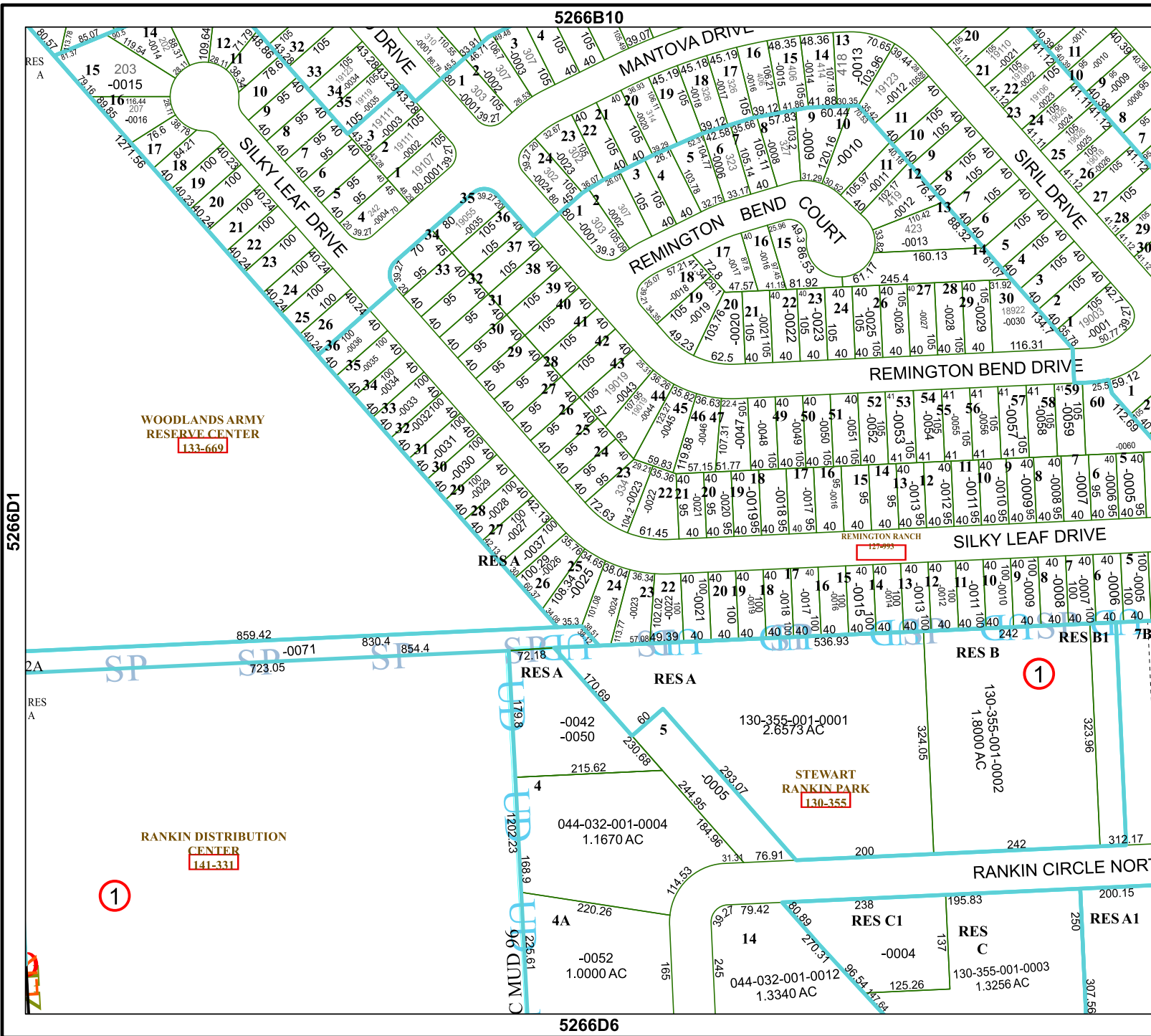

WOODLANDS ARMY RESERVE CENTER  
133-669

RANKIN DISTRIBUTION CENTER  
141-331

STEWART RANKIN PARK  
130-355

1

1

