

Harris Central Appraisal District



0 45 90 180 Feet

PUBLICATION DATE: 3/13/2023

Geospatial or map data maintained by the Harris Central Appraisal District is for informational purposes and may not have been prepared for or be suitable for legal, engineering, or surveying purposes. It does not represent an on-the-ground survey and only represents the approximate location of property boundaries.

MAP LOCATION

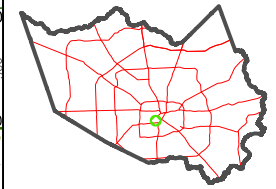

FACET 5356B5

3	4	1	2	3
7	8	5	6	7
11	12	9	10	11

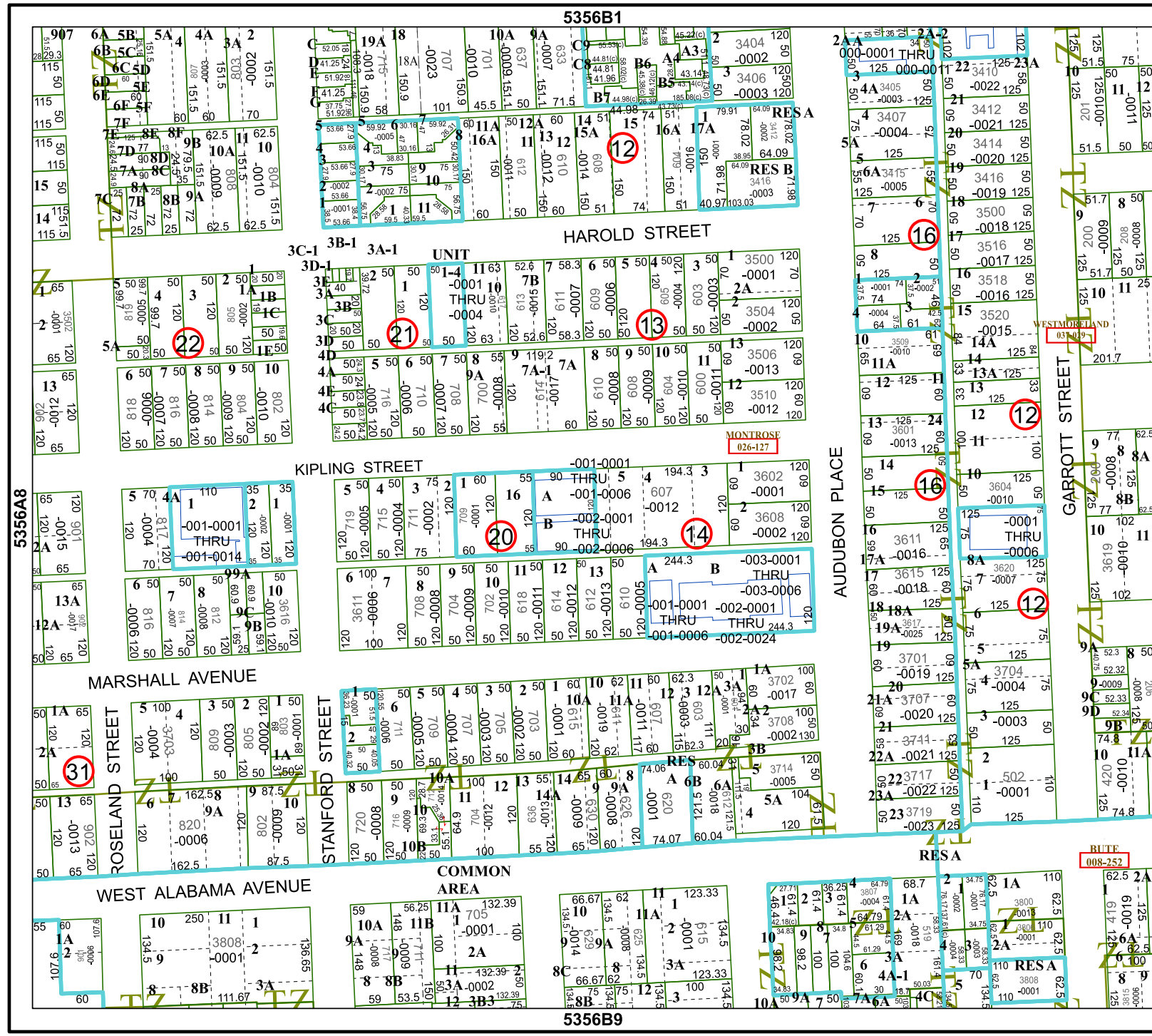

5356A8

5356B6

5356B1

5356B9

MONROSE 026-127

BLUFF 008-252