

# Harris Central Appraisal District



0 45 90 180 Feet

PUBLICATION DATE: 1/6/2023

Geospatial or map data maintained by the Harris Central Appraisal District is for informational purposes and may not have been prepared for or be suitable for legal, engineering, or surveying purposes. It does not represent an on-the-ground survey and only represents the approximate location of property boundaries.

MAP LOCATION

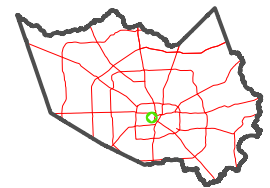

## FACET 5357B9

|    |    |   |    |    |
|----|----|---|----|----|
| 7  | 8  | 5 | 6  | 7  |
| 11 | 12 | 9 | 10 | 11 |
| 3  | 4  | 1 | 2  | 3  |

5357B5

5357D1

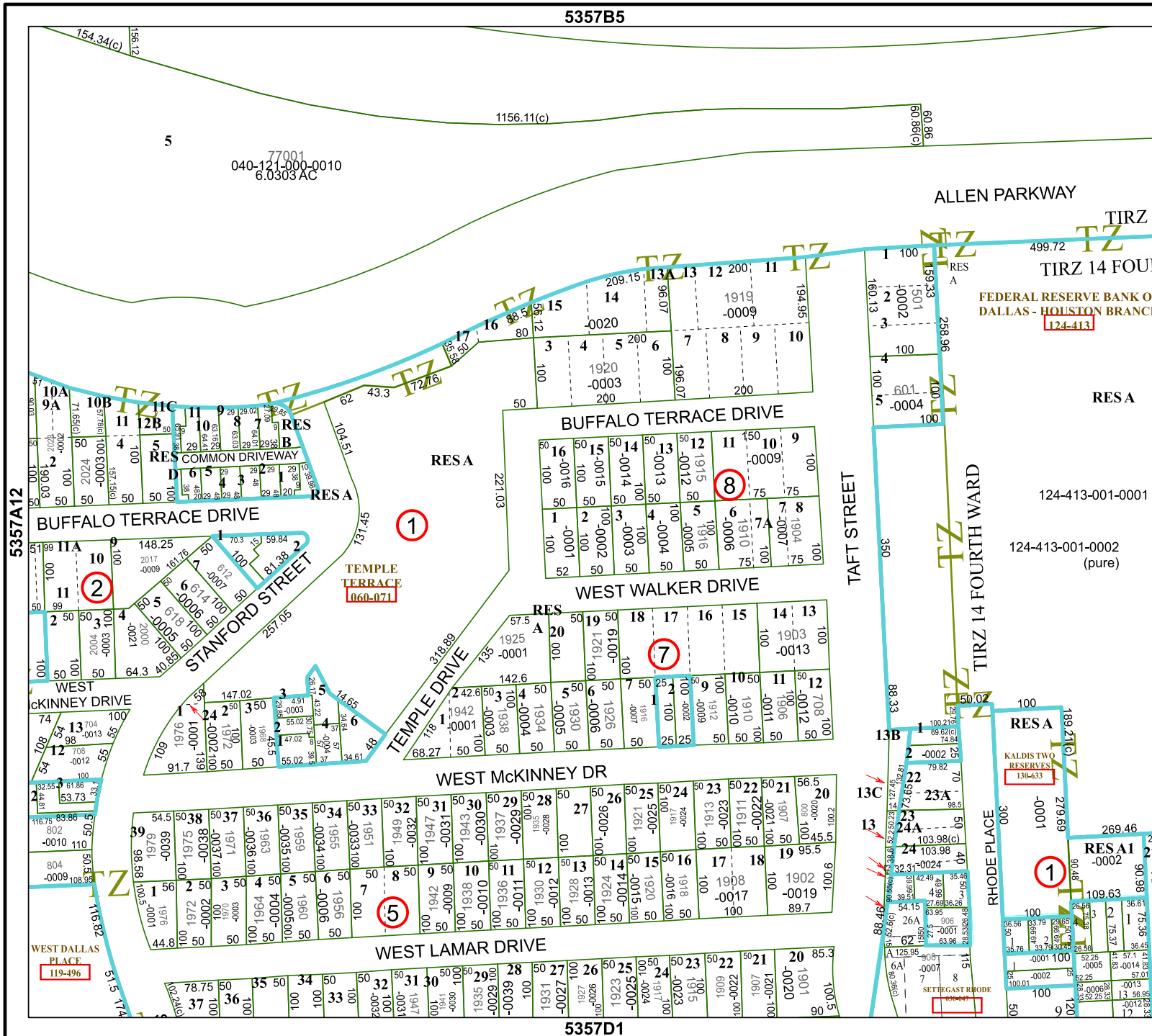

ALLEN PARKWAY

FEDERAL RESERVE BANK OF DALLAS - HOUSTON BRANCH  
124-413

RESA

124-413-001-0001

124-413-001-0002 (pure)

RESA

KALDIS TWC RESERVES  
1304-633

RESA1

SETTEGAST RHODE  
0988-097

