

Harris Central Appraisal District



0 45 90 180 Feet

PUBLICATION DATE:
5/22/2023

Geospatial or map data maintained by the Harris Central Appraisal District is for informational purposes and may not have been prepared for or be suitable for legal, engineering, or surveying purposes. It does not represent an on-the-ground survey and only represents the approximate location of property boundaries.

MAP LOCATION

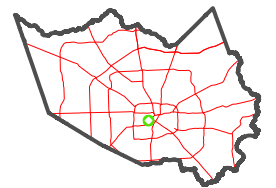

FACET 5357C12

6	7	8	5	6
10	11	12	9	10
2	3	4	1	2

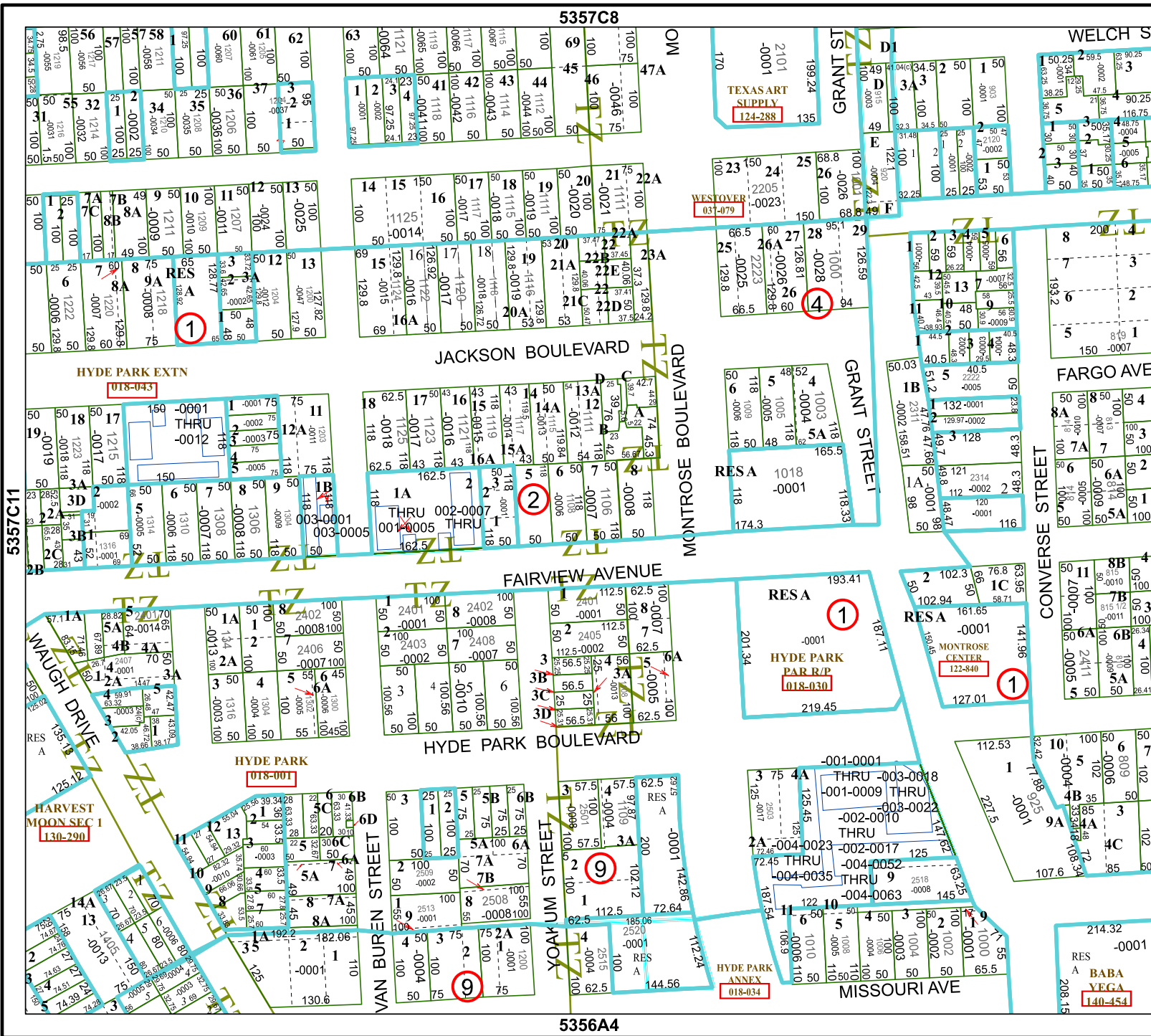

TEXAS ART SUPPLY
124-288

WESTOVER
037-079

HYDE PARK EXTN
018-043

RES A
012-008

THRU 002-0007
001-0005 THRU 1

RESA
-0001
HYDE PARK PAR R/P
018-030
219.45

RESA
-0001
MONTRORSE CENTER
122-840
127.01

HYDE PARK
018-001

HARVEST MOON SEC 1
130-290

HYDE PARK ANEX
018-034

RES A
BABA YEGA
140-454
208.15