

Harris Central Appraisal District



0 45 90 180 Feet

PUBLICATION DATE:
12/30/2023

Geospatial or map data maintained by the Harris Central Appraisal District is for informational purposes and may not have been prepared for or be suitable for legal, engineering, or surveying purposes. It does not represent an on-the-ground survey and only represents the approximate location of property boundaries.

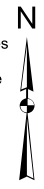

MAP LOCATION

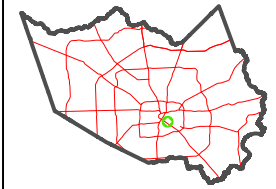

FACET

5456B11

5	6	7	8	5
9	10	11	12	9
1	2	3	4	1

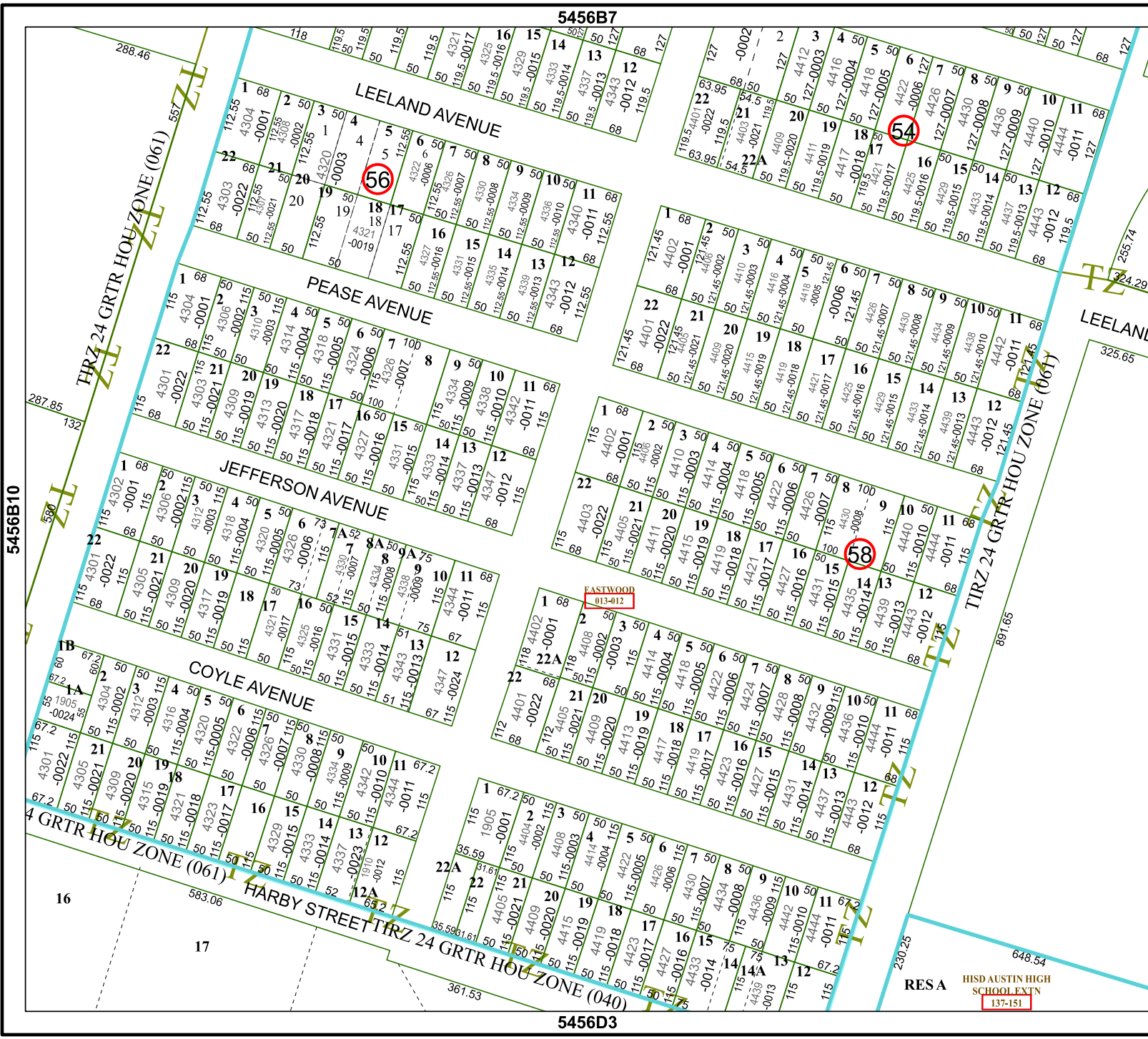

5456B10

5456B12

5456B7

5456D3

RESA HISD AUSTIN HIGH SCHOOL EXTN 137-151