

# Harris Central Appraisal District



0 45 90 180 Feet

PUBLICATION DATE: 1/9/2023

Geospatial or map data maintained by the Harris Central Appraisal District is for informational purposes and may not have been prepared for or be suitable for legal, engineering, or surveying purposes. It does not represent an on-the-ground survey and only represents the approximate location of property boundaries.



MAP LOCATION

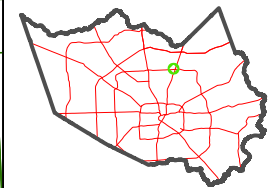

## FACET 5565C4

10	11	12	9	10
2	3	4	1	2
6	7	8	5	6

5565A12

5565C8

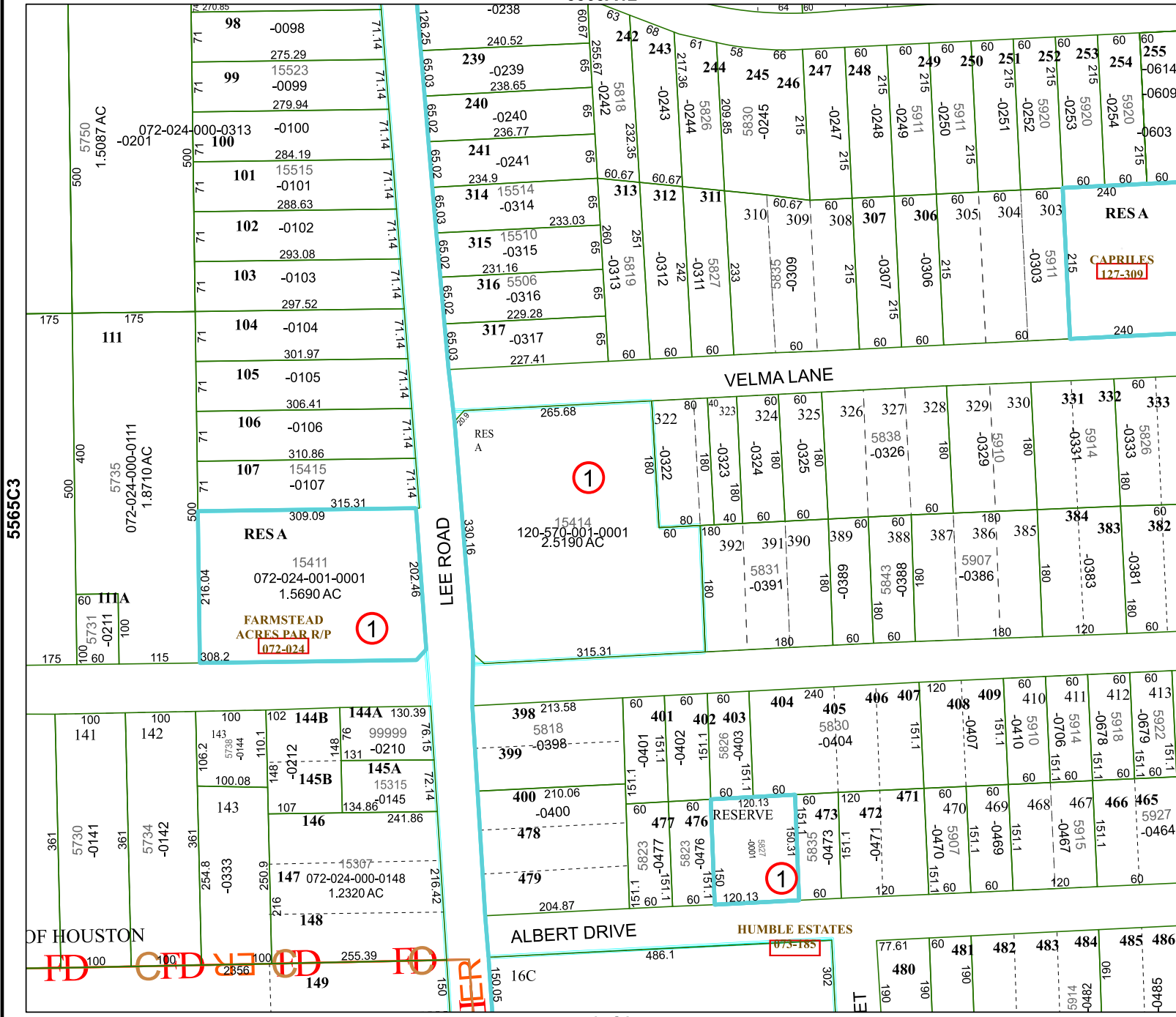

5565C3

5565D1

OF HOUSTON  
FD 100 CTD 100 FD 100 FD 255.39 FD 150