

Harris Central Appraisal District



0 45 90 180 Feet

PUBLICATION DATE:
5/6/2024

Geospatial or map data maintained by the Harris Central Appraisal District is for informational purposes and may not have been prepared for or be suitable for legal, engineering, or surveying purposes. It does not represent an on-the-ground survey and only represents the approximate location of property boundaries.

MAP LOCATION

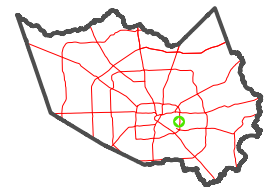

FACET 5656A4

10	11	12	9	10
2	3	4	1	2
6	7	8	5	6

5657C12

BORDON STREET

WALLACE STREET

GRTR E END MGMT DIST

5656A8

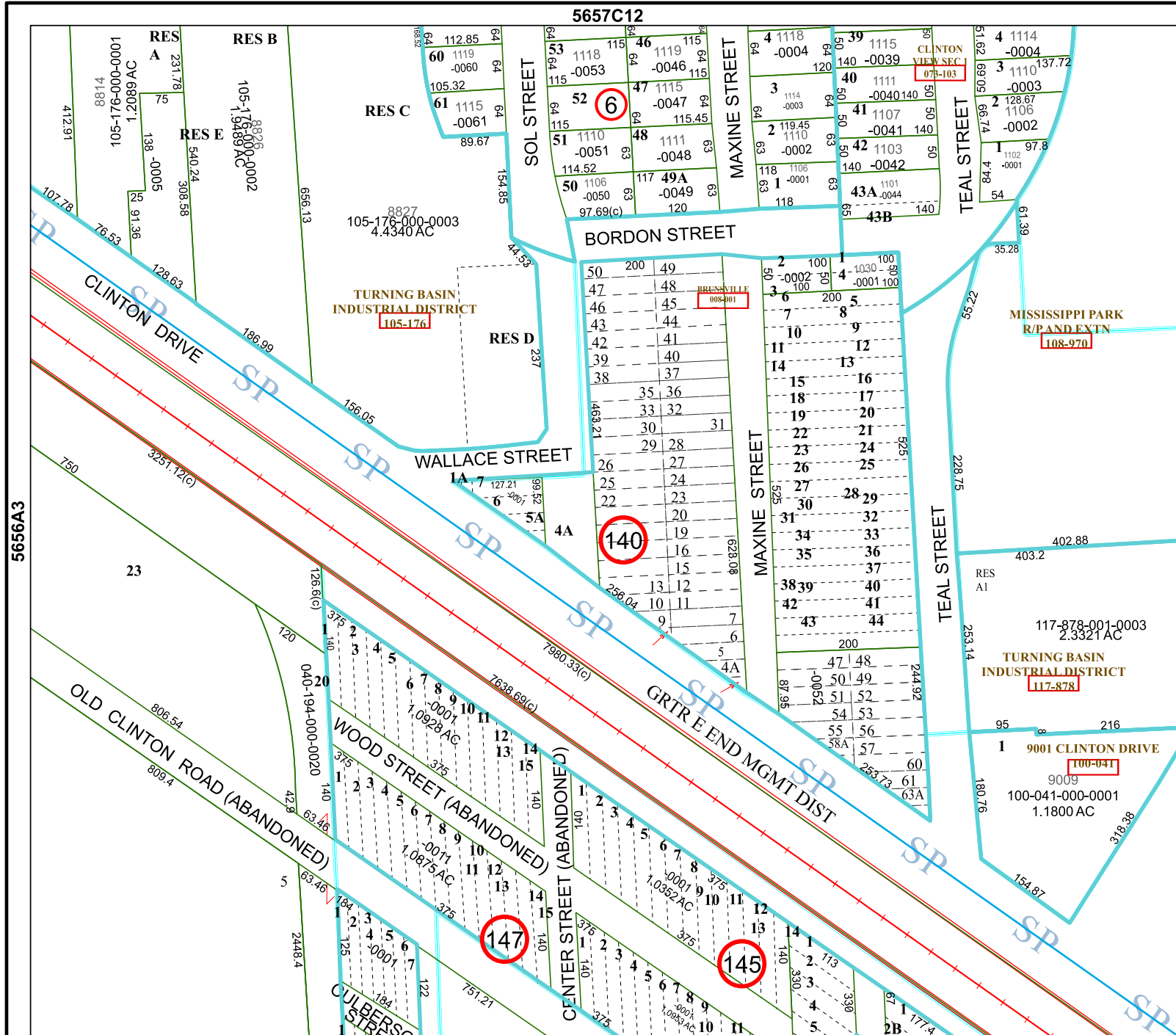

5656A3

5656B1

